

STATE OF WISCONSIN
DEPARTMENT OF NATURAL RESOURCES

LAKE SURVEY MAP

WOLF LAKE
POLK COUNTY
SEC. 12,13 T. 36 N. R. 19 W.

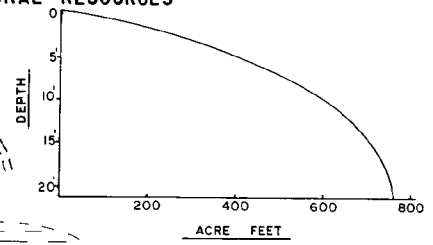
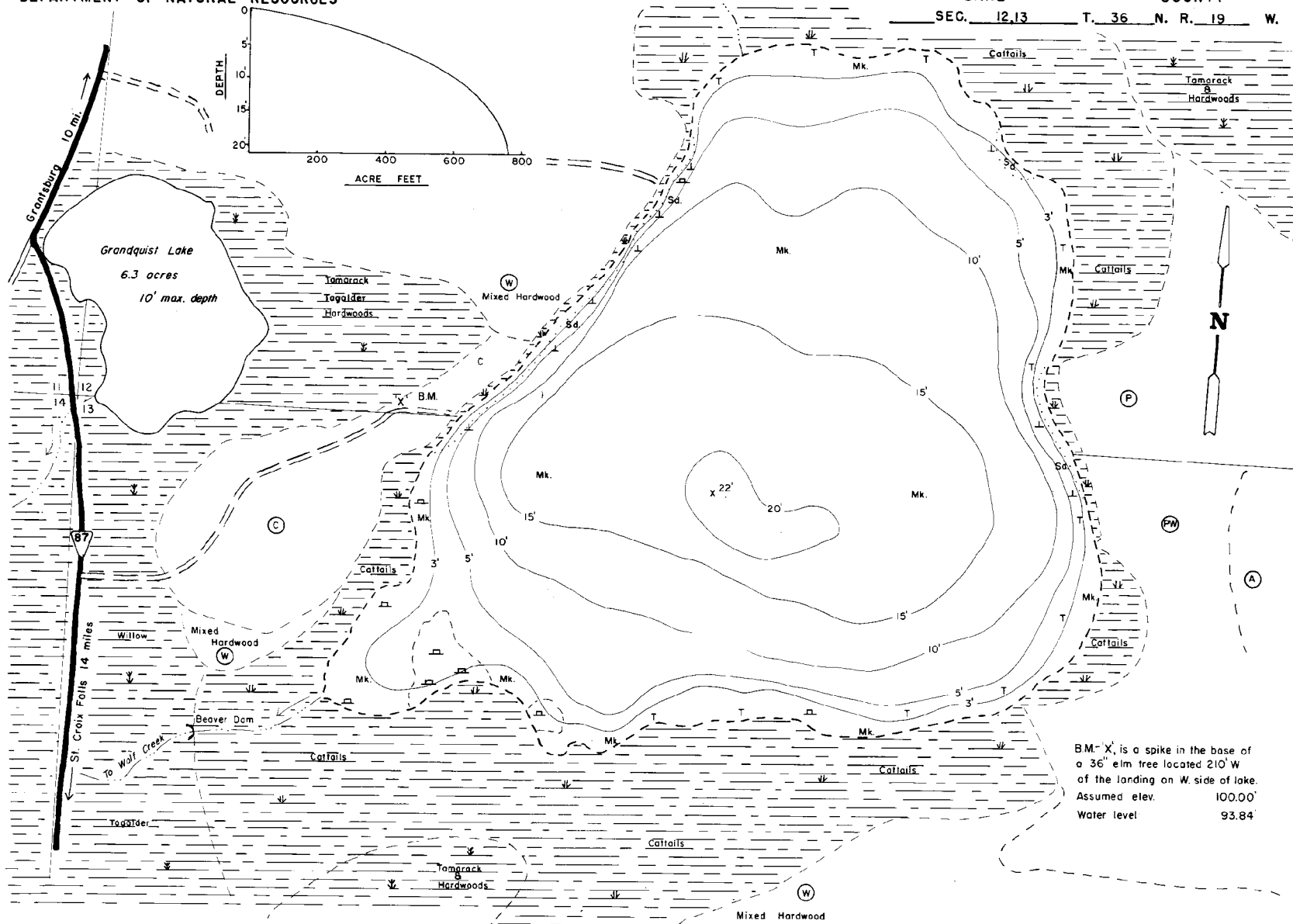

BM 'X' is a spike in the base of a 36' elm tree located 210' W of the landing on W. side of lake. Assumed elev. 100.00' Water level 93.84'

EQUIPMENT RECORDING SONAR MAPPED SEPT 1969 MONTH YEAR

- | TOPOGRAPHIC SYMBOLS | | LAKE BOTTOM SYMBOLS | |
|-----------------------|-------------------------------|---------------------|-----------------------------|
| (B) Brush | Steep slope | P. Peat | B Boulders |
| (PW) Partially wooded | ----- Indefinite shoreline | Mk. Muck | ⚡ Stumps & Snags |
| (W) Wooded | ----- Marsh | C. Clay | ⚠ Rock danger to navigation |
| (C) Cleared | ----- Spring | M. Marl | T Submergent vegetation |
| (P) Pastured | ----- Intermittent stream | Sd. Sand | ↑ Emergent vegetation |
| (A) Agricultural | ----- Permanent inlet | St. Silt | ⚡ Floating vegetation |
| B.M. Bench Mark | ----- Permanent outlet | Gr. Gravel | ⚡ Brush shelters |
| ■ Dwelling | ----- Dam | R. Rubble | |
| ■ Resort | ----- D.N.R. State owned land | Bc. Bedrock | |
| ■ Camp | | | |



Access Access with Parking Boat Livery
 Drawn by: T. Ginder
 Field work by: C. Busch, G. Lund, S. Johannes

SPECIES OF FISH	Abundance	
	Number	Percent
Muskie		
N. Pike	X	
Walleye		
L.M. Bass	X	
S.M. Bass		
Panfish	X	
Trout		

WATER AREA 71.5 ACRES
 UNDER 3 FT. 11.0 %
 OVER 20 FT. 3.0 %
 MAX. DEPTH 22 FEET.
 TOTAL ALK. 140 P.P.M.
 VOLUME 759.02 ACRE FT.
 SHORELINE 1.39 MILES