

STATE OF WISCONSIN
DEPARTMENT OF NATURAL RESOURCES

LAKE SURVEY MAP

WILKERSON LAKE
SEC. 7, 18 T. 39 - N. R. 13 - W.
WASHBURN COUNTY

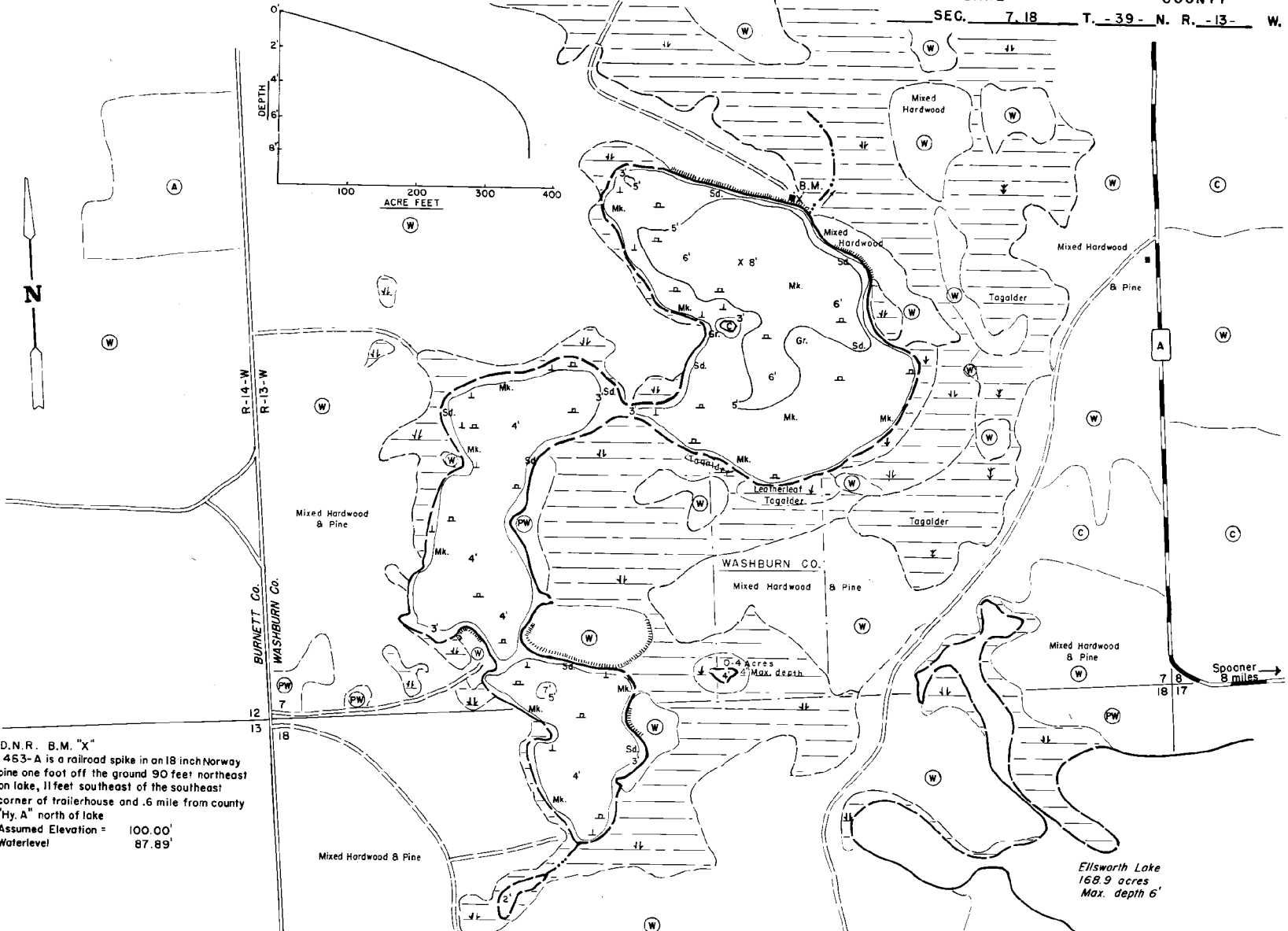

D.N.R. B.M. "X"
1463-A is a railroad spike in an 18 inch Norway pine one foot off the ground 90 feet northeast on lake, 11 feet southeast of the southeast corner of trailerhouse and .6 mile from county "Hy. A" north of lake
Assumed Elevation = 100.00'
Waterlevel 87.89'

Ellsworth Lake
168.9 acres
Max. depth 6'

EQUIPMENT MAPPED JUNE 1969
SOUNDING POLE MONTH YEAR
LAKE BOTTOM SYMBOLS

- | | | | |
|-----------------------|-------------------------------|------------|---------------------------|
| TOPOGRAPHIC SYMBOLS | | P. Peat | B Boulders |
| (B) Brush | () Steep slope | Mk. Muck | Stumps & Snags |
| (PW) Partially wooded | (---) Indefinite shoreline | C. Clay | Rock danger to navigation |
| (W) Wooded | (---) Marsh | M. Marl | T Submergent vegetation |
| (C) Cleared | (---) Spring | Sd. Sand | ↓ Emergent vegetation |
| (P) Pastured | (---) Intermittent stream | St. Silt | ↑ Floating vegetation |
| (A) Agricultural | (---) Permanent inlet | Gr. Gravel | ↕ Brush shelters |
| B.M. Bench Mark | (---) Permanent outlet | R. Rubble | |
| (D) Dwelling | (---) Dam | Bc Bedrock | |
| (R) Resort | (---) D.N.R. State owned land | | |
| (C) Camp | | | |



Access Access with Parking Boat Livery
Drawn by: W. Sniders
Field work by: C. Bush, C. Belfer, S. Johannes

SPECIES OF FISH	ANNUAL WINTERKILL	
	Abundant	Present
Muskie		
N. Pike		
Walleye		
L. N. Bass		
S. M. Bass		
Panfish		
Trout		

WATER AREA 85.6 ACRES
UNDER 3 FT. 13 %
OVER 20 FT. 0 %
MAX. DEPTH 8 FEET.
TOTAL ALK. 19 P.P.M.
VOLUME 358.4 ACRE FT.
SHORELINE 2.86 MILES