

STATE OF WISCONSIN  
DEPARTMENT OF NATURAL RESOURCES

LAKE SURVEY MAP

WILKE LAKE MANITOWOC COUNTY  
SEC. 2,3 T. 17 N. R. 21 E.



B.M.'X' is an established U.S. Government B.M. located on E. side of public boat landing on retaining wall on S. end of lake.  
Assumed Elev. 100.00  
Water Elev. 99.30'

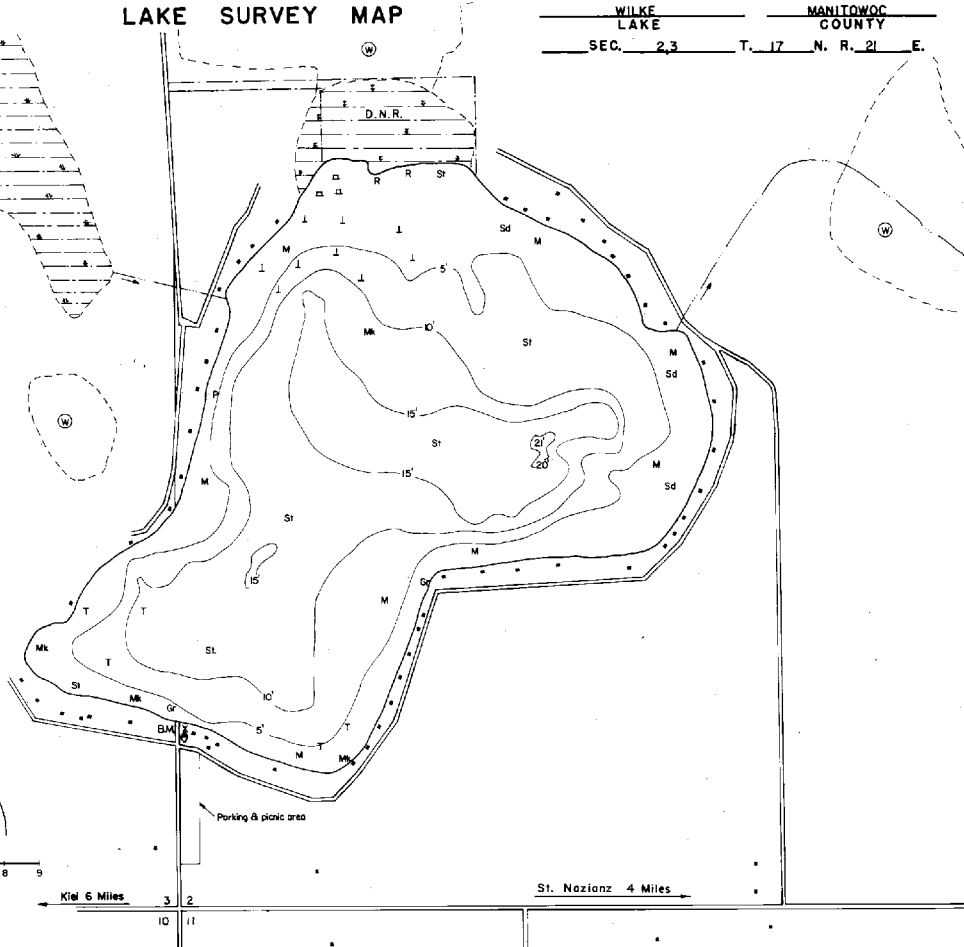
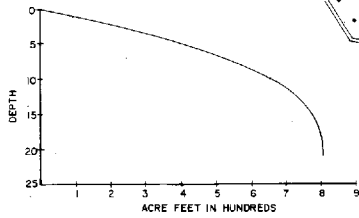

- |                                  |               |                         |             |
|----------------------------------|---------------|-------------------------|-------------|
| <b>EQUIPMENT RECORDING SONAR</b> | <b>MAPPED</b> | <b>JUNE</b>             | <b>1972</b> |
| <b>TOPOGRAPHIC SYMBOLS</b>       |               | <b>MONTH</b>            | <b>YEAR</b> |
| (B) Brush                        |               | Steep slope             | P. Peat     |
| (PW) Partially wooded            | - - - -       | Indefinite shoreline    | Mk. Muck    |
| (W) Wooded                       |               | Marsh                   | C. Clay     |
| (C) Cleared                      | —             | Spring                  | M. Marl     |
| (P) Pastured                     | —             | Intermittent stream     | Sd. Sand    |
| (A) Agricultural                 | —             | Permanent inlet         | St. Silt    |
| B.M. Bench Mark                  | —             | Permanent outlet        | G. Gravel   |
| (D) Dwelling                     | —             | Dam                     | R. Rubble   |
| (R) Resort                       | —             | D.N.R. State owned land | B. Bedrock  |
| (C) Camp                         | —             |                         |             |

- LAKE BOTTOM SYMBOLS**
- B Boulders
  - Stumps & Snags
  - Rock danger to navigation
  - Submergent vegetation
  - Emergent vegetation
  - Floating vegetation
  - Brush shelters



SPECIES OF FISH	Algonquin	Green Bay	Preble
Bullhead	X		
N. Pike	X		
Wolffish	X		
L.M. Bass	X		
S.M. Bass	X		
Panfish	X		
Trot			

WATER AREA 94.8 ACRES  
 UNDER 3 FT. 19 %  
 OVER 20 FT. 19 %  
 MAX. DEPTH 21 FEET.  
 TOTAL ALK. 206 P.P.M.  
 VOLUME 809.7 ACRE FT.  
 SHORELINE 1.67 MILES

Maps are not for navigation  
 Source-Wisconsin Department of Natural Resources  
 Hunt Fish Camp Wisconsin .Com 2005