

WISCONSIN CONSERVATION DEPARTMENT

LAKE SURVEY MAP

LAKE WHITEWATER (SHEET '2')

SECTION 34-35-2-3

TOWNSHIP T-3-4-N

RANGE R-15-E

TOWN WHITEWATER

COUNTY WALWORTH

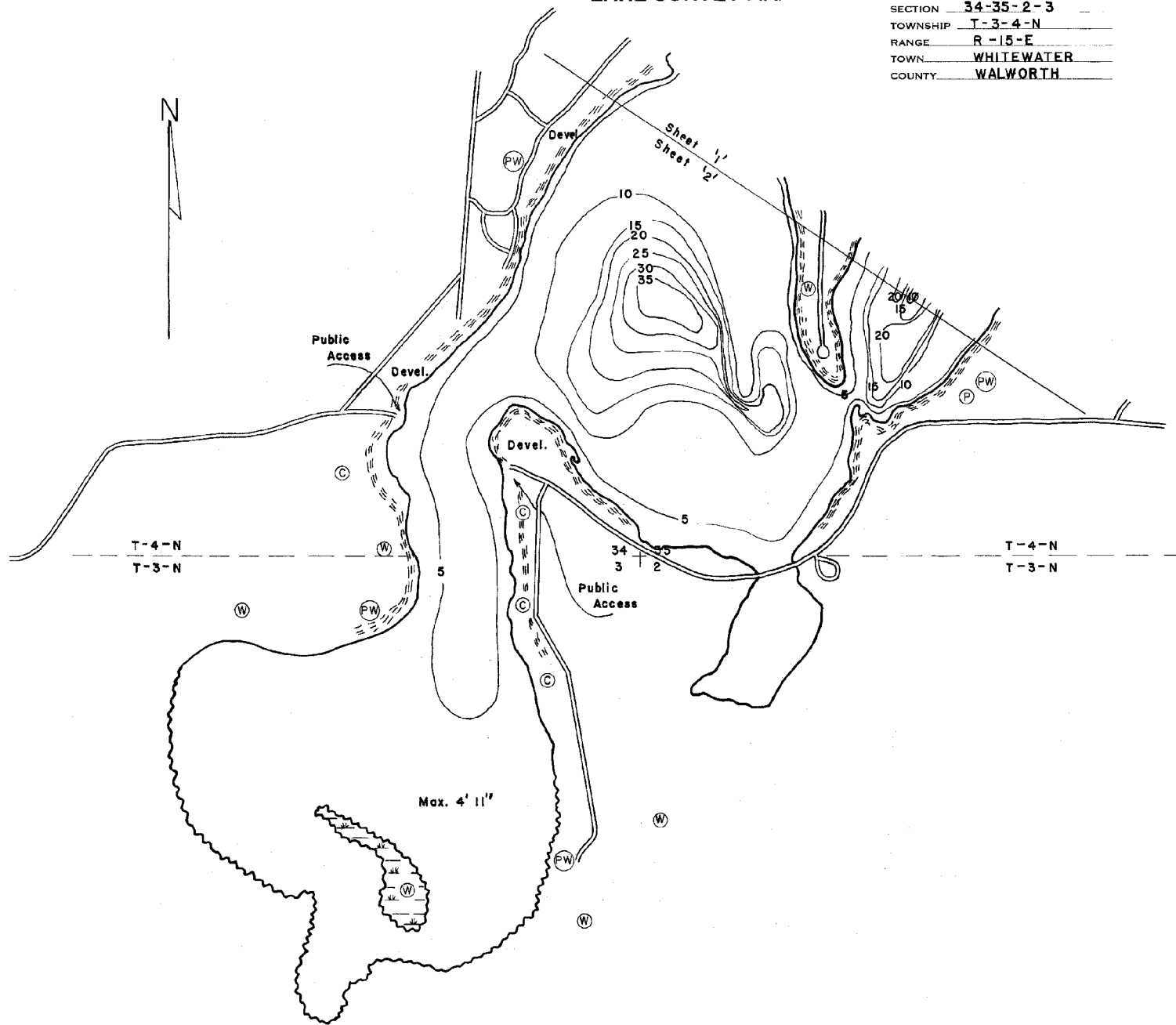

DATE 11-17-54

SOURCE OF INFORMATION W.C.D.

SOUNDINGS Echo Sounder

AREA 298.9 A

TOTAL SHORELINE 4.7 Mi.

MAX. DEPTH 38 Feet

SCALE: 1" = 500'