

LAKE SURVEY MAP

LAKE WHITESIDE FORM FI-117
 SECTION 8-17
 TOWNSHIP 44 N
 RANGE 10 W
 TOWN OF GORDON
 COUNTY DOUGLAS

WISCONSIN CONSERVATION DEPARTMENT
 BIOLOGY DIVISION
 LAKE AND STREAM IMPROVEMENT SECTION

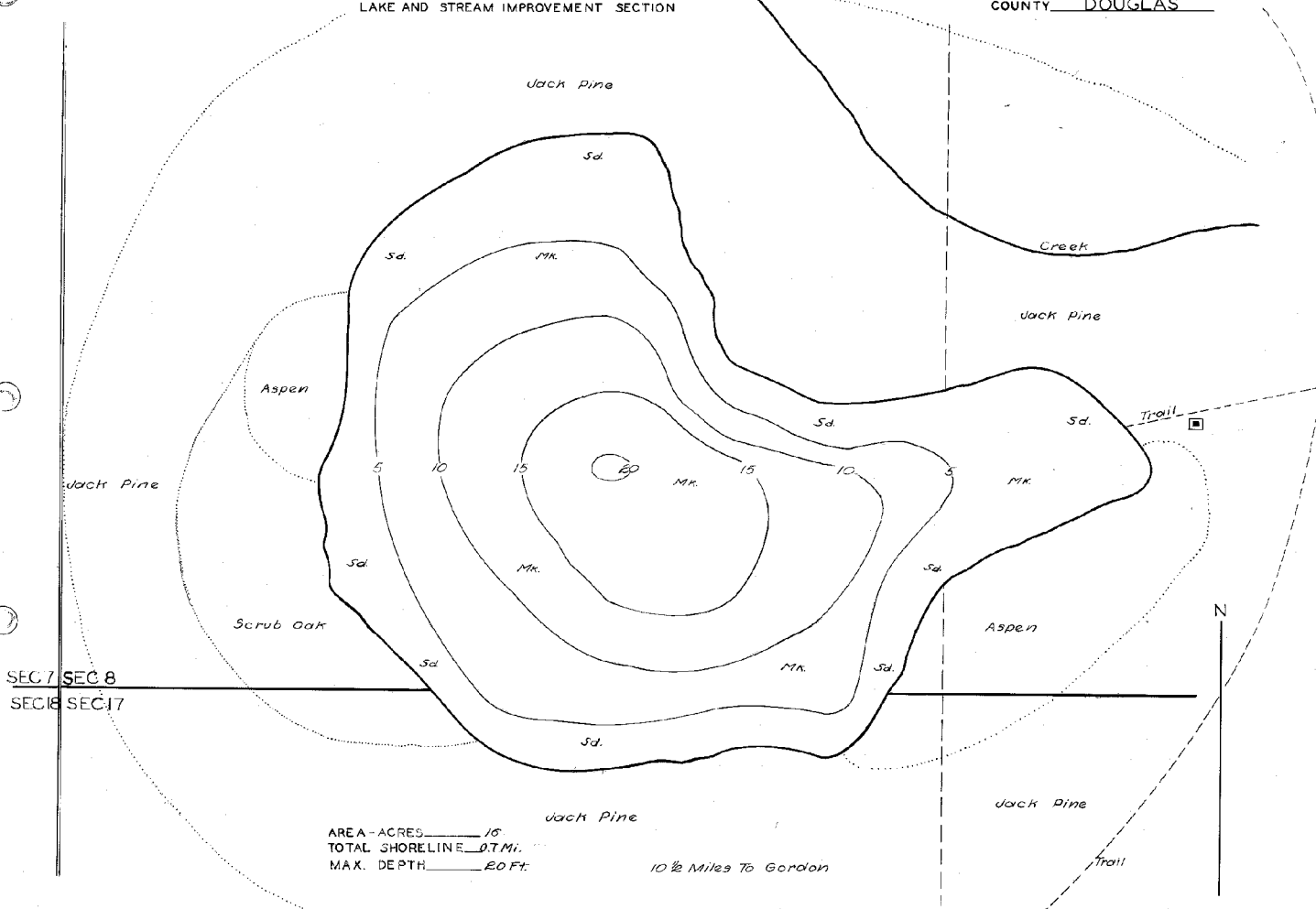

SEC 7 SEC 8
 SEC 16 SEC 17

AREA - ACRES 16
 TOTAL SHORELINE 0.7 Mi.
 MAX. DEPTH 20 Ft.

10 1/2 Miles To Gordon

SCALE 1 inch Equals 110 Ft.

*Checked
 W.P.S.
 D.A.B.
 7/1/91*

DATE Jan 21 1991
 COMPILED BY WPS WPA
 TRACED BY _____
 SOURCE OF INFORMATION WPA Lake Survey Project
 SOUNDINGS At 165' intervals
 DATES OF MAP REVISION _____
 WORK AGENCY WPA

LAKE IMPROVEMENT RECORD	
TYPE	DATE
BRUSH REFUGES	_____
SAPLING TANGLES	_____
SPAWNING BOXES	_____
* MINNOW SPAWNING	_____
TOTAL	_____

- LEGEND
- WEED BEDS
 - ROCKY SHOALS
 - SAND
 - CLAY
 - GRAVEL
 - MUCK
 - DWELLING
 - ABANDONED DWELLING
 - RESORT