

STATE OF WISCONSIN
DEPARTMENT OF NATURAL RESOURCES

LAKE SURVEY MAP

VIRGIN LAKE ONEIDA COUNTY
SEC. 10, 11, 14, 15 T. 38 N. R. 11 E.

Deer Lake
176.9 Acres
20' Deep

Whitefish Lake
187 Acres
30' Deep

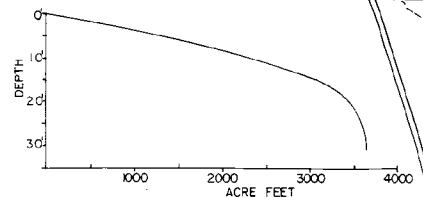
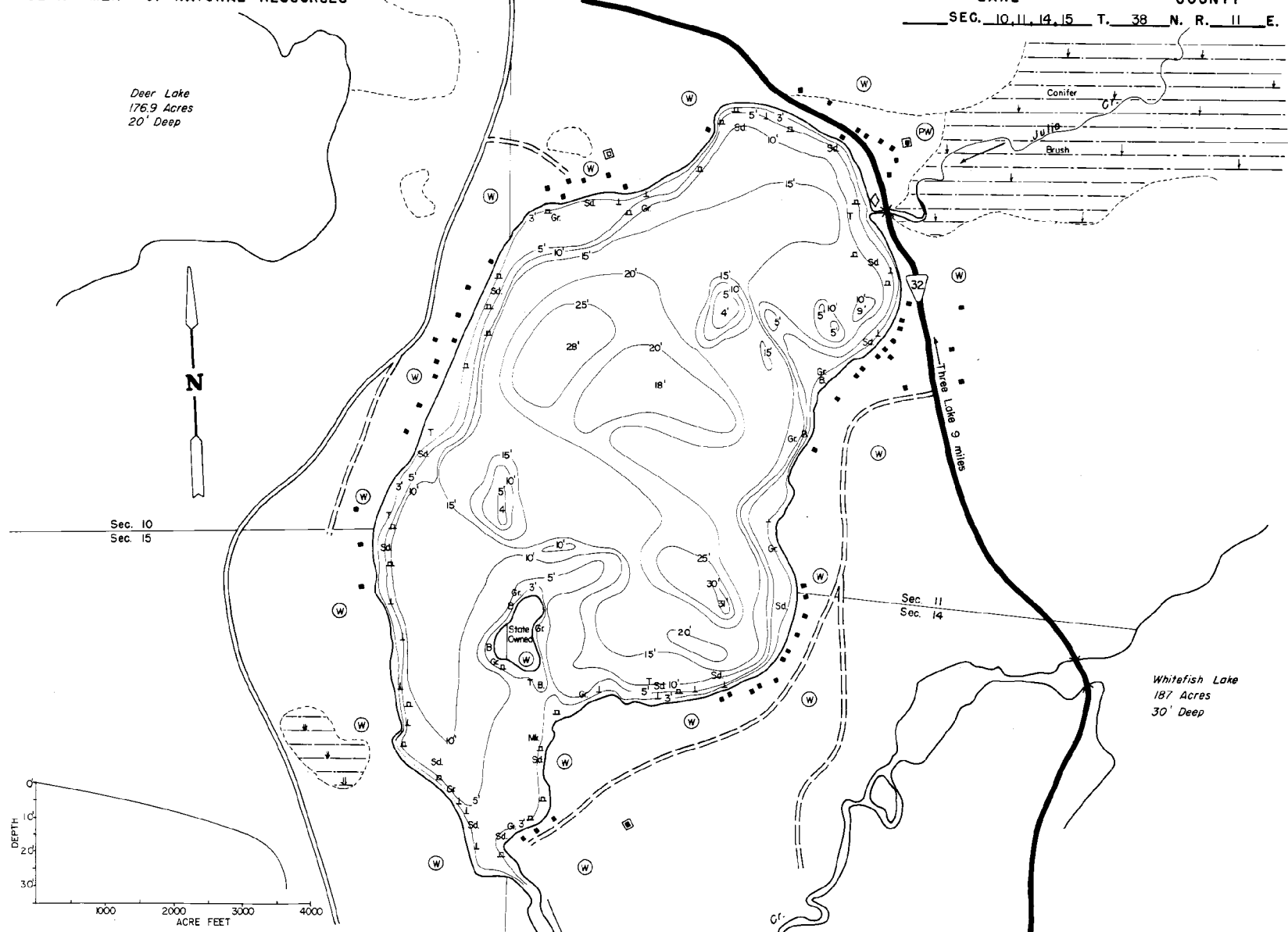

EQUIPMENT RECORDING SONAR MAPPED JULY 1969
MONTH YEAR
LAKE BOTTOM SYMBOLS

- | | | | |
|-----------------------|----------------------------|--------------|-----------------------------|
| (B) Brush | () Steep slope | P. Peat | B Boulders |
| (PW) Partially wooded | (---) Indefinite shoreline | Mx. Muck | ☼ Stumps & Snags |
| (W) Wooded | (---) Marsh | C. Clay | ☼ Rock danger to navigation |
| (C) Cleared | (o) Spring | M. Marl | T Submergent vegetation |
| (P) Pastured | (---) Intermittent stream | Sd. Sand | L Emergent vegetation |
| (A) Agricultural | (---) Permanent inlet | Sl. Silt | △ Floating vegetation |
| B.M. Bench Mark | (---) Permanent outlet | Gr. Gravel | ⬆ Brush shelters |
| (■) Dwelling | (---) Dam | R. Rubble | |
| (■) Resort | (---) State owned land | R. Reservoir | |

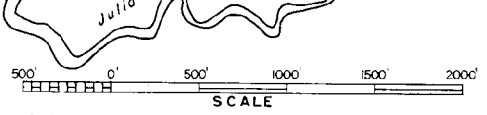

◆ Access ◆ Access with Parking ◆ Boat Livery
Drawn by: C. Holt

SPECIES OF FISH	1969		
	Abundant	Common	Present
Muskie	X	X	X
N. Pike	X	X	X
Walleye	X	X	X
L. M. Bass	X	X	X
S. M. Bass	X	X	X
Panfish	X	X	X
Trout	X	X	X

WATER AREA 2776 ACRES
UNDER 3 FT. 6.6 %
OVER 20 FT. 13.2 %
MAX. DEPTH 31 FEET.
TOTAL ALK. 3.6 P.P.M.
VOLUME 3638.3 ACRE FT.
SHORELINE 302 MILES