

WISCONSIN CONSERVATION DEPARTMENT

LAKE SURVEY MAP

VAN ORDER POND
LAKE
PORTAGE COUNTY
SEC. 36, 31, 1, 6 T. 24, 25 N. R. 8, 9 E. 1/4

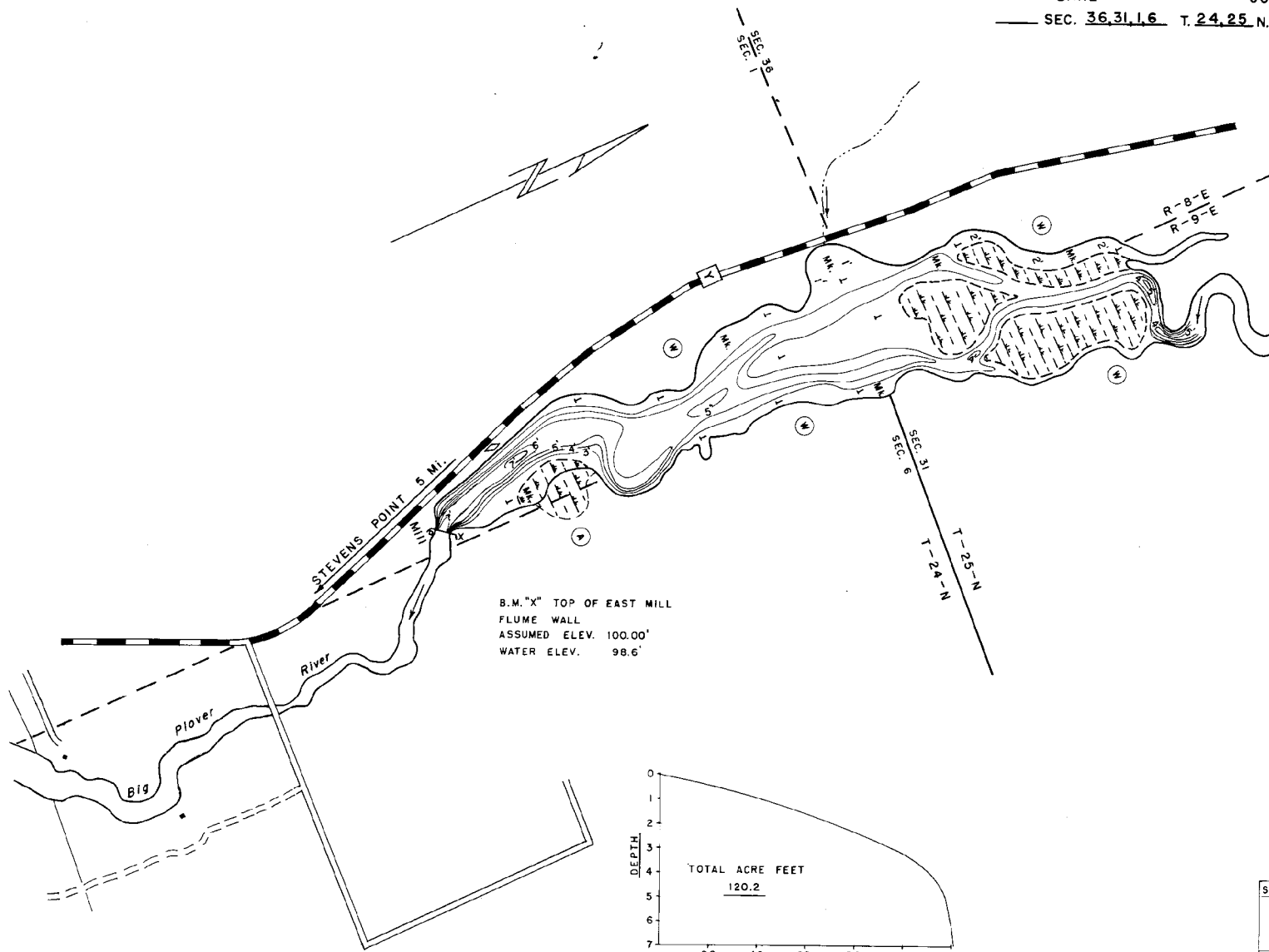

B.M. "X" TOP OF EAST MILL
FLUME WALL
ASSUMED ELEV. 100.00'
WATER ELEV. 98.6'

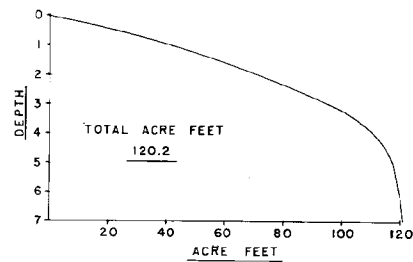

EQUIPMENT: SONAR MAPPED JUNE 1964

- TOPOGRAPHIC SYMBOLS
- (B) Brush
 - (PW) Partly wooded
 - (W) Wooded
 - (C) Cleared
 - (P) Pastured
 - (A) Agricultural
 - B.M. Bench Mark
 - Dwelling
 - Resort
- MO. YR.
- ||||| Steep slope
 - - - Indefinite shoreline
 - Marsh
 - Spring
 - Intermittent stream
 - Permanent inlet
 - Permanent outlet
 - Dam
- LAKE BOTTOM SYMBOLS
- P. Peat
 - Mk. Muck
 - C. Clay
 - M. Marl
 - Sd. Sand
 - St. Silt
 - Gr. Gravel
 - R. Rubble
 - Br. Bedrock
 - T. Submergent vegetation
 - I. Emergent vegetation
 - △ Floating vegetation

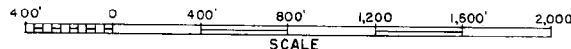

◇ Access ◇ Access with Parking ◆ Boat Livery
Field work by: H. Schmude, F. Herbert Drawn by: E. Eaton

SPECIES OF FISH	
	Abundant Common Rare
Muskie	
N. Pike	
Walleye	
L. M. Bass	
S. M. Bass	
Panfish	
Trot	

53.2 WITH MARSH
AREA 41.6 ACRES
UNDER 3FT. 46 %
OVER 20FT. 0 %
VOLUME 120.2 ACRE FT.
TOTAL ALK. 172 P.P.M.
SHORELINE 3.2 MILES
MAX. DEPTH 7 FEET