

WISCONSIN CONSERVATION DEPARTMENT

LAKE SURVEY MAP

UPPER MUD LAKE DANE COUNTY

B.M. Top of brass bolt near guard rail of S.W. corner of highways 12 & 18 bridge
Assumed elev. 100.00
Water elev. 86.54

SEC. 28, 29 T. 7 N. R. 10 E.

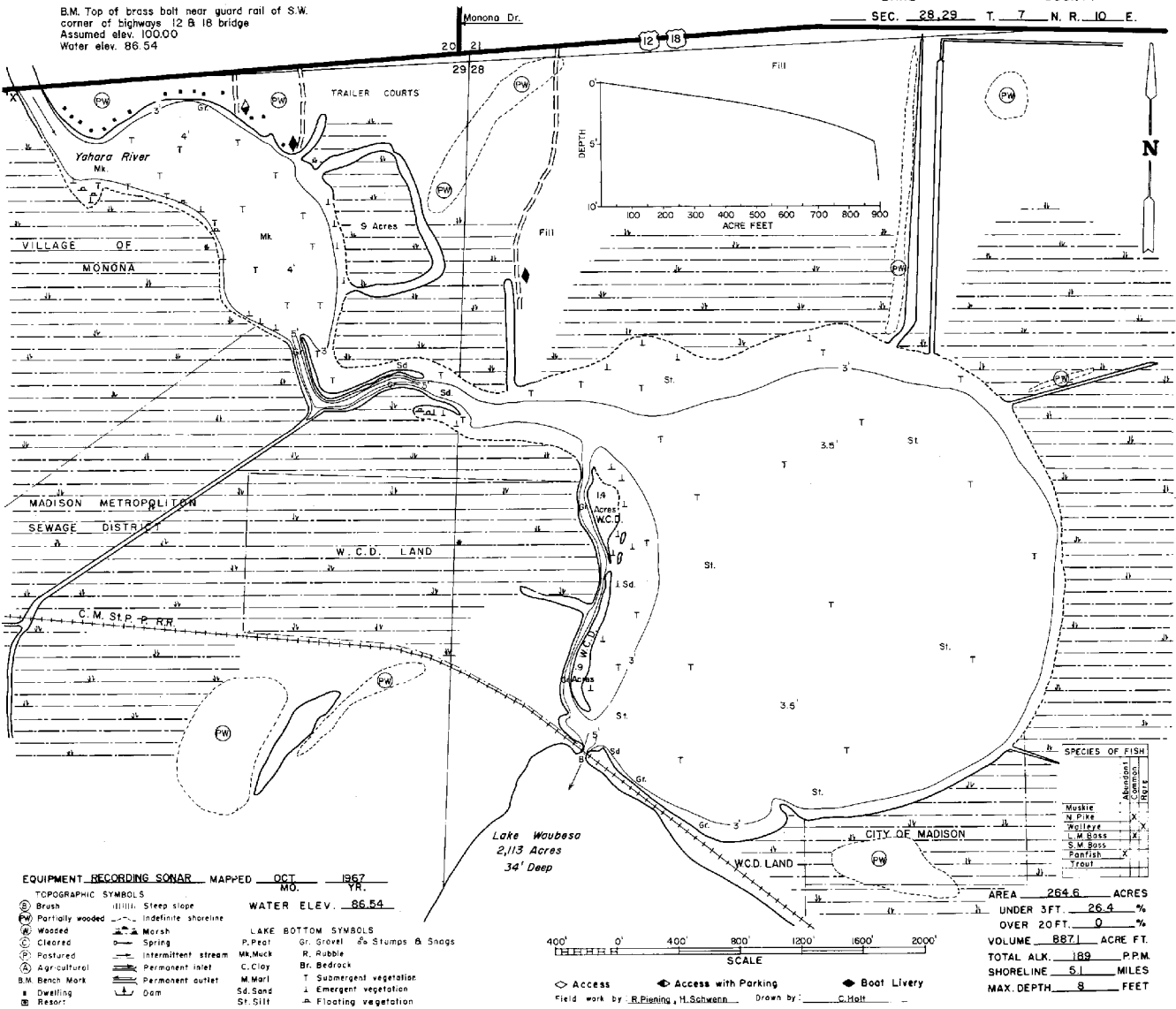

Maps are not for navigation
Source-Wisconsin Department of Natural Resources
Hunt Fish Camp Wisconsin .Com 2005