

STATE OF WISCONSIN
DEPARTMENT OF NATURAL RESOURCES

LAKE SURVEY MAP

UPPER BASS LAKE
MENOMINEE COUNTY
SEC. 1, 2 T. 30 N. R. 13 E.

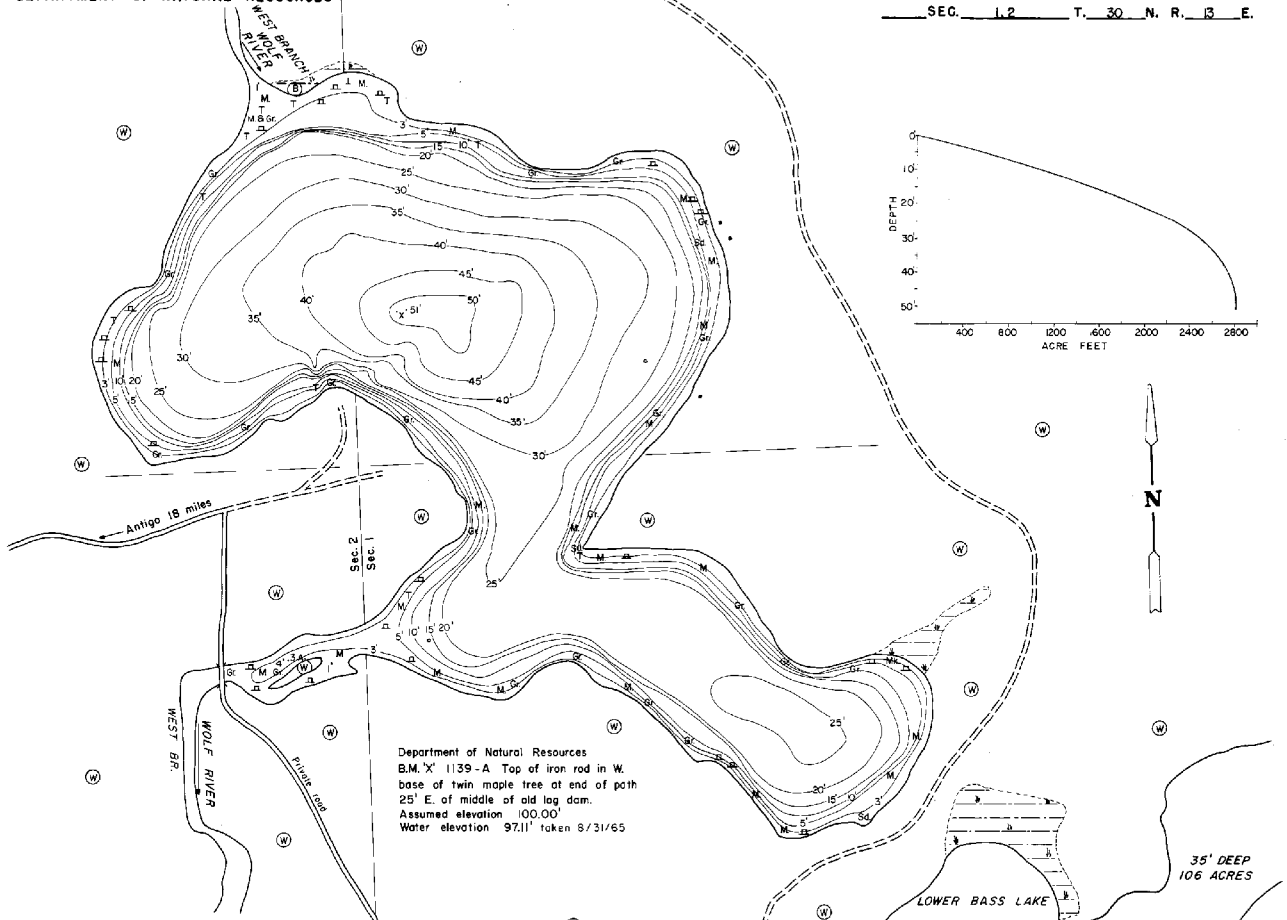

Department of Natural Resources
B.M. 'X' 1139-A Top of iron rod in W.
base of twin maple tree at end of path
25' E. of middle of old log dam.
Assumed elevation 100.00'
Water elevation 97.11' taken 9/31/65

EQUIPMENT	RECORDING	SONAR	MAPPED	MONTH	YEAR
				JULY	1968

TOPOGRAPHIC SYMBOLS		LAKE BOTTOM SYMBOLS	
(B) Brush	Steep slope	P. Peat	B Boulders
(W) Partially wooded	- Indefinite shoreline	Mk Muck	St Slumps & Snags
(W) Wooded	Marsh	C. Clay	Rock danger to navigation
(C) Cleared	Spring	M. Moril	T Submergent vegetation
(P) Pastured	Intermittent stream	Sd. Sand	I Emergent vegetation
(A) Agricultural	Permanent inlet	Sl. Silt	F Floating vegetation
B.M. Bench Mark	Permanent outlet	Gr. Gravel	BS Brush shelters
Dwelling	Dam	R. Rubble	
Resort	D.N.R. State owned land	Bc Bedrock	
Camp			

300' 0' 300' 600' 900' 1200'
SCALE
◆ Access ◆ Access with Parking ◆ Boat Livery
Drawn by: C. Hall
Field work by: P. Michelson, J. Smith

SPECIES OF FISH	NUMBER		PRESENT
	CATCHED	COMMON	
Muskie			
N. Pike			
Walleye			
L. M. Bass	X		
S. M. Bass	X		
Panfish	X		
Trout	X		
Trout, Bk	X		

WATER AREA 123.3 ACRES
UNDER 3 FT. 9 %
OVER 20 FT. 65 %
MAX. DEPTH 51 FEET.
TOTAL ALK. 169 P.P.M.
VOLUME 2810.8 ACRE FT.
SHORELINE 2.83 MILES
SHORELINE 2.91 WITH ISLANDS

Maps are not for navigation
Source-Wisconsin Department of Natural Resources
Hunt Fish Camp Wisconsin .Com 2005