

STATE OF WISCONSIN
DEPARTMENT OF NATURAL RESOURCES

LAKE SURVEY MAP

TWIN FALLS FLOWAGE FLORENCE COUNTY
LAKE 20-21
SEG. 22-27-34 T. 39-40 N. R. 19 E.W.
Sheet 3 of 4 Sheets

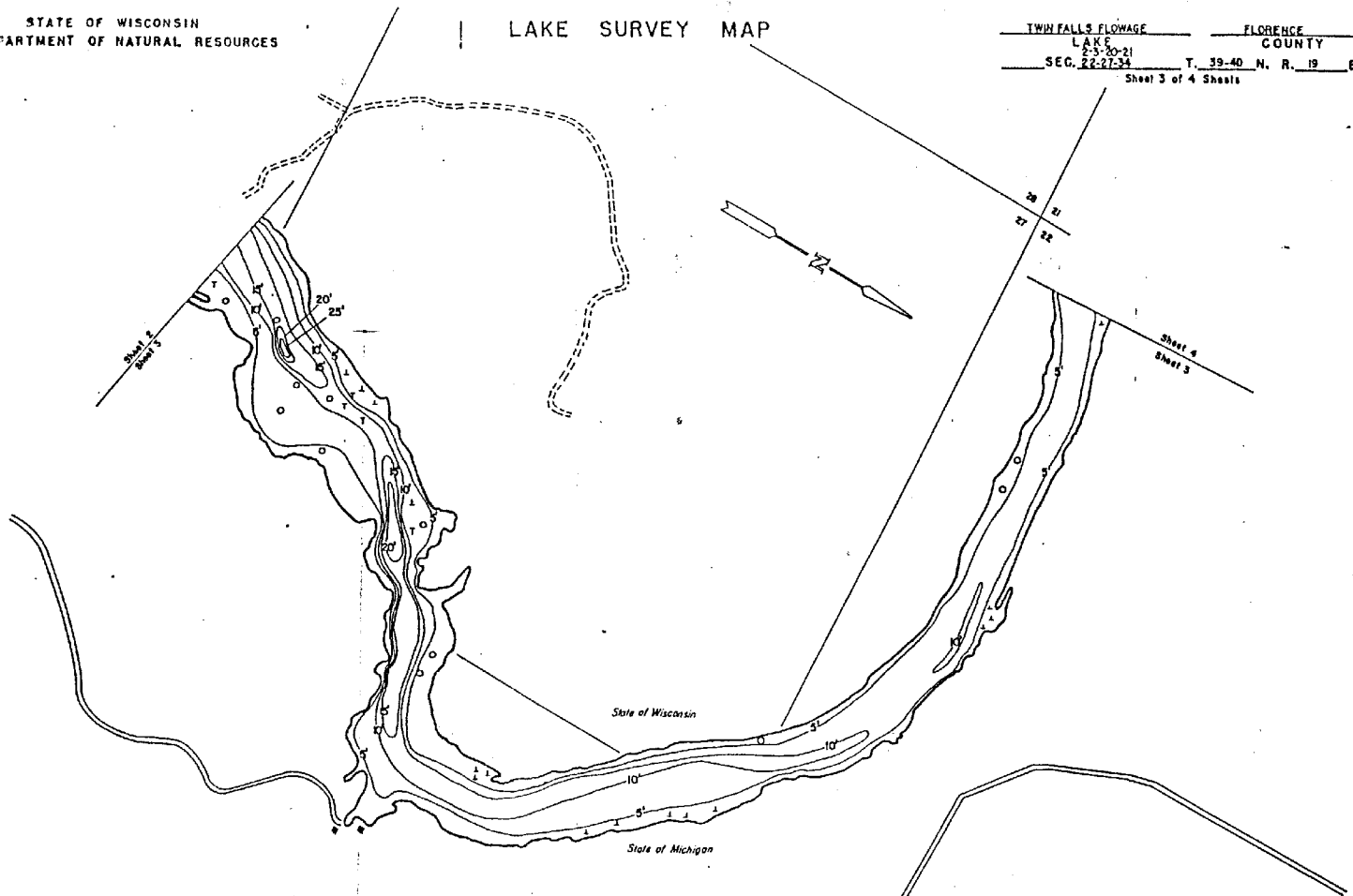

EQUIPMENT	RECORDING	SQIAR	MAPPED	JUNE	1975
			MONTH	YEAR	
TOPOGRAPHIC SYMBOLS					
①	Brush	①	Steep slope	P.	Peat
②	Partially wooded	②	Indistinct shoreline	Mh.	Muck
③	Wooded	③	Marsh	C.	Clay
④	Cleared	④	Spring	W.	Wet
⑤	Pastured	⑤	Intermittent stream	Se.	Sand
⑥	Agricultural	⑥	Permanent inlet	St.	Silt
B.M.	Bench Mark	⑦	Permanent outlet	Gr.	Gravel
□	Dwelling	⑧	Dam	A.	Allyble
□	Boat	⑨	D.N.R. State owned land	Bc	Bedrock
□	Camp				

LAKE BOTTOM SYMBOLS	
⊙	Boulders
⊖	Stumps & Snags
⊗	Rock danger to navigation
⊕	Submerged vegetation
⊘	Emergent vegetation
⊙	Floating vegetation
⊖	Brush shelters

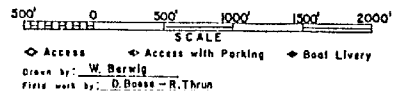

SPECIES OF FISH	LAKE 20-21	
	LAKE 20-21	LAKE 20-21
Walleye	✓	✓
Whitefish	✓	✓
Yellow perch	✓	✓
Rock Bass	✓	✓
Smallmouth Bass	✓	✓
Brook Trout	✓	✓
Bluegill	✓	✓
Crappie	✓	✓
Other		

WATER AREA	827.92	ACRES
UNDER 3 FT.	17	%
OVER 20 FT.	2	%
MAX. DEPTH	50	FEET.
TOTAL ALK.	60	P.P.M.
VOLUME	9873.92	ACRE FT.
MAIN SHORELINE	18.8	MI.

Maps are not for navigation
Source-Wisconsin Department of Natural Resources
Hunt Fish Camp Wisconsin .Com 2005