

STATE OF WISCONSIN
DEPARTMENT OF NATURAL RESOURCES

LAKE SURVEY MAP

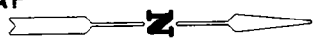

SHAWANO LAKE
SEC. 9, 10, 13 THRU 30 T. 27 N. R. 16, 17 E.
SHAWANO COUNTY
(Sheet 2 of 3)
Sheet "1"
Sheet "2"

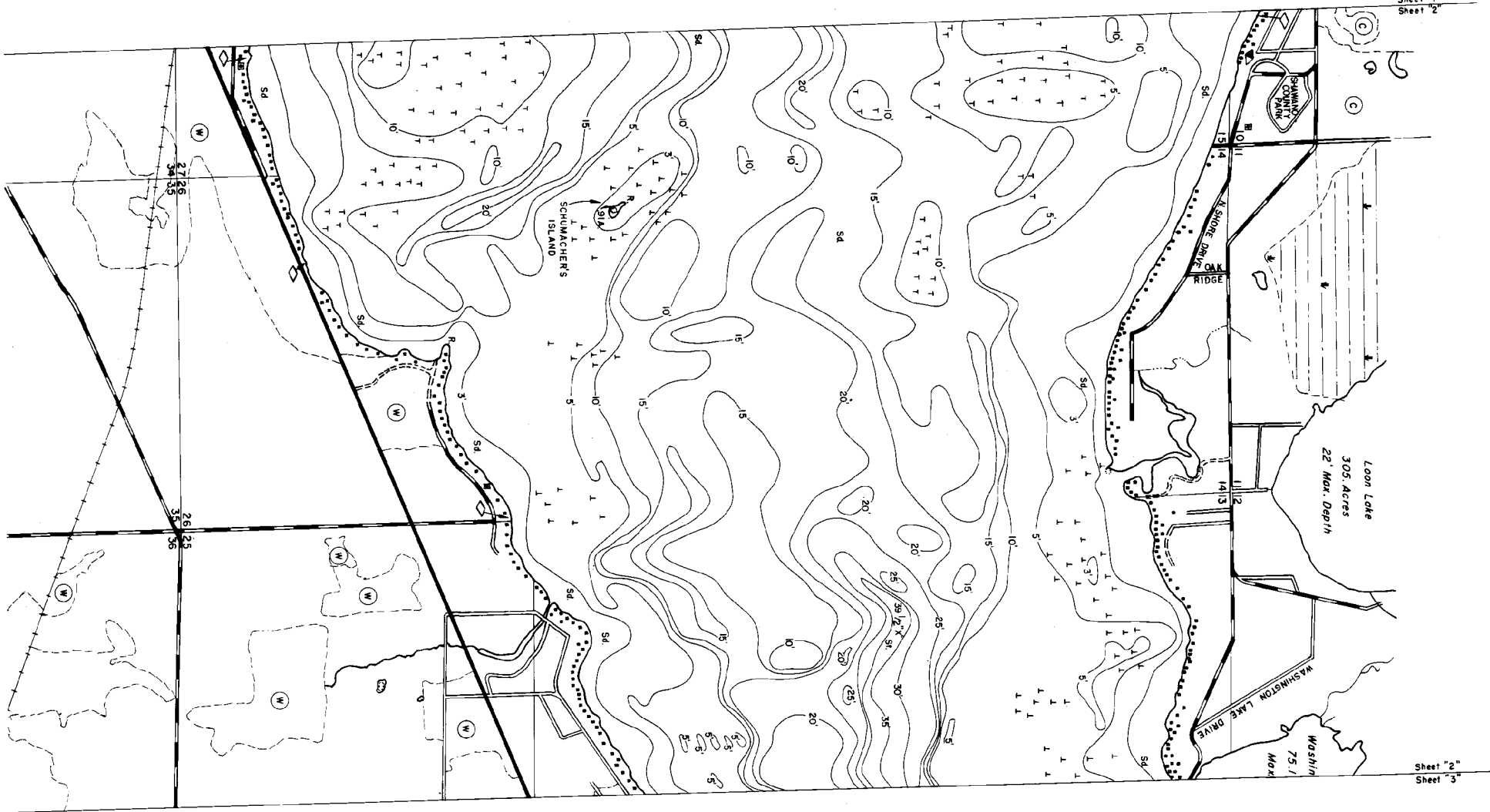

EQUIPMENT RECORDING SONAR MAPPED JULY 1974

- | TOPOGRAPHIC SYMBOLS | | MONTH | YEAR |
|-----------------------|-------------------------|-------------|-----------------------------|
| | | JULY | 1974 |
| | | LAKE BOTTOM | SYMBOLS |
| (B) Brush | Steep slope | P. Peat | B Boulders |
| (PW) Partially wooded | ~ Indefinite shoreline | Mk Muck | ☼ Stumps & Snags |
| (W) Wooded | ☼ Marsh | C. Clay | ⚠ Rock danger to navigation |
| (C) Cleared | o Spring | M. Marl | T Submergent vegetation |
| (P) Pastured | ~ Intermittent stream | Sd. Sand | ⊥ Emergent vegetation |
| (A) Agricultural | ~ Permanent inlet | Sl. Silt | ⊥ Floating vegetation |
| B.M. Bench Mark | ~ Permanent outlet | Gr. Gravel | ⊥ Brush shelters |
| ■ Dwelling | ∩ Dam | R. Rubble | |
| ■ Resort | D.N.R. State owned land | Bc. Bedrock | |
| ■ Camp | | | |

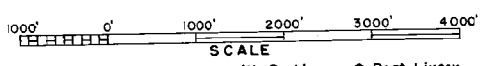

◆ Access ◆ Access with Parking ◆ Boat Livery
 Drawn by: G.Thuesen
 Field work by: D.Boese, R.Thrun

SPECIES OF FISH	Present			
	Abundant	Common	Present	Present
Muskie				
N. Pike	X			
Walleye	X			
L.M.Bass		X		
S.M.Bass		X		
Panfish	X			
Trout				

WATER AREA 6062.7 ACRES
 UNDER 3 FT. 11.3 %
 OVER 20 FT. 6.16 %
 MAX. DEPTH 39.5 FEET
 TOTAL ALK. 86 P.P.M.
 VOLUME 54,270.25 ACRE FT.
 MAIN SHORELINE 18.33 MI.
 ISLAND SHORELINE 0.37 MI.