

STATE OF WISCONSIN  
DEPARTMENT OF NATURAL RESOURCES

LAKE SURVEY MAP

ROUND LAKE SHAWANO COUNTY  
SEC. 33 T. 26 N. R. 15 E.

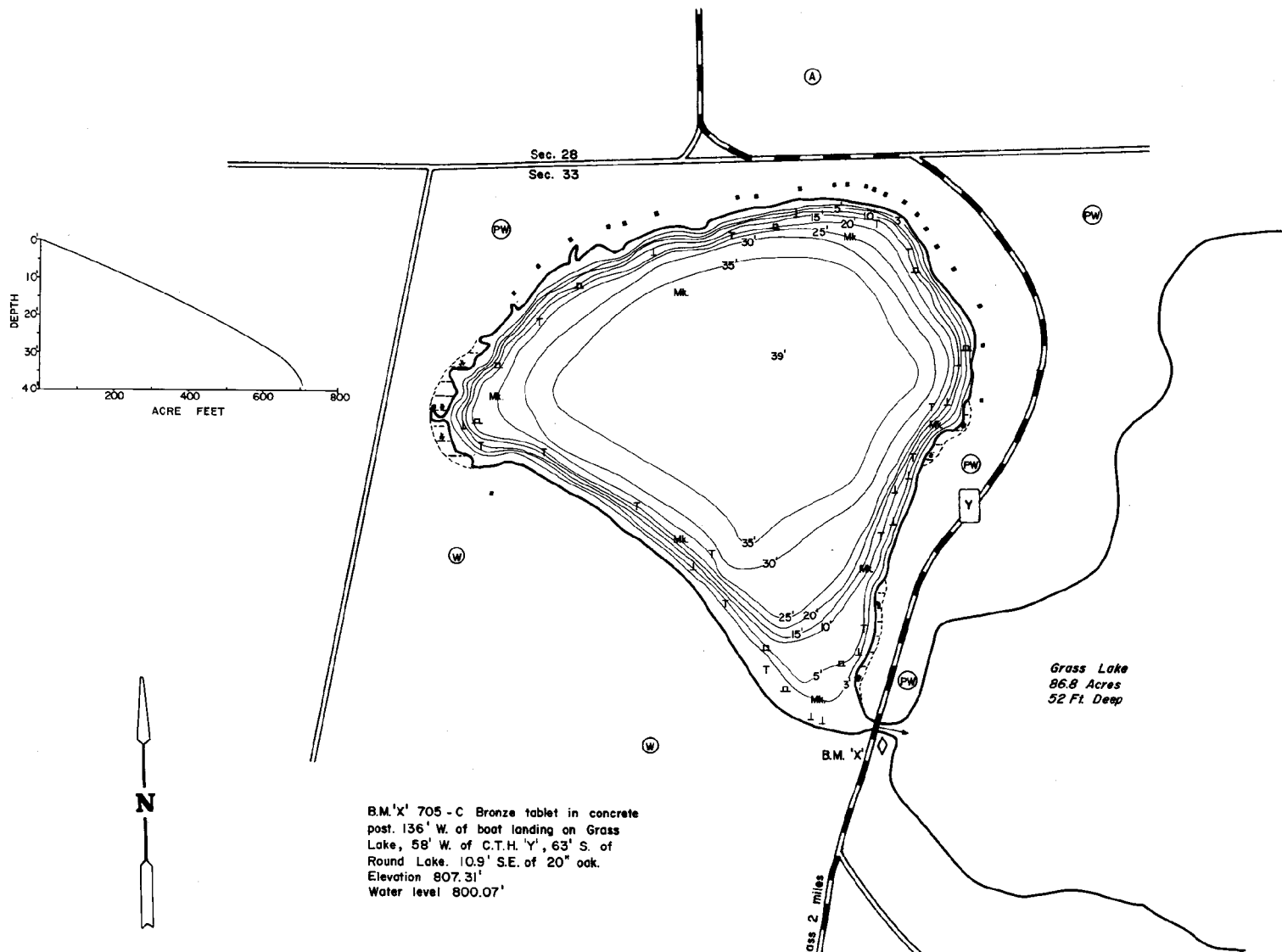

B.M.'X' 705 - C Bronze tablet in concrete post. 136' W. of boat landing on Grass Lake, 58' W. of C.T.H. 'Y', 63' S. of Round Lake. 10.9' S.E. of 20" oak. Elevation 807.31' Water level 800.07'

Grass Lake  
86.8 Acres  
52 Ft. Deep

EQUIPMENT RECORDING SONAR MAPPED JUNE 1967

- | TOPOGRAPHIC SYMBOLS |                         | LAKE BOTTOM SYMBOLS |                             |
|---------------------|-------------------------|---------------------|-----------------------------|
| (B) Brush           | Steep slope             | P. Peat             | B Boulders                  |
| (PW) Partly wooded  | ~ Indefinite shoreline  | Mk. Muck            | ☼ Stumps & Snags            |
| (W) Wooded          | ~ Marsh                 | C. Clay             | ☼ Rock danger to navigation |
| (C) Cleared         | ~ Spring                | M. Marl             | T Submergent vegetation     |
| (P) Pastured        | ~ Intermittent stream   | Sd. Sand            | ! Emergent vegetation       |
| (A) Agricultural    | ~ Permanent inlet       | Sl. Silt            | ~ Floating vegetation       |
| B.M. Bench Mark     | ~ Permanent outlet      | Gr. Gravel          | ☼ Brush shelters            |
| ■ Dwelling          | ~ Dam                   | R. Rubble           |                             |
| ■ Resort            | D.N.R. State owned land | Bc Bedrock          |                             |
| ■ Camp              |                         |                     |                             |



Access Access with Parking Boat Livery  
Drawn by: C. Holt  
Field work by: P. Michelson, J. Smith

SPECIES OF FISH	Abundance		
	Abundant	Common	Present
Muskie			X
N. Pike	X		
Walleye	X		
L. M. Bass	X		
S. M. Bass	X		
Panfish	X		
Trout			

WATER AREA 27.2 ACRES  
UNDER 3 FT. 10 %  
OVER 20 FT. 72 %  
MAX. DEPTH 39 FEET.  
TOTAL ALK. 115 P.P.M.  
VOLUME 707.9 ACRE FT.  
SHORELINE 0.95 MILES