

STATE OF WISCONSIN
DEPARTMENT OF NATURAL RESOURCES

LAKE SURVEY MAP

ROUND LAKE
POLK COUNTY
SEC. 26 T. 33 N. R. 18 W.

B.M. 'X' 1563-A
IS A 2" + cut in Round Lake side
of N. culvert under C.T.H. 'Y', 15' E. of
centerline of C.T.H. 'Y'
Assumed elevation 100.00'
Water level 98.33'

Horse Lake
2276 Acres
11' Max. Depth

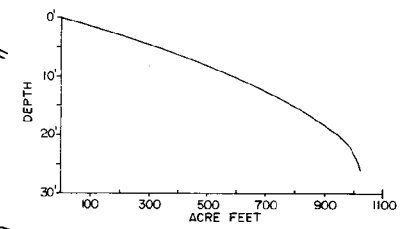
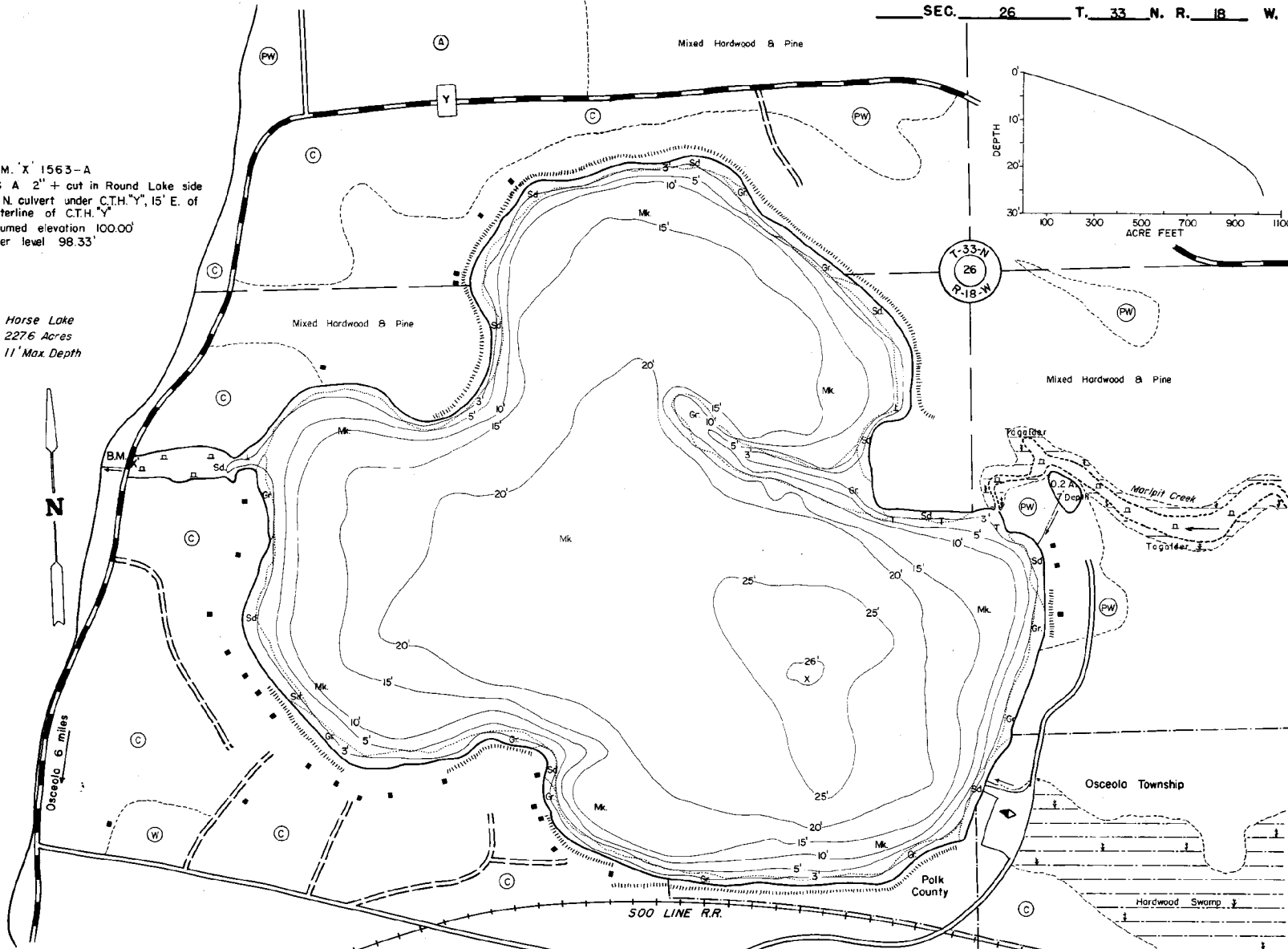

EQUIPMENT RECORDING SONAR MAPPED JUNE 1969

- | TOPOGRAPHIC SYMBOLS | | LAKE BOTTOM SYMBOLS | |
|-----------------------|---------------------------|---------------------|-----------------------------|
| (B) Brush | Steep slope | P. Peat | B Boulders |
| (PW) Partially wooded | ~ Indefinite shoreline | Mk. Muck | ⊕ Stumps & Snags |
| (W) Wooded | ~ Marsh | C. Clay | ⚠ Rock danger to navigation |
| (C) Cleared | ~ Spring | M. Marl | T Submergent vegetation |
| (P) Pastured | ~ Intermittent stream | Sd. Sand | J Emergent vegetation |
| (A) Agricultural | ~ Permanent inlet | Sl. Silt | △ Floating vegetation |
| B.M. Bench Mark | ~ Permanent outlet | Gr. Gravel | ⬇ Brush shelters |
| ■ Dwelling | ~ Dam | R. Rubble | |
| ■ Resort | ~ D.N.R. State owned land | Bc Bedrock | |
| ■ Camp | | | |



Access Access with Parking Boat Livery
Drawn by: C. Holt
Field work by: C. Busch, S. Johannes

SPECIES OF FISH	Abundance		
	Uncommon	Common	Present
Muskie			
N. Pike	X		
Walleye	X		
L. M. Bass	X		
S. M. Bass	X		
Panfish	X		
Trout			

WATER AREA 671 ACRES
UNDER 3 FT. 76 %
OVER 20 FT. 391 %
MAX. DEPTH 26 FEET.
TOTAL ALK. 110 P.P.M.
VOLUME 1025.6 ACRE FT.
SHORELINE 158 MILES