

STATE OF WISCONSIN  
DEPARTMENT OF NATURAL RESOURCES

LAKE SURVEY MAP

RANCH LAKE OCONTO COUNTY  
SEG. 12 T.-31- N. R.-18- E.W.

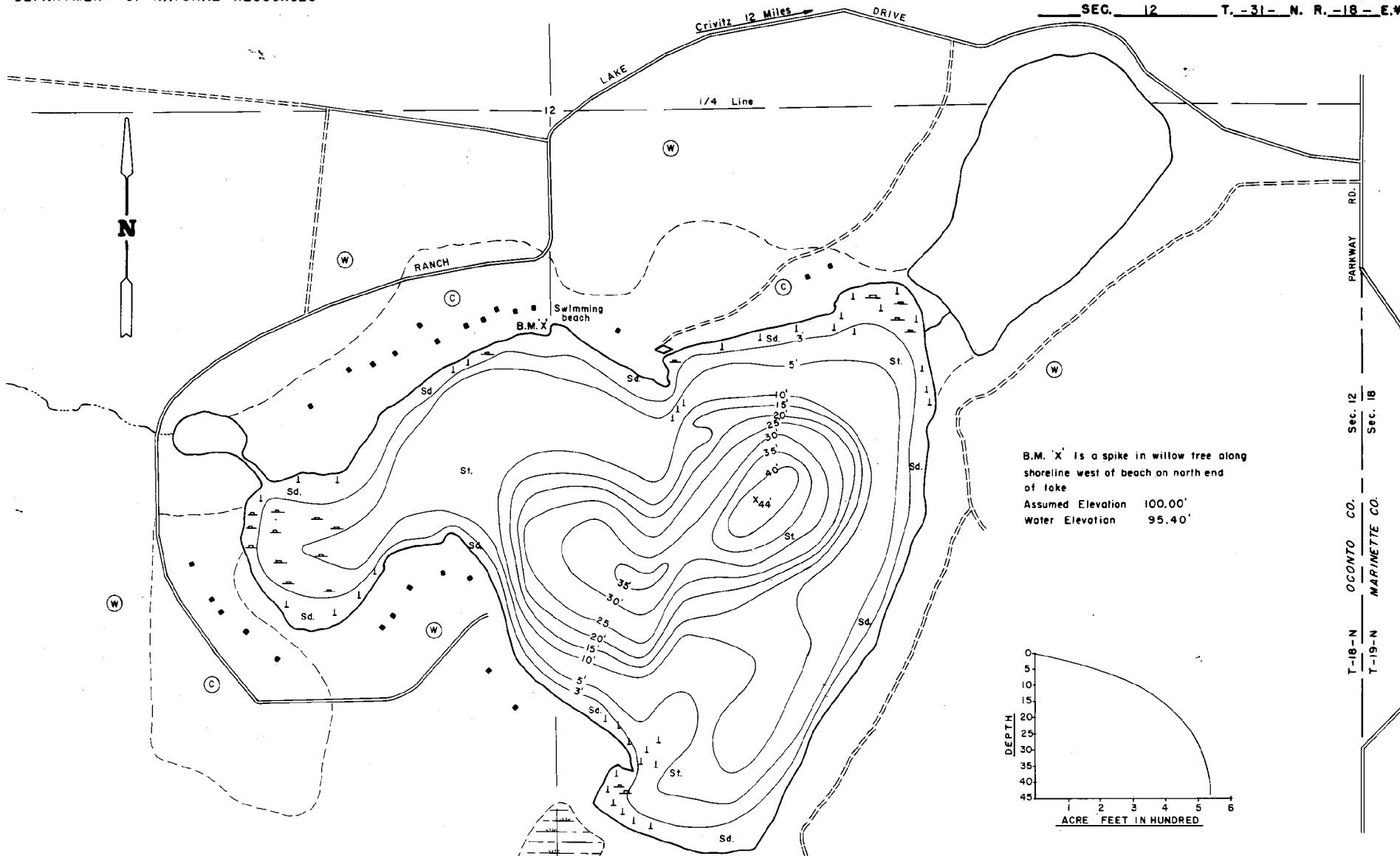

B.M. 'X' is a spike in willow tree along shoreline west of beach on north end of lake  
Assumed Elevation 100.00'  
Water Elevation 95.40'

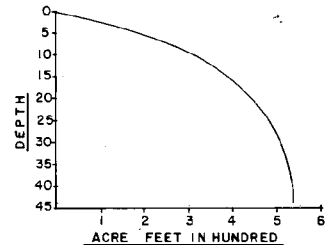

EQUIPMENT RECORDING SONAR MAPPED JULY 1974

TOPOGRAPHIC SYMBOLS		LAKE BOTTOM SYMBOLS	
		MONTH	YEAR
(B) Brush	(//) Steep slope	P. Peat	B Boulders
(W) Partly wooded	(---) Indefinite shoreline	Mk. Muck	(S) Stumps & Snags
(W) Wooded	(M) Marsh	C. Clay	(R) Rock danger to navigation
(C) Cleared	(S) Spring	M. Marl	(T) Submergent vegetation
(P) Pastured	(---) Intermittent stream	Sd. Sand	(I) Emergent vegetation
(A) Agricultural	(---) Permanent inlet	St. Silt	(F) Floating vegetation
B.M. Bench Mark	(---) Permanent outlet	Gr. Gravel	(BS) Brush shelters
(D) Dwelling	(D) Dam	R. Rubble	
(R) Resort	(S.O.L.) B.N.R. State owned land	Bc. Bedrock	
(C) Camp			



Access Access with Parking Boat Livery  
Drawn by: E. Eaton  
Field work by: D. Bass, R. Thrun

SPECIES OF FISH	Abundance	
	Common	Present
Muskie		
N. Pike		X
Walleye		X
L. M. Bass	X	
S. M. Bass		
Panfish	X	
Trotl		

WATER AREA 48.0 ACRES  
UNDER 3 FT. 17 %  
OVER 20 FT. 19 %  
MAX. DEPTH 44 FEET.  
TOTAL ALK. 68 P.P.M.  
VOLUME 535.1 ACRE FT.  
MAIN SHORELINE 1.48 MI.  
ISLAND SHORELINE MI.