

STATE OF WISCONSIN
DEPARTMENT OF NATURAL RESOURCES

LAKE SURVEY MAP

POTTER FLOWAGE LAKE JACKSON COUNTY
SEC. 16, 17, 20 T. 21 - N. R. 1 - W.
(Sheet 2 of 3)

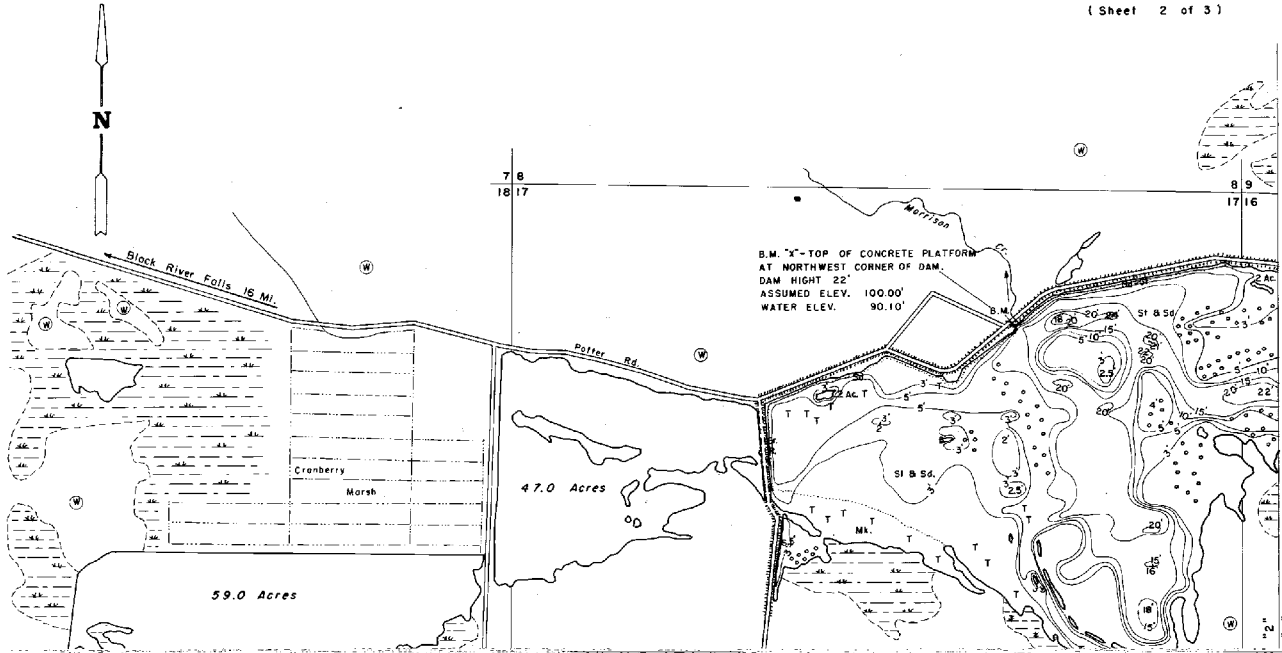

Maps are not for navigation
Source-Wisconsin Department of Natural Resources
Hunt Fish Camp Wisconsin .Com 2005