

WISCONSIN CONSERVATION DEPARTMENT

LAKE SURVEY MAP

LAKE NYMPHIA POND  
 SECTION 11 & 14  
 TOWNSHIP 45 N.  
 RANGE 7 W.  
 TOWN \_\_\_\_\_  
 COUNTY BAYFIELD

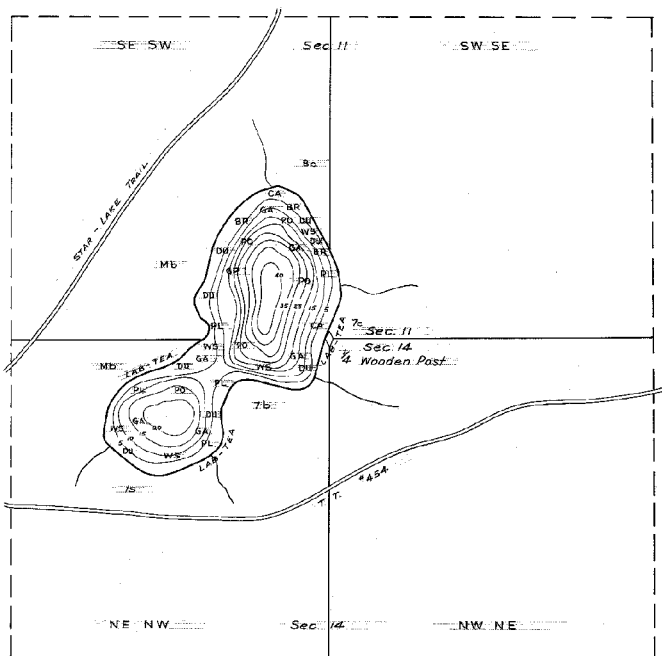

DATE 1937  
 SOURCE OF INFORMATION U.S. Department of Agriculture Forest Service  
 SOUNDINGS 5' intervals

AREA 12 Acres  
 TOTAL SHORELINE .70 Miles  
 MAX. DEPTH 40 Feet  
 SCALE 16" = 1 Mile

Maps are not for navigation  
 Source-Wisconsin Department of Natural Resources  
 Hunt Fish Camp Wisconsin .Com 2005