

STATE OF WISCONSIN
DEPARTMENT OF NATURAL RESOURCES

LAKE SURVEY MAP

NORTH WHITE ASH LAKE
POLK COUNTY
SEC. 2 T. 34 N. R. 16 W.

B.M. No. 1566-A, is a railroad spike set in the N. side of 12" elm, 12" above ground, located 35' S. of centerline of town road and 35' W. of boat landing.
Assumed elevation 100.00
Water level 92.12' taken 7/3/69

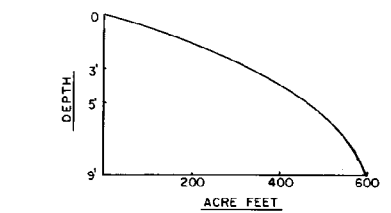
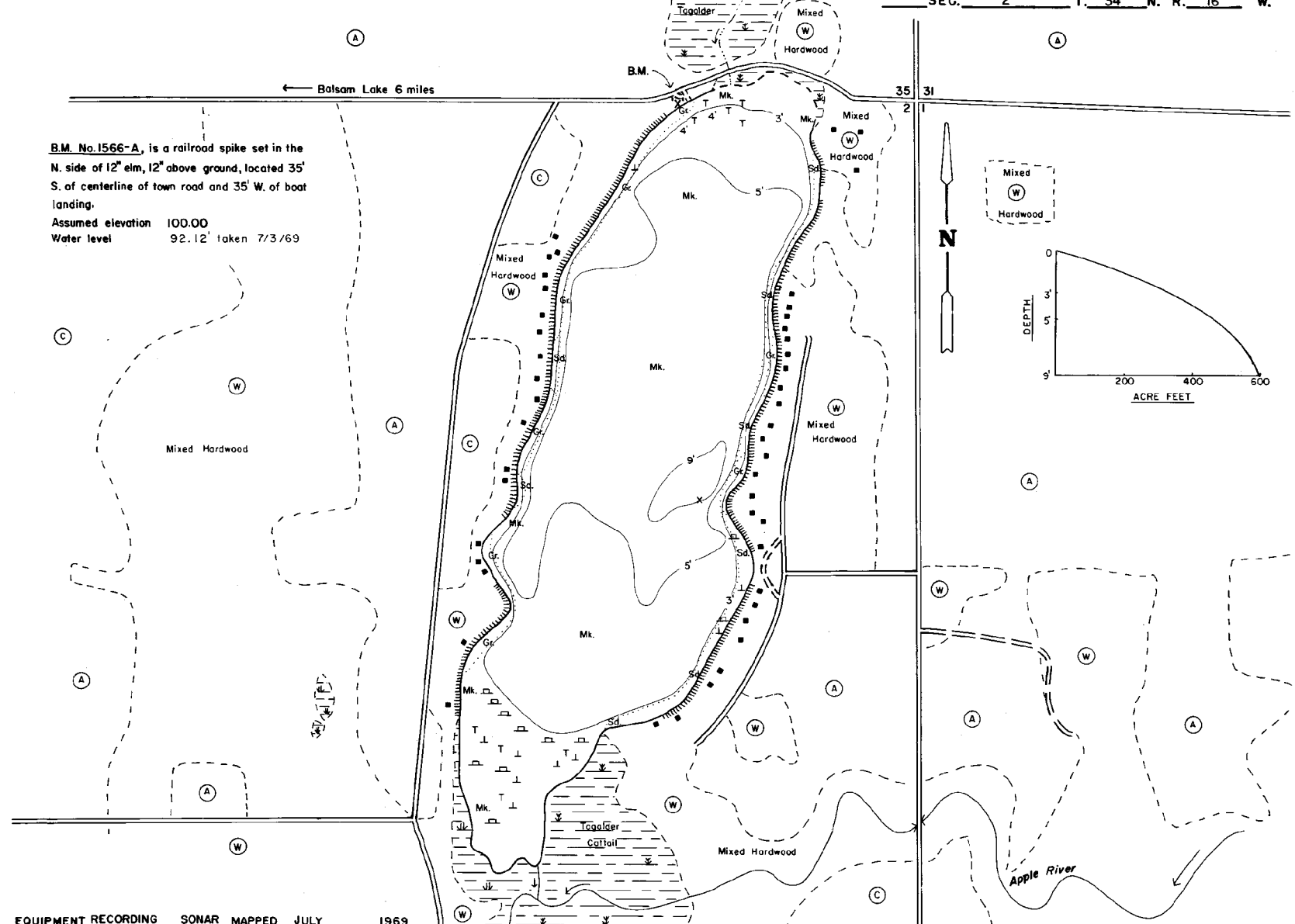

- EQUIPMENT RECORDING SONAR MAPPED JULY 1969
- | TOPOGRAPHIC SYMBOLS | | LAKE BOTTOM SYMBOLS | |
|----------------------|---------------------------|---------------------|-----------------------------|
| (B) Brush | Steep slope | P. Peat | B Boulders |
| (W) Partially wooded | ~ Indefinite shoreline | Mk. Muck | ⚡ Slumps & Snags |
| (W) Wooded | ~ Marsh | C. Clay | ⚡ Rock danger to navigation |
| (C) Cleared | ~ Intermittent stream | M. Marl | T Submergent vegetation |
| (P) Pastored | ~ Permanent inlet | Sd. Sand | 1 Emergent vegetation |
| (A) Agricultural | ~ Permanent outlet | Sl. Silt | ~ Floating vegetation |
| B.M. Bench Mark | ~ Dam | Gr. Gravel | ⚡ Brush shelters |
| ■ Dwelling | ~ D.N.R. State owned land | R. Rubble | |
| ■ Resort | | Bc. Bedrock | |
| ■ Camp | | | |

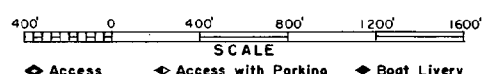

Access Access with Parking Boat Livery
Drawn by: T. Ginder
Field work by: C. Busch, C. Better, & S. Johannes

SPECIES OF FISH	Abundance		
	Abundant	Common	Present
Muskie			
N. Pike	X		
Walleye			
L. M. Bass	X		
S. M. Bass			
Panfish	X		
Trout			

WATER AREA 118.6 ACRES
UNDER 3 FT. 18 %
OVER 20 FT. 0 %
MAX. DEPTH 9 FEET.
TOTAL ALK. 95 P.P.M.
VOLUME 594.77 ACRE FT.
SHORELINE 2.11 MILES