

STATE OF WISCONSIN
DEPARTMENT OF NATURAL RESOURCES

LAKE SURVEY MAP

NORTH TWIN LAKE
POLK COUNTY
SEC. 28.29 T. -33 - N. R. -16- W.

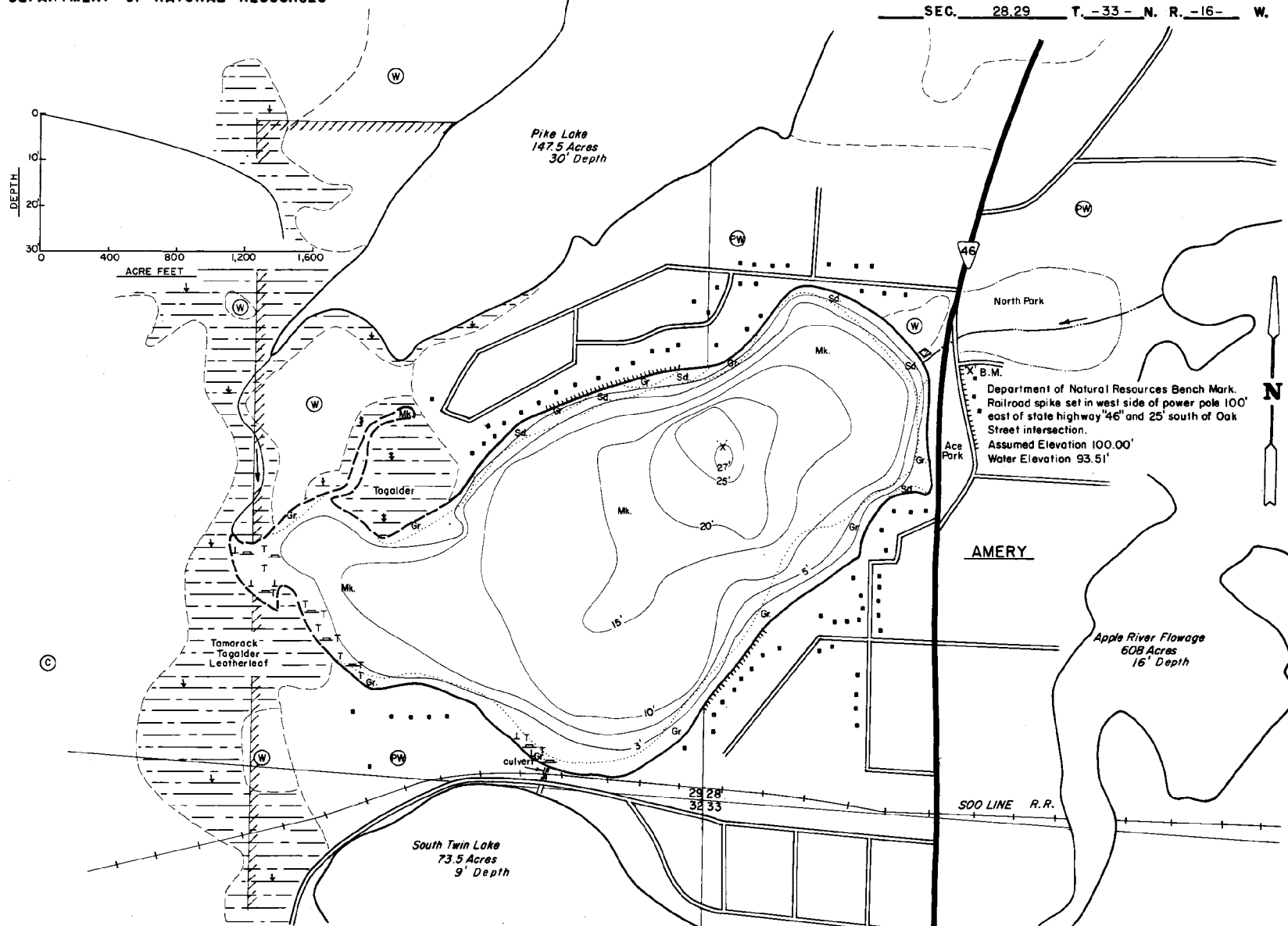

Department of Natural Resources Bench Mark.
Railroad spike set in west side of power pole 100'
east of state highway 46 and 25' south of Oak
Street intersection.
Assumed Elevation 100.00'
Water Elevation 93.51'

EQUIPMENT RECORDING SONAR MAPPED AUGUST 1969
MONTH YEAR

- | TOPOGRAPHIC SYMBOLS | | LAKE BOTTOM SYMBOLS | |
|---------------------|----------------------------------|---------------------|---------------------------|
| (S) Brush | (H) Steep slope | P. Peat | B. Boulders |
| (W) Partly wooded | (I) Indefinite shoreline | Mk. Muck | Stumps & Snags |
| (W) Wooded | (M) Marsh | C. Clay | Rock danger to navigation |
| (C) Cleared | (S) Spring | M. Marl | T. Submergent vegetation |
| (P) Pastured | (IS) Intermittent stream | Sd. Sand | I. Emergent vegetation |
| (A) Agricultural | (PI) Permanent inlet | Sl. Silt | F. Floating vegetation |
| B.M. Bench Mark | (PO) Permanent outlet | Gr. Gravel | BS. Brush shelters |
| (D) Dwelling | (D) Dam | R. Rubble | |
| (R) Resort | (D.N.R.) D.N.R. State owned land | Br. Bedrock | |



◆ Access ◆ Access with Parking ◆ Boat Livery

Drawn by: J. Roth
Field work by: C. Belter, C. Busch, S. Johannes

SPECIES OF FISH	PRESENT		
	Abundant	Common	Present
Muskie			
N. Pike	X		
Walleye	X		
L. M. Bass	X		
S. M. Bass	X		
Panfish	X		
Trout			

WATER AREA 135.0 ACRES
UNDER 3 FT. 13 %
OVER 20 FT. 8 %
MAX. DEPTH 27 FEET.
TOTAL ALK. 91 P.P.M.
VOLUME 1,421.8 ACRE FT.
SHORELINE 2.45 MILES