

STATE OF WISCONSIN
DEPARTMENT OF NATURAL RESOURCES

LAKE SURVEY MAP

PLACID TWIN (NORTH)
LAKE

VILAS
COUNTY

SEC. 26 T. 40 N. R. 5 E.

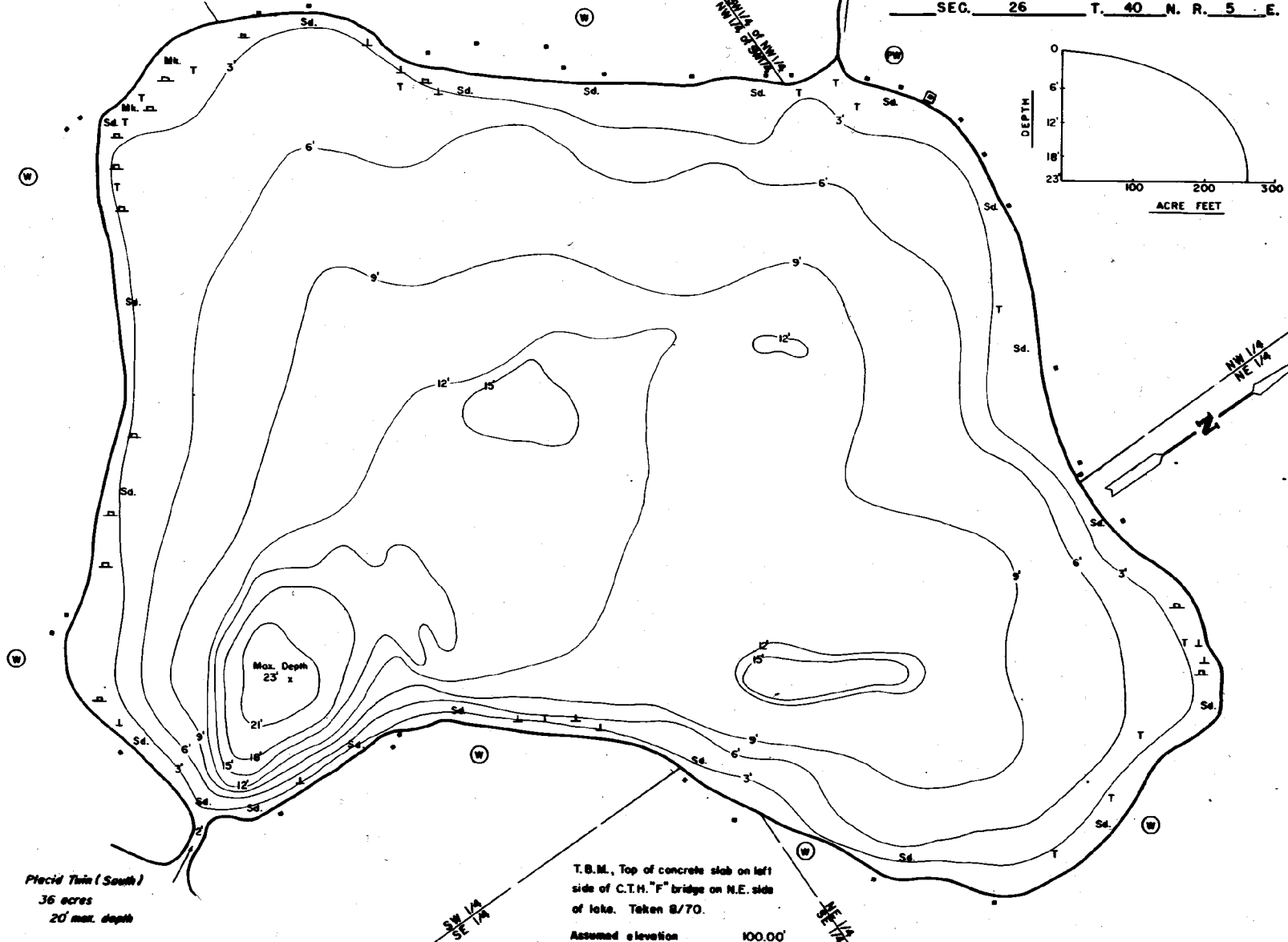

Placid Twin (South)
36 acres
20' max. depth

T.B.M., Top of concrete slab on left
side of C.T.H. "F" bridge on N.E. side
of lake. Taken 8/70.
Assumed elevation 100.00'
Water elevation 92.50'

- | | | | | |
|----------------------------|-----------------------------|-------------------|----------------------------|-------------------------------|
| EQUIPMENT RECORDING | SONAR | MAPPED | AUG | 1970 |
| TOPOGRAPHIC SYMBOLS | | | MONTH | YEAR |
| (1) Brush | (1) Steep slope | (1) Partly wooded | (1) Indefinite shoreline | (1) Marsh |
| (2) Cleared | (2) Spring | (3) Pastured | (3) Intermittent stream | (3) Agricultural |
| (4) B.M. Bench Mark | (4) Permanent inlet | (5) Ditching | (5) Permanent outlet | (5) Dam |
| (6) Resort | (6) B.N.R. State owned land | (7) Camp | | |
| | | | LAKE BOTTOM SYMBOLS | |
| | | | (B) Boulders | (S) Stumps & Snags |
| | | | (C) Clay | (R) Rock danger to navigation |
| | | | (M) Marl | (T) Submergent vegetation |
| | | | (Sd) Sand | (I) Emergent vegetation |
| | | | (St) Silt | (F) Floating vegetation |
| | | | (Gr) Gravel | (B) Brush shelters |
| | | | (R) Rubble | |
| | | | (Bc) Bedrock | |



Access Access with Parking Boat Livery
Drawn by: T. Gindor
Field work by: J. Smith & R. Crocker

SPECIES OF FISH		ABUNDANT	COMMON	PRESENT
Bluegill				
W. Pike				
Walleye				
W. Bass				
S. W. Bass				
Perch				
Trout				

WATER AREA 32.47 ACRES
UNDER 3 FT. 12 %
OVER 30 FT. 2 %
MAX. DEPTH 23 FEET
TOTAL ALK. 17 P.P.M.
VOLUME 228.91 ACRE FT.
SHORELINE .28 MILES