

STATE OF WISCONSIN  
DEPARTMENT OF NATURAL RESOURCES

LAKE SURVEY MAP

NEBISH LAKE  
VILAS COUNTY  
SEC. 10, 11 T. 41 N. R. 7 E.

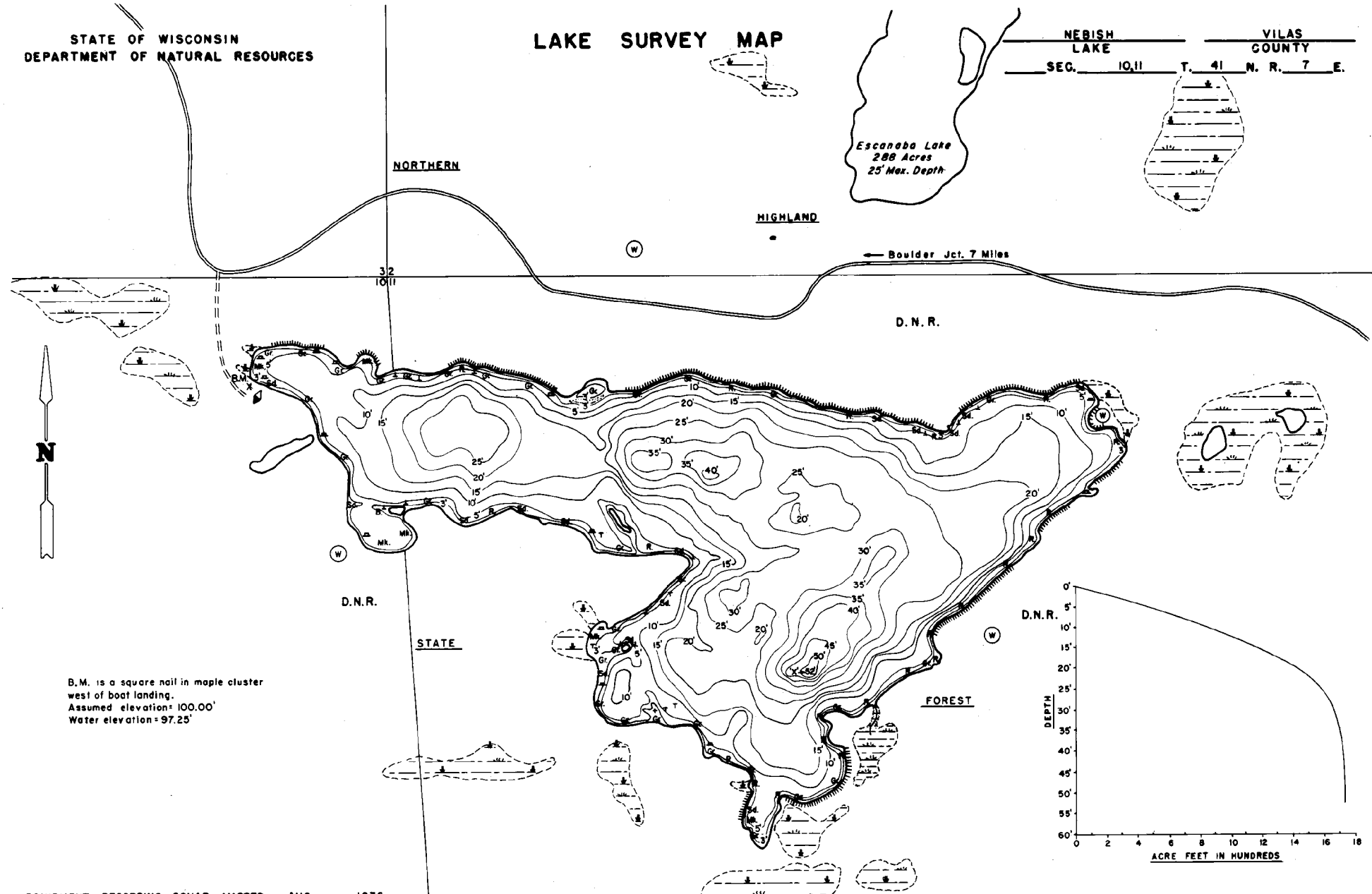

B.M. is a square nail in maple cluster west of boat landing.  
Assumed elevation = 100.00'  
Water elevation = 97.25'

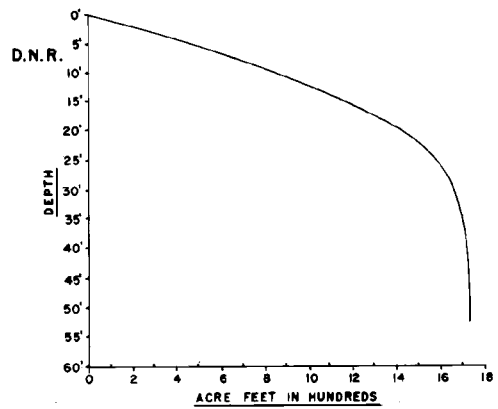

EQUIPMENT RECORDING SONAR MAPPED AUG. 1976  
MONTH YEAR

- | TOPOGRAPHIC SYMBOLS |                           | LAKE BOTTOM SYMBOLS |                             |
|---------------------|---------------------------|---------------------|-----------------------------|
| (B) Brush           | Steep slope               | P. Peat             | B Boulders                  |
| (PW) Partly wooded  | ~ Indefinite shoreline    | Mk. Muck            | ⚡ Stumps & Snags            |
| (W) Wooded          | ~ Marsh                   | C. Clay             | ⚡ Rock danger to navigation |
| (C) Cleared         | ~ Spring                  | M. Merl             | T Submergent vegetation     |
| (P) Pastured        | ~ Intermittent stream     | Sd. Sand            | J Emerging vegetation       |
| (A) Agricultural    | ~ Permanent inlet         | Sl. Silt            | ~ Floating vegetation       |
| B.M. Bench Mark     | ~ Permanent outlet        | Gr. Gravel          | ~ Brush shelters            |
| ■ Dwelling          | ~ Dam                     | R. Rubble           |                             |
| ■ Resort            | ~ D.N.R. State owned land | Bc. Bedrock         |                             |

300' 0' 300' 600' 900' 1200'  
SCALE  
◆ Access ◆ Access with Parking ◆ Boat Livery

SPECIES OF FISH	Abundance		
	Abundant	Common	Present
Bluegill			
Rock Bass			
Walleye			
L.M. Bass			
S.M. Bass	X		
Panfish	X		
Trout			

WATER AREA 98.3 ACRES  
UNDER 3 FT. 5.2 %  
OVER 20 FT. 42.8 %  
MAX. DEPTH 52 FEET.  
TOTAL ALK. 17 P.P.M.  
VOLUME 1731.29 ACRE FT.  
MAIN SHORELINE 2.6 MI.  
ISLAND SHORELINE .17 MI.

Drawn by: G. Thessa