

STATE OF WISCONSIN  
DEPARTMENT OF NATURAL RESOURCES

LAKE SURVEY MAP

NAMEKAGON LAKE BAYFIELD COUNTY

SEC. AS SHOWN T. 43 N. R. 6 W.  
SHEET 3 OF 3

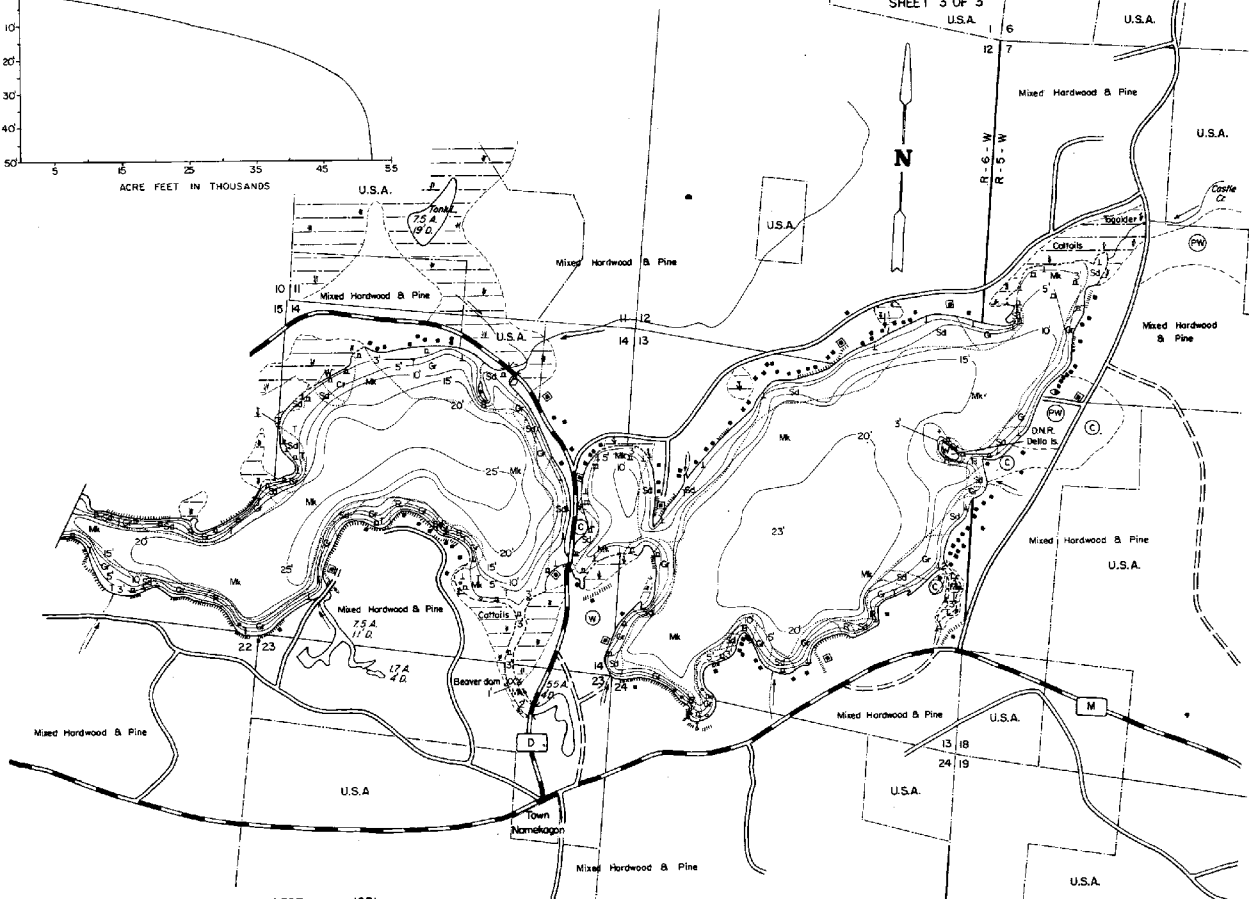
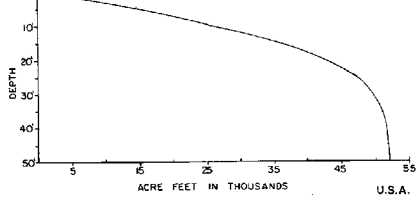

- | EQUIPMENT           | RECORDING               | SONAR               | MAPPED                      | SEPT                   | 1971 |
|---------------------|-------------------------|---------------------|-----------------------------|------------------------|------|
| TOPOGRAPHIC SYMBOLS |                         | LAKE BOTTOM SYMBOLS |                             |                        |      |
| ① Brush             | Steep slope             | P Peat              | B Boulders                  | ⚡ Stumps & Snags       |      |
| Ⓜ Partially wooded  | — Indefinite shoreline  | Mk. Muck            | ⚡ Rock danger to navigation | T Submerged vegetation |      |
| Ⓦ Wooded            | Ⓜ Marsh                 | C. Clay             | 1 Emergent vegetation       | △ Floating vegetation  |      |
| Ⓢ Cleared           | Ⓢ Spring                | M. Marl             | ⚡ Brush shelters            |                        |      |
| Ⓟ Pastured          | Ⓢ Intermittent stream   | Sd. Sand            |                             |                        |      |
| Ⓛ Agricultural      | Ⓢ Permanent inlet       | Sl. Silt            |                             |                        |      |
| B.M. Bench Mark     | Ⓢ Permanent outlet      | Gr. Gravel          |                             |                        |      |
| Ⓢ Dwelling          | Ⓢ Dam                   | R. Rubble           |                             |                        |      |
| Ⓢ Resort            | D.N.R. State owned land | Bc Bedrock          |                             |                        |      |
| Ⓢ Camp              |                         |                     |                             |                        |      |

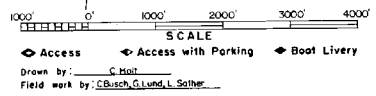

SPECIES OF FISH	1971	
	Survey	Present
Muskie	X	X
N. Pike	X	X
Walleye	X	X
N. M. Bass	X	X
S. M. Bass	X	X
Panfish	X	X
Trotl	X	X

WATER AREA 3226.8 ACRES  
 UNDER 3 FT. 11 %  
 OVER 20 FT. 35 %  
 MAX. DEPTH 51 FEET.  
 TOTAL ALK. 38 P.P.M.  
 VOLUME 52032 ACRE FT.  
 SHORELINE 43.62 MILES

Maps are not for navigation  
 Source-Wisconsin Department of Natural Resources  
 Hunt Fish Camp Wisconsin .Com 2005