

STATE OF WISCONSIN
DEPARTMENT OF NATURAL RESOURCES

LAKE SURVEY MAP

NAMEKAGON LAKE BAYFIELD COUNTY
SEC. AS SHOWN T. 43 N. R. 6 W.
SHEET 2 OF 3

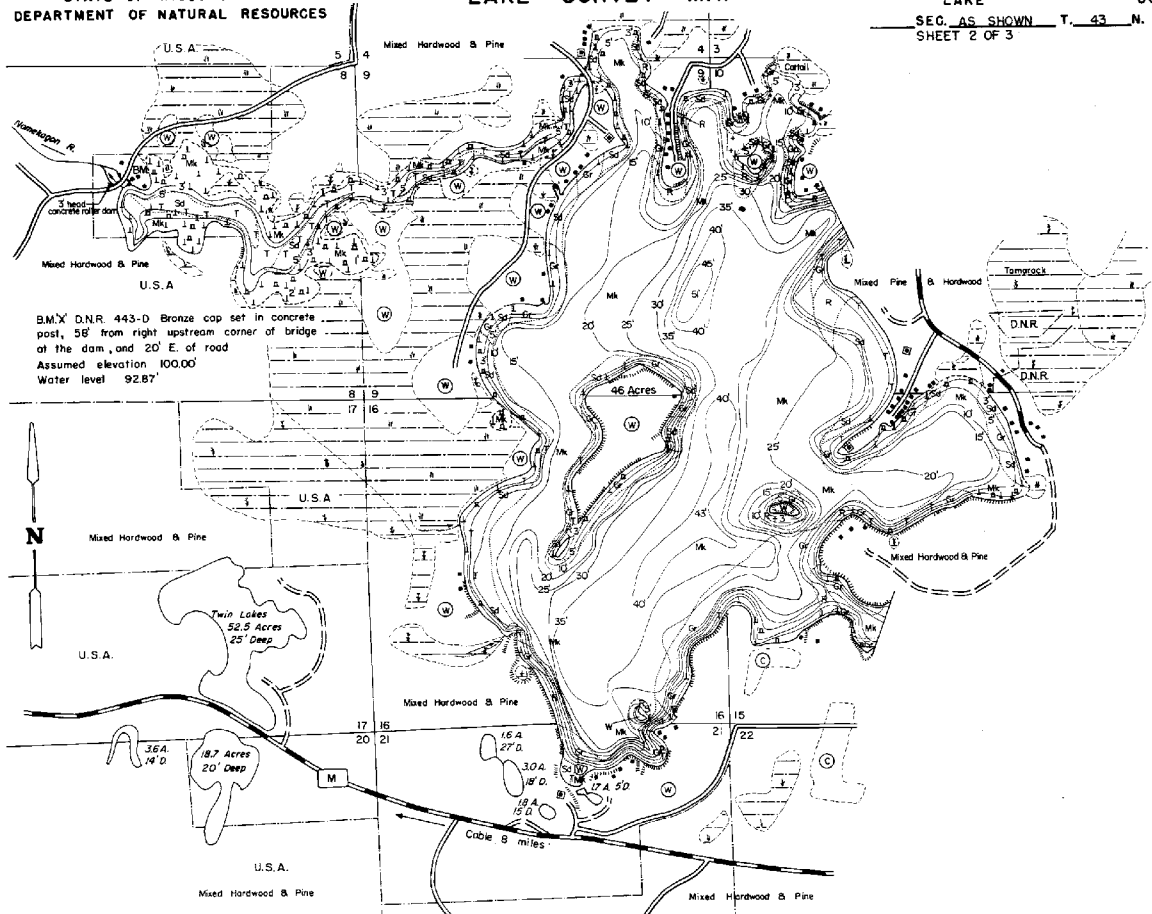

B.M. X D.N.R. 443-D Bronze cap set in concrete post, 56' from right upstream corner of bridge at the dam, and 20' E. of road
Assumed elevation 100.00'
Water level 92.87'

- EQUIPMENT RECORDING SONAR MAPPED SEPT 1971
- TOPOGRAPHIC SYMBOLS
- (S) Brush
 - (W) Partly wooded
 - (C) Cleared
 - (P) Pastured
 - (A) Agricultural
 - (B.M.) Bench Mark
 - (D) Dwelling
 - (R) Resort
 - (C) Camp
- LAKE BOTTOM SYMBOLS
- (S) Sleep slope
 - (I) Indefinite shoreline
 - (M) Marsh
 - (S) Spring
 - (I) Intermittent stream
 - (P) Permanent inlet
 - (P) Permanent outlet
 - (D) Dam
 - (D.N.R.) State owned land
- LAKE BOTTOM SYMBOLS
- (P) Peat
 - (Mk) Muck
 - (C) Clay
 - (M) Marl
 - (Sd) Sand
 - (Sl) Silt
 - (Gr) Gravel
 - (R) Rubble
 - (Bc) Bedrock
 - (B) Boulders
 - (S) Stumps & Snags
 - (R) Rock danger to navigation
 - (T) Subemergent vegetation
 - (E) Emergent vegetation
 - (F) Floating vegetation
 - (B) Brush shelters

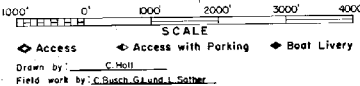

SPECIES OF FISH	1971		
	Abundant	Common	Present
Muskie	X	X	X
N Pike	X	X	X
Walleye	X	X	X
W-M Bass	X	X	X
S-M Bass	X	X	X
Rockfish	X	X	X
Trout	X	X	X

WATER AREA 3226.8 ACRES
UNDER 3 FT. 11 %
OVER 20 FT. 35 %
MAX. DEPTH 51 FEET.
TOTAL ALK. 38 P.P.M.
VOLUME 52032 ACRE FT.
SHORELINE 43.62 MILES

Maps are not for navigation
Source-Wisconsin Department of Natural Resources
Hunt Fish Camp Wisconsin .Com 2005