

STATE OF WISCONSIN  
DEPARTMENT OF NATURAL RESOURCES  
34/35

LAKE SURVEY MAP

MUD LAKE  
DANE COUNTY  
SEC. 2 T. 7 N. R. 12 E.

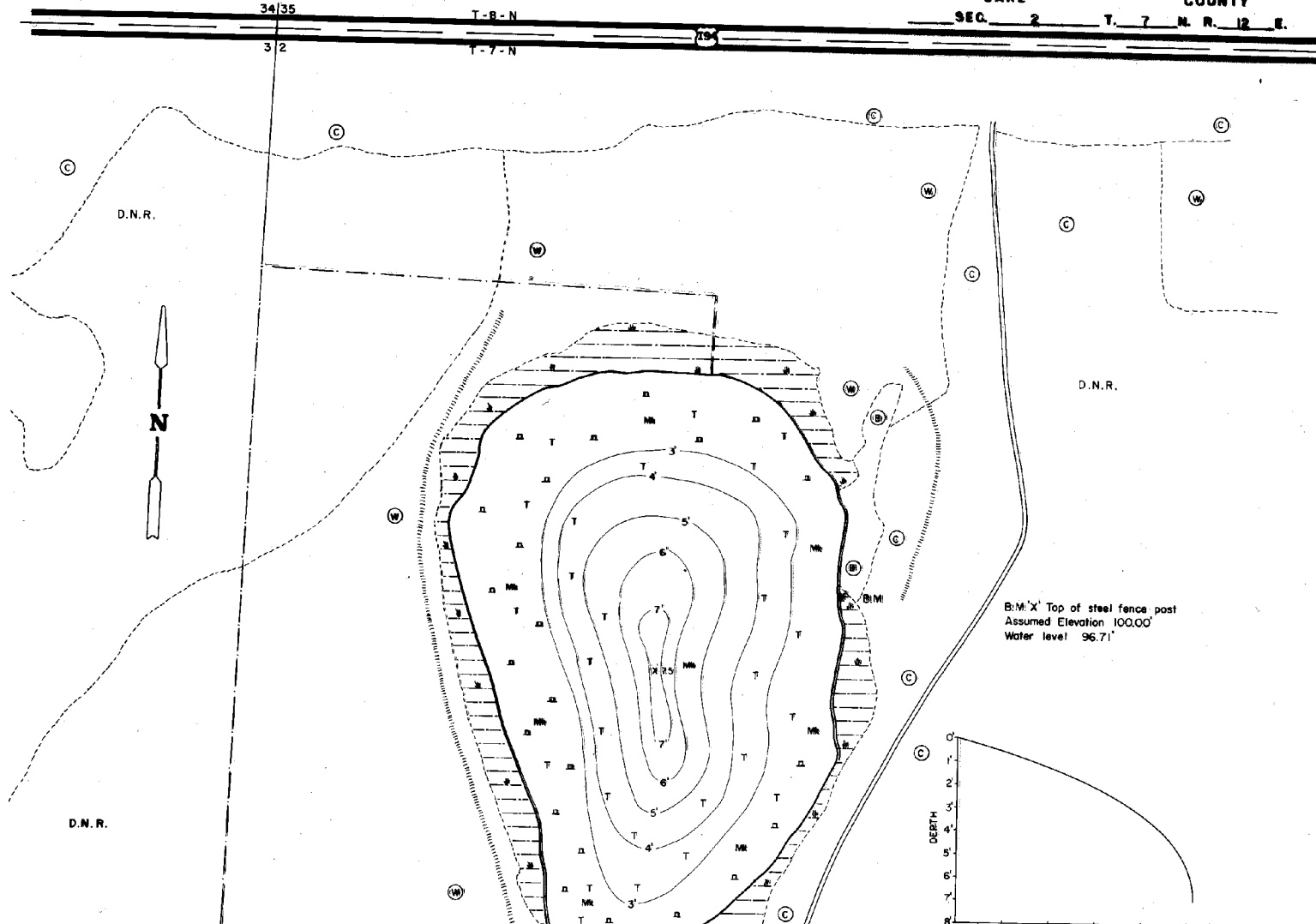

B.M. 'X' Top of steel fence post  
Assumed Elevation 100.00'  
Water level 96.71'

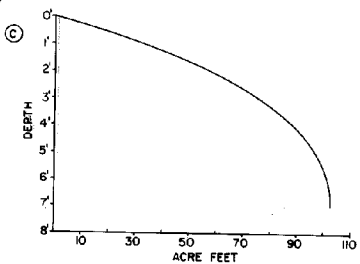

EQUIPMENT RECORDING SONAR MAPPED JULY 1970

- TOPOGRAPHIC SYMBOLS**
- (B) Brush
  - (PW) Partially wooded
  - (W) Wooded
  - (C) Cleared
  - (P) Pastured
  - (A) Agricultural
  - B.M. Bench Mark
  - Dwelling
  - Resort
  - Camp
- TOPOGRAPHIC SYMBOLS**
- (H) Steep slope
  - Indefinite shoreline
  - Marsh
  - Spring
  - Intermittent stream
  - Permanent inlet
  - Permanent outlet
  - Dam
  - D.N.R. State owned land

- LAKE BOTTOM SYMBOLS**
- P. Peat
  - MR. Muck
  - C. Clay
  - M. Marl
  - Sd. Sand
  - Sr. Silt
  - Gr. Gravel
  - R. Rubble
  - Bc. Bedrock

- LAKE BOTTOM SYMBOLS**
- B. Boulders
  - S Stumps & Snags
  - Rock danger to navigation
  - Submergent vegetation
  - Emergent vegetation
  - Floating vegetation
  - Brush shelters

200' 0 200' 400' 600' 800'

SCALE

Access Access with Parking Boat Livery

Drawn by: C. Hale  
Field work by: M. Green, J. Blaine

SPECIES OF FISH	
NUMBER	PERCENT
Bluegill	
Crappie	
Walleye	
Yellow perch	
Smallmouth bass	
Rock bass	
White sucker	
Common carp	
Golden shiner	
Trout	
Forage	

WATER AREA 344 ACRES  
UNDER 3 FT. 90 %  
OVER 20 FT. 0 %  
MAX. DEPTH 7.5 FEET  
TOTAL ALK. 2000 P.P.M.  
VOLUME 1000 AC FT.  
SHORELINE 0.5 MILES

Maps are not for navigation  
Source-Wisconsin Department of Natural Resources  
Hunt Fish Camp Wisconsin .Com 2005