

STATE OF WISCONSIN  
DEPARTMENT OF NATURAL RESOURCES

LAKE SURVEY MAP

MOSHAWQUIT LAKE  
MENOMINEE COUNTY  
SEC. 13, 24 T. 28 N. R. 16 E.

B.M.'X' 2" square cut on E. corner of  
cement support of dam.  
Assumed elevation 100.00'  
Water level 99.29'

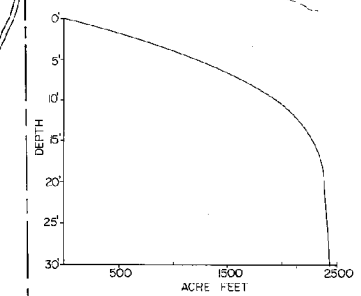
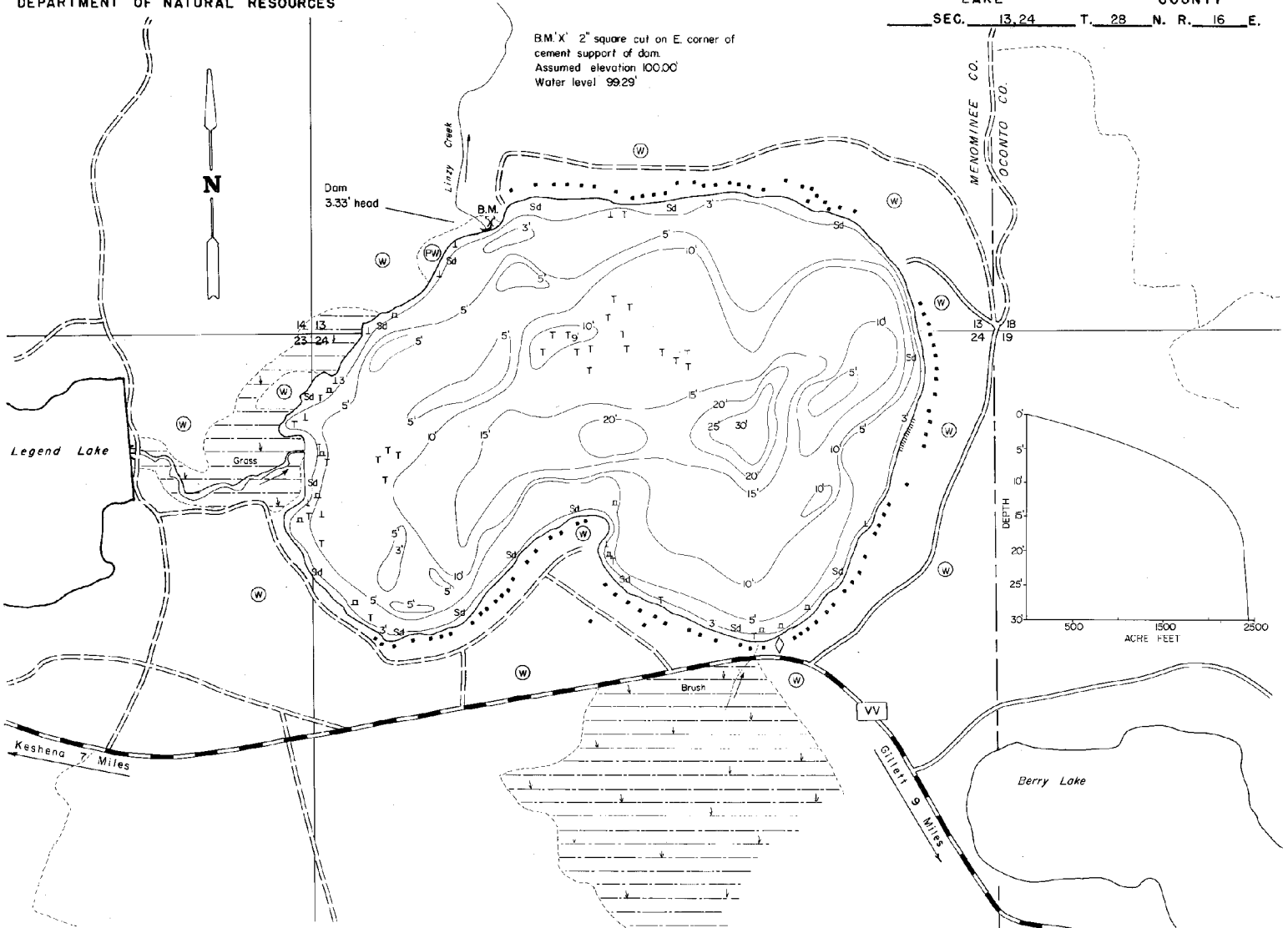

- EQUIPMENT RECORDING SONAR MAPPED JULY 1969
- | TOPOGRAPHIC SYMBOLS |                            | LAKE BOTTOM SYMBOLS |                           |
|---------------------|----------------------------|---------------------|---------------------------|
| (B) Brush           | (H) Steep slope            | P. Peat             | B Boulders                |
| (PW) Partly wooded  | (---) Indefinite shoreline | Mk. Muck            | Stumps & Snags            |
| (W) Wooded          | (M) Marsh                  | C. Clay             | Rock danger to navigation |
| (C) Cleared         | (S) Spring                 | M. Marl             | T Submergent vegetation   |
| (P) Pastured        | (IS) Intermittent stream   | Sd. Sand            | I Emergent vegetation     |
| (A) Agricultural    | (PI) Permanent inlet       | Sl. Silt            | F Floating vegetation     |
| B.M. Bench Mark     | (PO) Permanent outlet      | G. Gravel           | Brush shelters            |
| (D) Dwelling        | (D) Dam                    | R. Rubble           |                           |
| (R) Resort          | (D.N.R.) State owned land  | Bc Bedrock          |                           |
| (C) Camp            |                            |                     |                           |

500' 0' 500' 1000' 1500' 2000'

SCALE

◆ Access    ◆ Access with Parking    ◆ Boat Livery

Drawn by: C. Hall  
Field work by: J. Smith

SPECIES OF FISH	ABUNDANCE	
	Common	Present
Muskie		
N. Pike	X	X
Walleye	X	X
I. M. Bass	X	X
S. M. Bass	X	X
Panfish	X	X
Trout		

WATER AREA 2644 ACRES  
UNDER 3 FT. 6.3 %  
OVER 20 FT. 3.5 %  
MAX. DEPTH 30 FEET.  
TOTAL ALK. 78 P.P.M.  
VOLUME 24316 ACRE FT.  
SHORELINE 2.74 MILES

Maps are not for navigation  
Source-Wisconsin Department of Natural Resources  
Hunt Fish Camp Wisconsin .Com 2005