

WISCONSIN CONSERVATION DEPARTMENT

LAKE SURVEY MAP

LAKE LOST
 SECTIONS 3, 9, 10
 TOWNSHIP T-40-N
 RANGE R-8-E
 TOWN ST. GERMAIN
 COUNTY VILAS

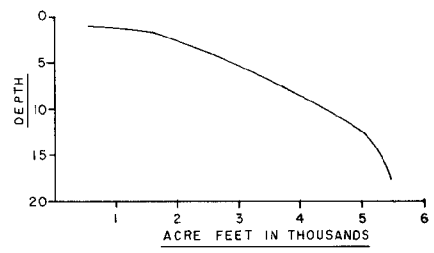
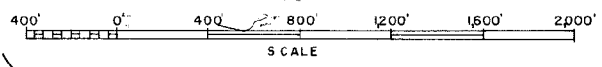

4 MILES TO SAYNER

B.M. "X" 870-A BRASS CAP ON SOUTH
 END OF RIGHT WING OF DAM
 ELEV. 97.94'
 WATER ELEV. 92.27'

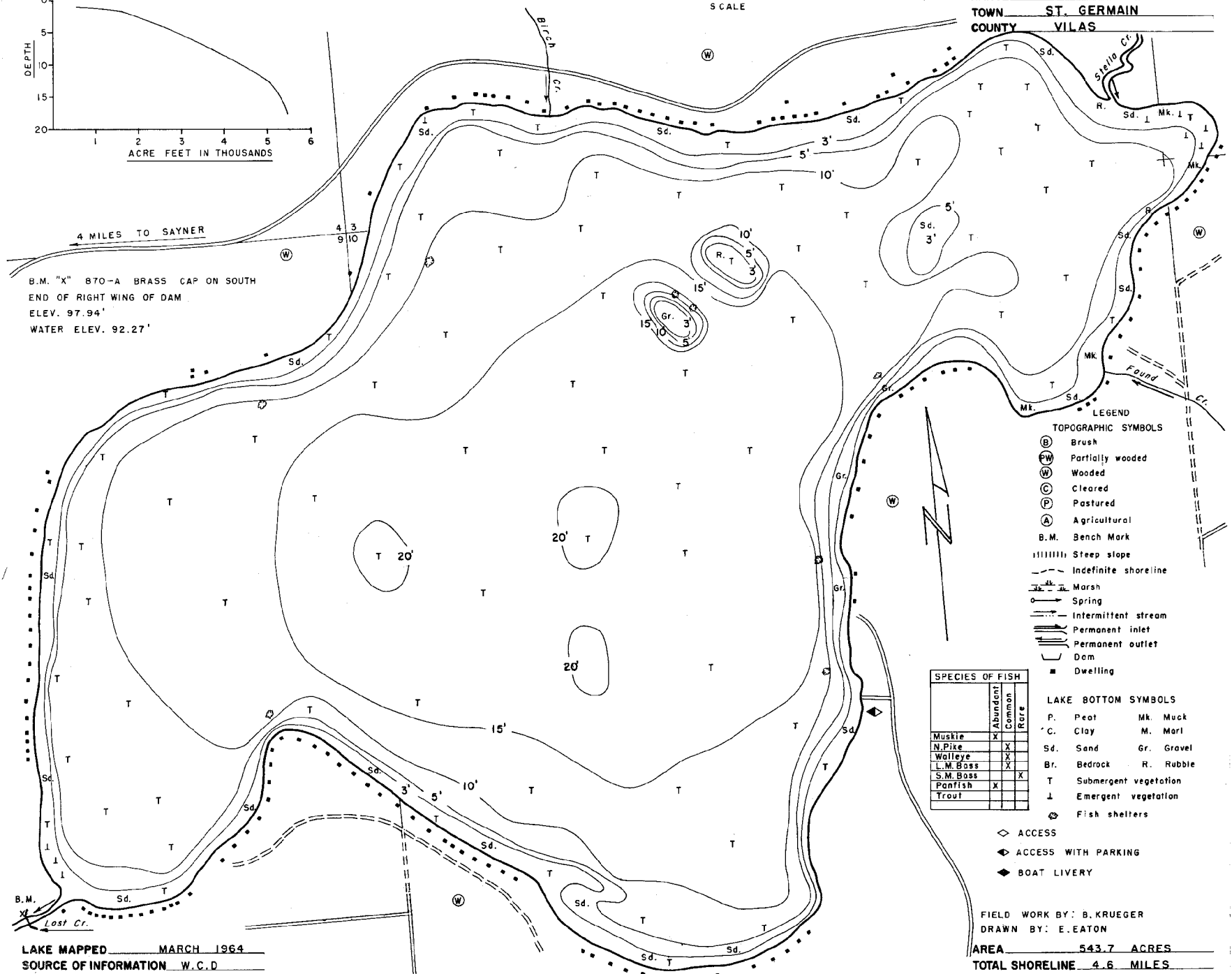

LEGEND

TOPOGRAPHIC SYMBOLS

- (B) Brush
- (PW) Partially wooded
- (W) Wooded
- (C) Cleared
- (P) Pastured
- (A) Agricultural
- B.M. Bench Mark
- ||||| Steep slope
- - - Indefinite shoreline
- ||||| Marsh
- o Spring
- - - Intermittent stream
- ==== Permanent inlet
- ==== Permanent outlet
- Dam
- Dwelling

SPECIES OF FISH	ABUNDANCE		
	Abundant	Common	Rare
Muskie	X		
N. Pike	X		
Walleye	X		
L.M. Bass	X		
S.M. Bass		X	
Panfish	X		
Trout			

LAKE BOTTOM SYMBOLS

- P. Peat
- C. Clay
- Sd. Sand
- Br. Bedrock
- T. Submergent vegetation
- ↓ Emergent vegetation
- ☉ Fish shelters
- Mk. Muck
- M. Marl
- Gr. Gravel
- R. Rubble

- ◇ ACCESS
- ◇ ACCESS WITH PARKING
- ◇ BOAT LIVERY

FIELD WORK BY: B. KRUEGER
 DRAWN BY: E. EATON

AREA 543.7 ACRES

TOTAL SHORELINE 4.6 MILES

MAX DEPTH 20 FEET

LAKE MAPPED MARCH 1964

SOURCE OF INFORMATION W.C.D

BOUNDARIES SHOWN THROUGH ICE