

STATE OF WISCONSIN
DEPARTMENT OF NATURAL RESOURCES

LAKE SURVEY MAP

LONG SHAWANO
LAKE COUNTY
SEC. 26.27 T. -26- N. R. -15- E.

Department of Natural Resources Bench Mark.
Top of 1" steel pipe approximately 6' from water's edge.
Assumed Elevation 100.00'
Water Elevation 95.70'

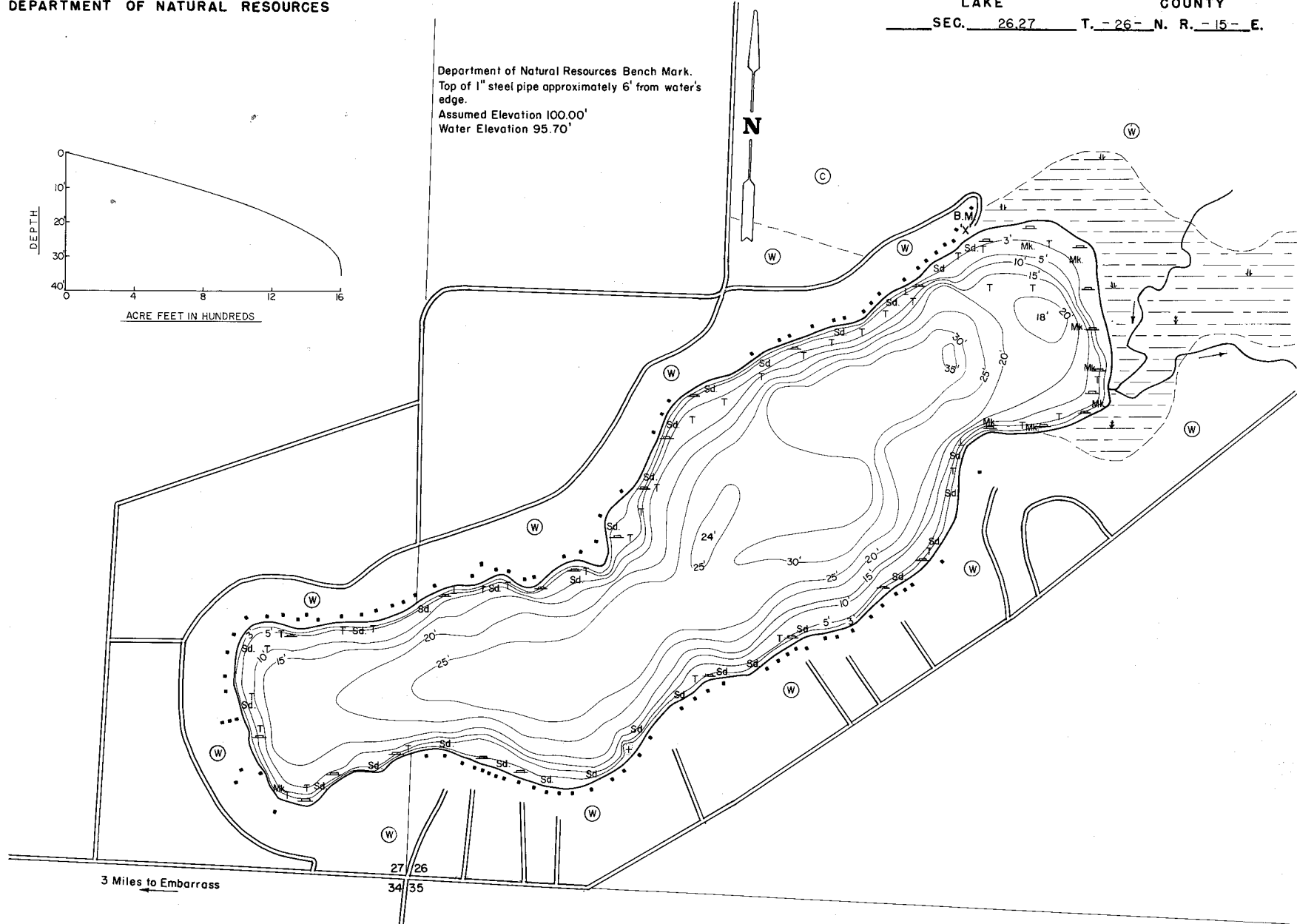
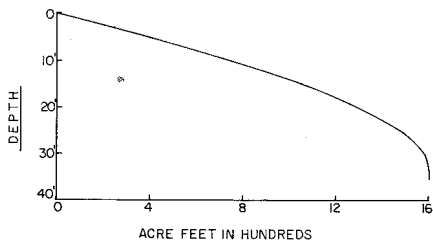

3 Miles to Embarrass

27/26
34/35

EQUIPMENT RECORDING SONAR MAPPED JULY 1969
MONTH YEAR

- | TOPOGRAPHIC SYMBOLS | | LAKE BOTTOM SYMBOLS | |
|-----------------------|------------------------|---------------------|-----------------------------|
| (B) Brush | Steep slope | P. Peat | B Boulders |
| (PW) Partially wooded | ~ Indefinite shoreline | Mk. Muck | ☼ Stumps & Snags |
| (W) Wooded | ~ Marsh | C. Clay | ☼ Rock danger to navigation |
| (C) Cleared | ~ Spring | M. Marl | T Submergent vegetation |
| (P) Pastured | ~ Intermittent stream | Sd. Sand | ↑ Emergent vegetation |
| (A) Agricultural | ~ Permanent inlet | St. Silt | ~ Floating vegetation |
| B.M. Bench Mark | ~ Permanent outlet | Gr. Gravel | ☼ Brush shelters |
| ■ Dwelling | ~ Dam | R. Rubble | |

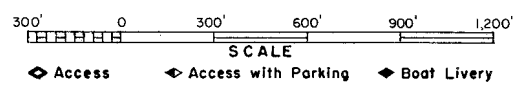

SPECIES OF FISH	ABUNDANCE	
	Abundant	Common
Muskie		
N. Pike	X	
Wolleye		X
L.M. Bass	X	
S.M. Bass		
Panfish	X	

WATER AREA 85.6 ACRES
 UNDER 3 FT. 7 %
 OVER 20 FT. 49 %
 MAX. DEPTH 35 FEET.
 TOTAL ALK. 122 P.P.M.
 VOLUME 1,600.7 ACRE FT.
 SHORELINE 20 MILES