

STATE OF WISCONSIN  
DEPARTMENT OF NATURAL RESOURCES

LAKE SURVEY MAP

LONG LAKE CHIPPewa COUNTY  
SEC. 8, 17, 18, 19, 20 T. 32 - N. R. 8, 9 - E. W. 13, 24 (Sheet 1 of 2)

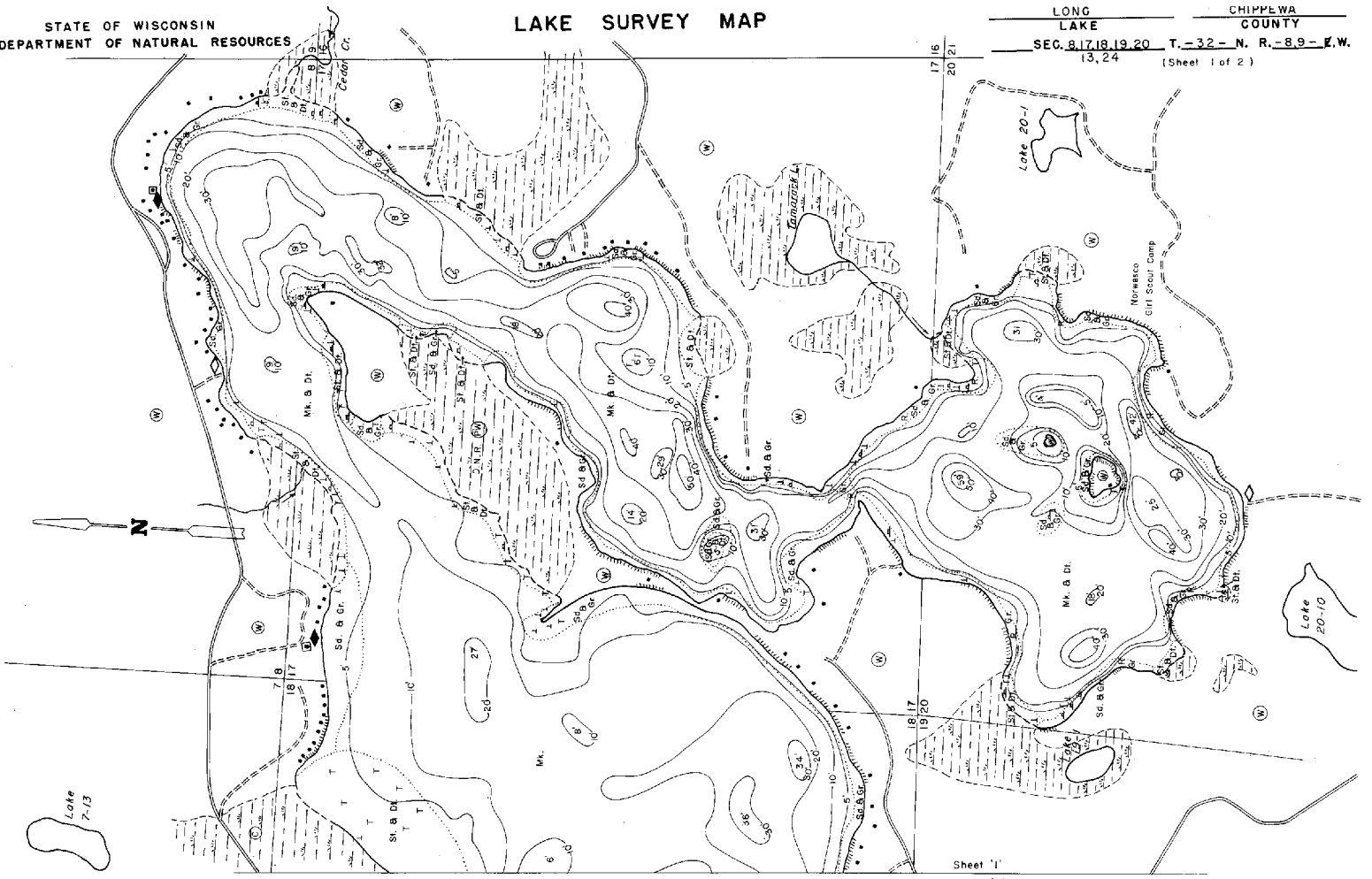

- EQUIPMENT SONAR & POLE MAPPED JULY 1974
- | TOPOGRAPHIC SYMBOLS   |                               | LAKE BOTTOM SYMBOLS |                              |
|-----------------------|-------------------------------|---------------------|------------------------------|
| (B) Brush             | (     ) Steep slope           | P. Peat             | B. Boulders                  |
| (PW) Partially wooded | (---) Indefinite shoreline    | Mk. Muck            | S. Stumps & Snags            |
| (W) Wooded            | (---) Marsh                   | C. Clay             | RD Rock danger to navigation |
| (C) Cleared           | (---) Spring                  | M. Marl             | T. Submergent vegetation     |
| (P) Pastured          | (---) Intermittent stream     | Sd. Sand            | E. Emergent vegetation       |
| (A) Agricultural      | (---) Permanent inlet         | Sl. Silt            | F. Floating vegetation       |
| B.M. Birch Mark       | (---) Permanent outlet        | Gr. Gravel          | BS Brush shelters            |
| (D) Dwelling          | (---) Dam                     | R. Rubble           | Dt Detritus                  |
| (R) Resort            | (---) D.N.R. State owned land | Br. Bedrock         |                              |
| (C) Camp              |                               |                     |                              |

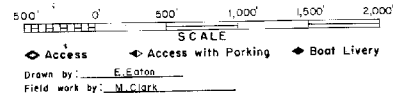

SPECIES OF FISH

	ABUNDANT	COMMON	SCARCELY
Muskie			
N. Pike	X		
Walleye	X		
S. W. Bass	X		
S. W. Bass	X		
Panfish	X		
Trout			

WATER AREA 1,052.2 ACRES  
 UNDER 3 FT. 11 %  
 OVER 20 FT. 29 %  
 MAX. DEPTH 101 FEET  
 TOTAL ALK. 42 P.P.M.  
 VOLUME 21,489.9 ACRE FT.  
 MAIN SHORELINE 1.68 MI.  
 ISLAND SHORELINE 2.31 MI.

Maps are not for navigation  
 Source-Wisconsin Department of Natural Resources  
 Hunt Fish Camp Wisconsin .Com 2005