

WISCONSIN CONSERVATION DEPARTMENT

LAKE SURVEY MAP

LITTLE BUTTERNUT LAKE
POLK COUNTY
SEC. 29.32 T. 36 N. R. 17 W.

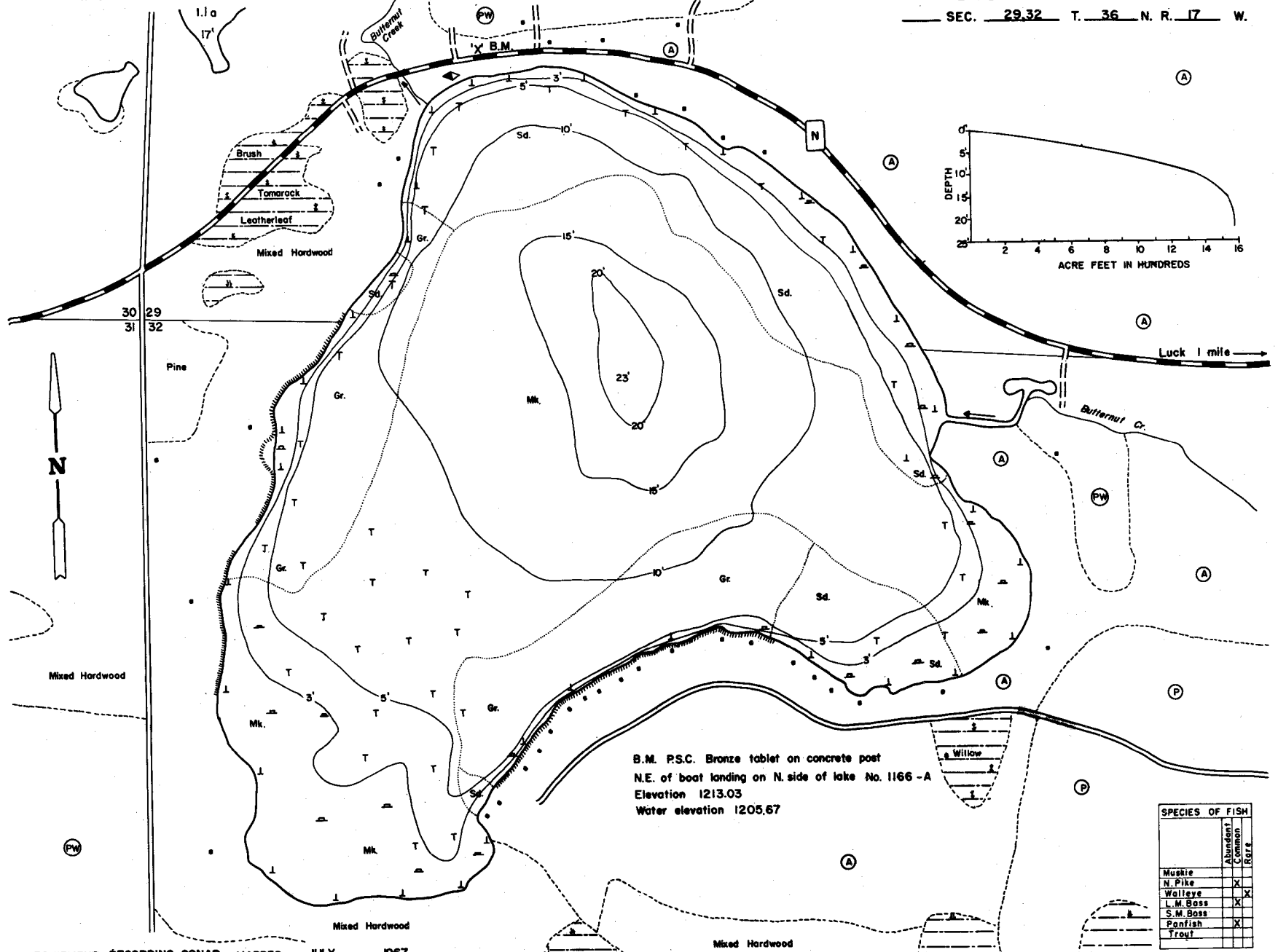

B.M. P.S.C. Bronze tablet on concrete post
N.E. of boat landing on N. side of lake No. 1166 - A
Elevation 1213.03
Water elevation 1205.67

SPECIES OF FISH	Abundance	
	Common	Rare
Muskie		
N. Pike	X	
Walleye	X	X
L.M. Bass	X	
S.M. Bass		
Panfish	X	
Trot?		

EQUIPMENT RECORDING SONAR MAPPED JULY 1967
MO. YR.

- TOPOGRAPHIC SYMBOLS
- (B) Brush
 - (PW) Partly wooded
 - (W) Woded
 - (C) Cleared
 - (P) Pastured
 - (A) Agricultural
 - B.M. Bench Mark
 - (|||||) Steep slope
 - (---) Indefinite shoreline
 - (---) Marsh
 - (---) Spring
 - (---) Intermittent stream
 - (---) Permanent inlet
 - (---) Permanent outlet

- LAKE BOTTOM SYMBOLS
- P. Peat
 - Gr. Gravel & Stumps & Snags
 - R. Rubble
 - Br. Bedrock
 - C. Clay
 - M. Muri
 - T Submergent vegetation



AREA 189.3 ACRES
UNDER 3 FT. 14.6 %
OVER 20 FT. 1.6 %
VOLUME 1580.6 ACRE FT.
TOTAL ALK. 66 P.P.M.
SHORELINE 2.4 MILES
MAX. DEPTH 23 FEET

- ◇ Access
- ◇ Access with Parking
- ◇ Boat Livery