

STATE OF WISCONSIN
DEPARTMENT OF NATURAL RESOURCES

LAKE SURVEY MAP

LILLY LAKE KENOSHA COUNTY
SEC. 11 T. 1 N. R. 19 E.

B.M. 1242 - A square cut in south end of concrete wall between town road and public beach 31' west of shore & 330' north of public access
Elevation 761.31'
Water Level 757.40'

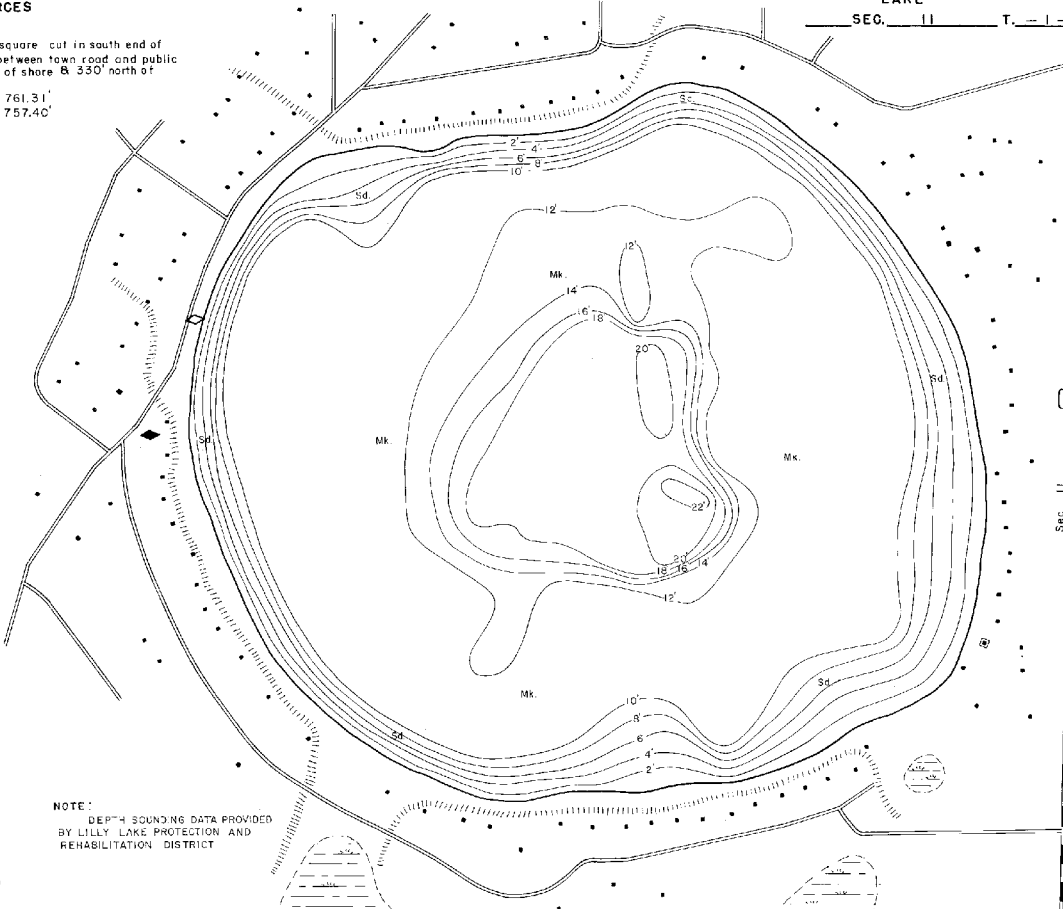
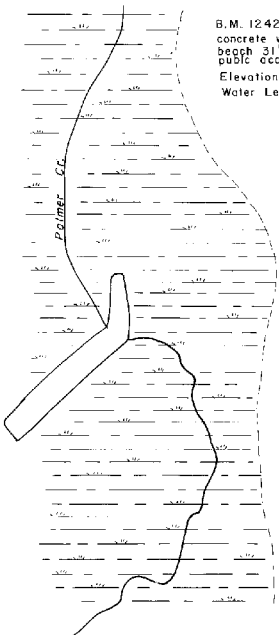

Sec. 11
Sec. 12
New Munster 2 MI

NOTE: DEPTH SOUNDING DATA PROVIDED BY LILLY LAKE PROTECTION AND REHABILITATION DISTRICT

EQUIPMENT MAPPED SEPTEMBER 1979

| TOPOGRAPHIC SYMBOLS | LAKE BOTTOM SYMBOLS |
|---------------------|------------------------------|
| Brush | P. Pear |
| partially wooded | Mk. Muck |
| Wooded | C. Clay |
| Cleared | M. Marl |
| Postured | Sd. Sand |
| Agricultural | St. Silt |
| B.M. Bench Mark | Gr. Gravel |
| Dwelling | R. Rubble |
| Resort | Bc. Bedrock |
| Comp | |
| | B. Boulders |
| | S. Stumps & Snags |
| | R. Rock danger to navigation |
| | S. Submergent vegetation |
| | F. Floating vegetation |
| | BS. Brush shelters |

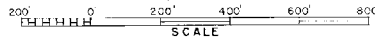

Access Access with Parking Boat Livery
Drawn by: E. Eaton
Field work by: P. Johnson

| SPECIES OF FISH | Abundant | Common | Present |
|-----------------|----------|--------|---------|
| Muskie | | | |
| N. Pike | | | |
| Walleye | | | |
| S.M. Bass | | | |
| Panfish | | | |
| Trout | | | |

WATER AREA 84.6 ACRES
UNDER 3 FT. 8 %
OVER 20 FT. 2 %
MAX. DEPTH 22 FEET.
TOTAL ALK. 123 P.P.M.
VOLUME 920.4 ACRE FT.
MAIN SHORELINE 1.33 MI.
ISLAND SHORELINE MI.

Maps are not for navigation
Source-Wisconsin Department of Natural Resources
Hunt Fish Camp Wisconsin .Com 2005