

STATE OF WISCONSIN
DEPARTMENT OF NATURAL RESOURCES

LAKE SURVEY MAP

LEE LAKE
JACKSON COUNTY
SEC. 20, 29 T. - 20 - N. R. - 2 - W.

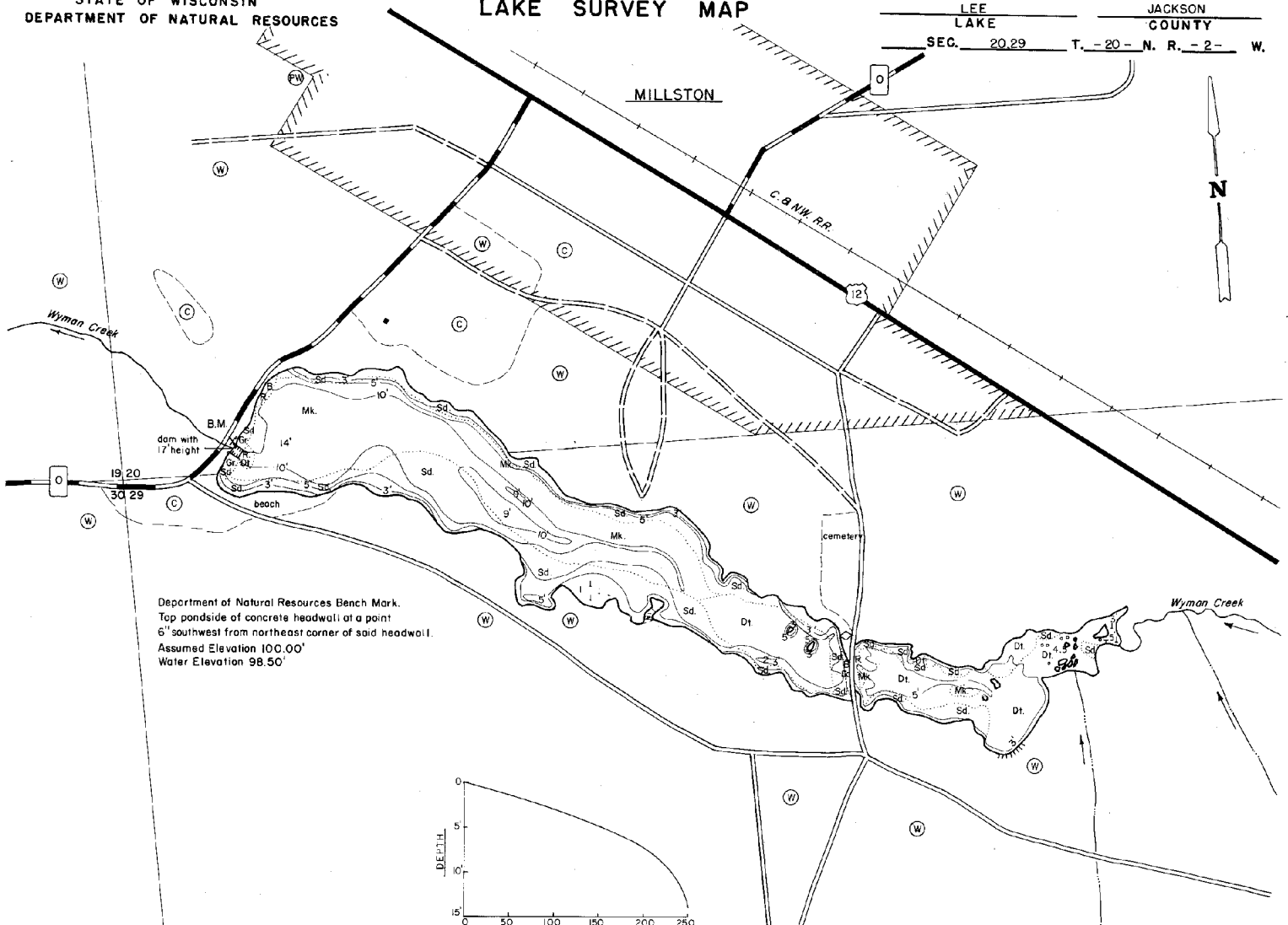

Department of Natural Resources Bench Mark.
Top pondside of concrete headwall at a point
6" southwest from northeast corner of said headwall.
Assumed Elevation 100.00'
Water Elevation 98.50'

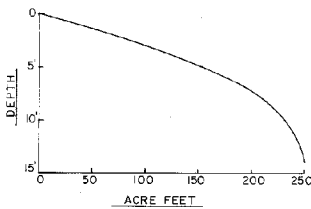

EQUIPMENT	RANGE	POLE	SONAR	MAPPED	MONTH	YEAR
					MAY	1969
TOPOGRAPHIC SYMBOLS						
(B)	Brush	()	Steep slope	P.	Peat	B
PW	Partially wooded	(---)	Indefinite shoreline	Mk.	Muck	**
(W)	Wooded	(---)	Marsh	C.	Clay	⚠
(C)	Cleared	(---)	Spring	M.	Marl	T
(P)	Pastured	(---)	Intermittent stream	Sd.	Sand	⌈
(A)	Agricultural	(---)	Permanent inlet	Sl.	Silt	⌋
B.M.	Bench Mark	(---)	Permanent outlet	Gc.	Gravel	⌋
(D)	Dwelling	(---)	Dam	R.	Rubble	⌋
(R)	Resort	(---)	D.N.R. State owned land	Bc	Bedrock	⌋
(C)	Camp	(---)		Dt.	Detritus	⌋
						⌋

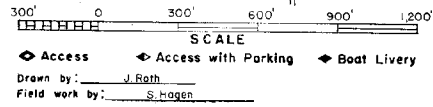

SPECIES OF FISH	1969	
	Abundant	Common
Muskie		
N. Pike		
Walleye		
L.M. Bass	X	
S.M. Bass	X	
Perch	X	
Trout	X	

WATER AREA 36.7 ACRES
UNDER 3 FT. 17 %
OVER 20 FT. 0 %
MAX. DEPTH 14 FEET.
TOTAL ALK. 8 P.P.M.
VOLUME 250.1 ACRE FT.
SHORELINE 2.11 MILES
2.05 MILES OF SHORELINE
EXCLUDING ISLANDS

Maps are not for navigation
Source-Wisconsin Department of Natural Resources
Hunt Fish Camp Wisconsin .Com 2005