

WISCONSIN CONSERVATION DEPARTMENT

LAKE SURVEY MAP

LAUDERDALE CHAIN LAKE

WALWORTH COUNTY

SEC. 25, 26, 34 T. 4 - N. R. 16 - E. # 35, 36

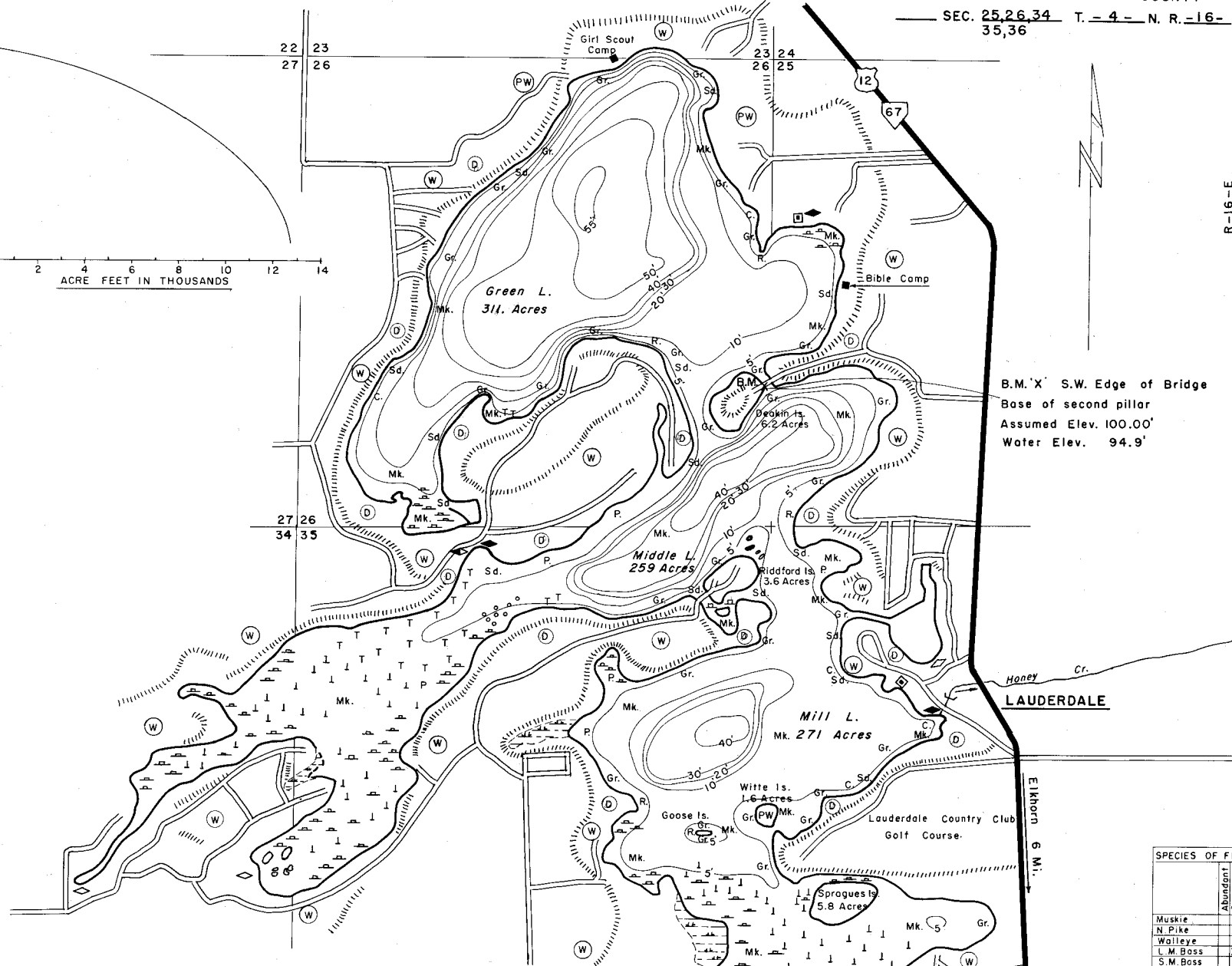
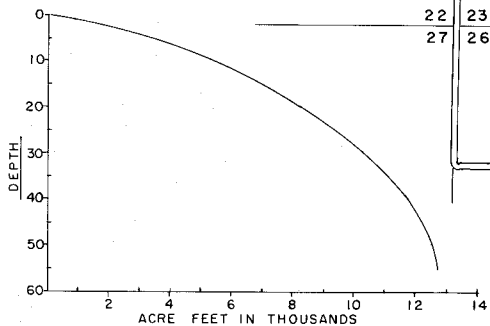

B.M. 'X' S.W. Edge of Bridge  
Base of second pillar  
Assumed Elev. 100.00'  
Water Elev. 94.9'

R-16-E  
R-17-E

EQUIPMENT ECHO SOUNDER MAPPED JULY 1966

TOPOGRAPHIC SYMBOLS MO. YR.

- (B) Brush
- (PW) Partially wooded
- (W) Wooded
- (C) Cleared
- (P) Pastured
- (A) Agricultural
- B.M. Bench Mark
- Steep slope
- Indefinite shoreline
- Marsh
- Spring
- Intermittent stream
- Permanent inlet
- Permanent outlet
- P. Peat
- Gr. Gravel
- Mk. Muck
- R. Rubble
- Br. Bedrock
- T. Submergent vegetation
- Emergent vegetation

WATER ELEV. 94.9'

LAKE BOTTOM SYMBOLS

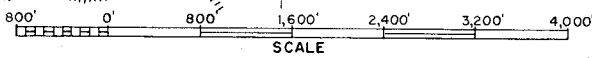

- ◇ Access
- ◆ Access with Parking
- ◆ Boat Livery

LAUDERDALE

Elkhorn 6 Mi.

SPECIES OF FISH		
	Abundant	Rare
Muskie		
N. Pike	X	
Walleye	X	
L. M. Boss	X	
S. M. Boss	X	
Panfish	X	
Trout		

Sec. 36  
Sec. 1  
AREA 841.6 WITH ISLANDS  
834.2 ACRES  
UNDER 3FT. 21 %  
OVER 20FT. 27 %  
VOLUME 12,591 ACRE FT.  
TOTAL ALK. 177 P.P.M.  
SHORELINE 16 MILES