

STATE OF WISCONSIN
DEPARTMENT OF NATURAL RESOURCES

LAKE SURVEY MAP

LARGON LAKE
POLK COUNTY
SEC. 10,11,14,15 T. 36 N. R. 15 E.W.

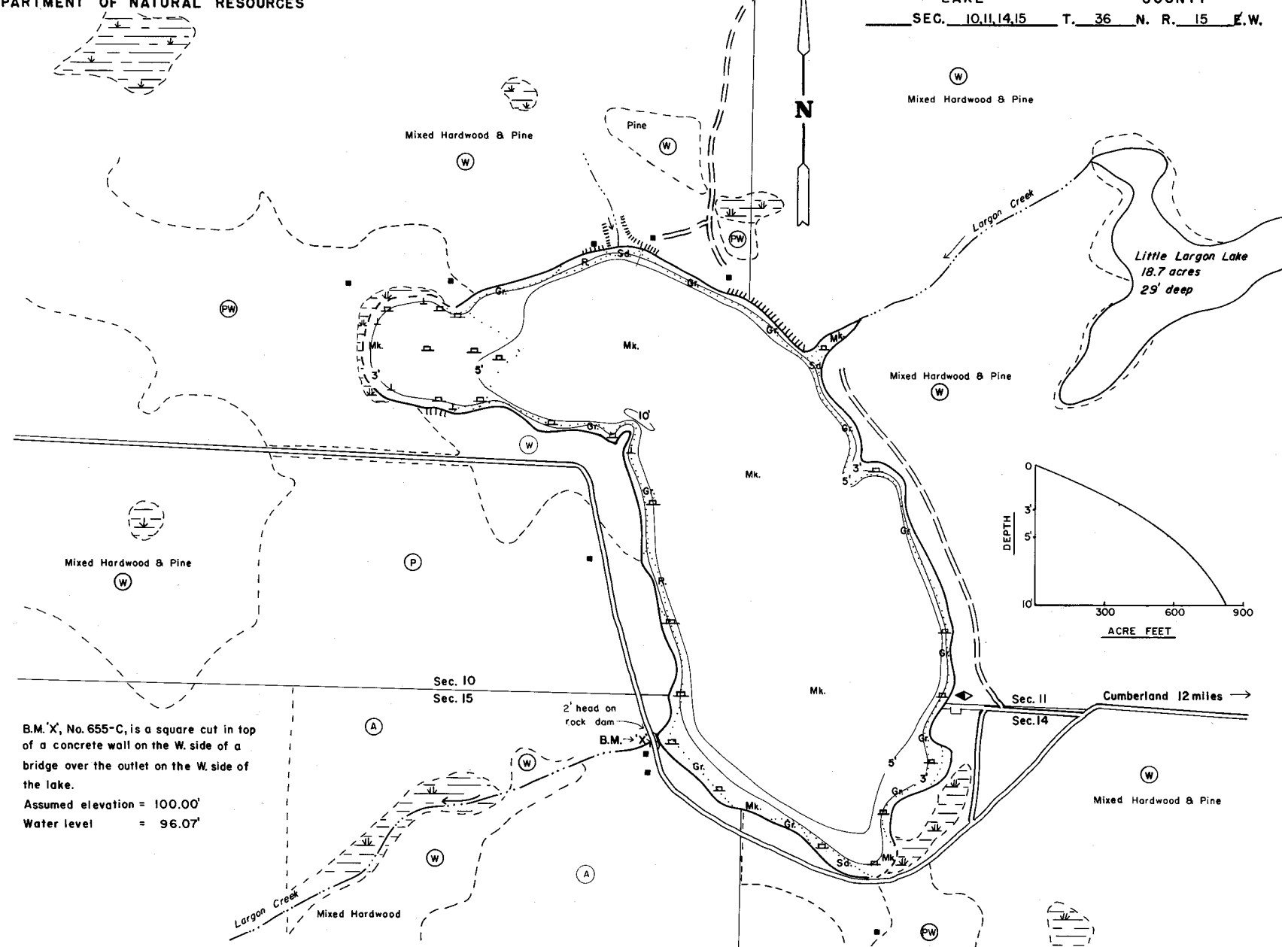

B.M. 'X', No. 655-C, is a square cut in top of a concrete wall on the W. side of a bridge over the outlet on the W. side of the lake.

Assumed elevation = 100.00'
Water level = 96.07'

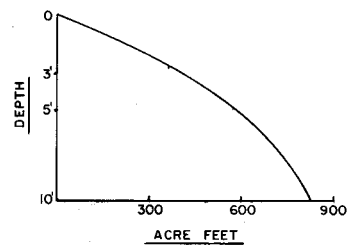

EQUIPMENT RECORDING SONAR MAPPED JULY 1969

TOPOGRAPHIC SYMBOLS		LAKE BOTTOM SYMBOLS	
(B) Brush	Steep slope	P. Peat	B Boulders
(PW) Partially wooded	~ Indefinite shoreline	Mk. Muck	⊙ Stumps & Snags
(W) Wooded	~ Marsh	C. Clay	⊙ Rock danger to navigation
(C) Cleared	~ Spring	M. Marl	T Submergent vegetation
(P) Pastured	~ Intermittent stream	Sd. Sand	J Emergent vegetation
(A) Agricultural	~ Permanent inlet	Sl. Silt	F Floating vegetation
B.M. Bench Mark	~ Permanent outlet	Gr. Gravel	⊙ Brush shelters
■ Dwelling	~ Dam	R. Rubble	



◆ Access ◆ Access with Parking ◆ Boat Livery
Drawn by: T. Ginder

SPECIES OF FISH	ABUNDANCE	
	Abundant	Common
Muskie		
N. Pike		X
Walleye		X
L.M. Boss		X
S.M. Boss		X
Panfish		X

WATER AREA 129.2 ACRES
UNDER 3 FT. 9.6 %
OVER 20 FT. 0 %
MAX. DEPTH 10 FEET.
TOTAL ALK. 13 P.P.M.
VOLUME 826.5 ACRE FT.
SHORELINE 2.34 MILES