

STATE OF WISCONSIN
DEPARTMENT OF NATURAL RESOURCES

LAKE SURVEY MAP

RIPLEY LAKE
JEFFERSON COUNTY
SEC. 7-8 T. 6- N. R. -13- E. 33

B.M. 'X' 1344 - A is a 1" X cut in top of gate hitching post, 2' above ground at access on south side of lake & north end of Scout camp
Assumed Elev. 100.00'
Water Elev. 93.70'

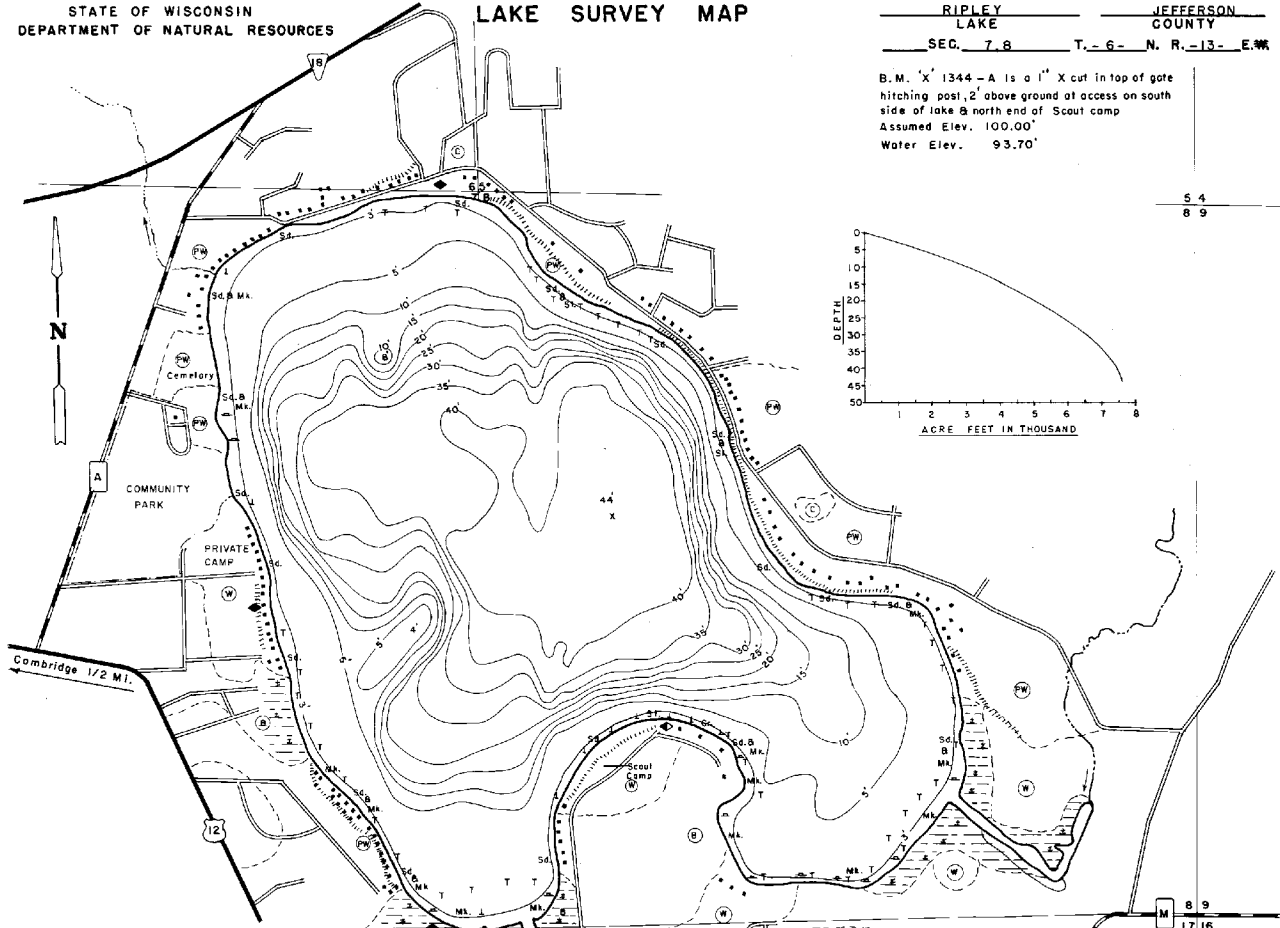

- EQUIPMENT RECORDING SONAR MAPPED AUGUST 1970
- TOPOGRAPHIC SYMBOLS**
- ⊙ Brush
 - ⊙ Partially wooded
 - ⊙ Wooded
 - ⊙ Cleared
 - ⊙ Pastured
 - ⊙ Agricultural
 - B.M. Bench Mark
 - Dwelling
 - ⊙ Resort
 - ⊙ Camp
- LAKE BOTTOM SYMBOLS**
- ⊙ Steep slope
 - ⊙ Indefinite shoreline
 - ⊙ Marsh
 - ⊙ Spring
 - ⊙ Intermittent stream
 - ⊙ Permanent inlet
 - ⊙ Permanent outlet
 - ⊙ Dam
 - ⊙ D.N.R. State owned land
- 1970 YEAR**
- P. Peat
 - Mx. Muck
 - C. Clay
 - M. Marl
 - Sd. Sand
 - Sl. Silt
 - G. Gravel
 - R. Rubble
 - Bc. Bedrock
- LAKE BOTTOM SYMBOLS**
- B. Boulders
 - ⊙ Stumps & Snags
 - ⊙ Rock damper to navigation
 - T. Submergent vegetation
 - ⊙ Emergent vegetation
 - ⊙ Floating vegetation
 - ⊙ Brush shelters

SCALE
0 500' 1000' 1500' 2000'

◆ Access ◆ Access with Parking ◆ Boat Livery

Drawn by E. Eaton
Field work by M. Cannon, J. Robben

SPECIES OF FISH

Species	Abundant	Common	Present
Walleye		X	
W. Pike		X	
Wolleye		X	
L. M. Bass		X	
S. M. Bass			
Perch	X		
Trout			

WATER AREA 418.1 ACRES
UNDER 3 FT. 8. %
OVER 20 FT. 41. %
MAX. DEPTH 44 FEET.
TOTAL ALK. 22.0 P.P.M.
VOLUME 7,561.2 ACRE FT.
SHORELINE 4.85 MILES
WITHOUT IS. 4.56 MILES

Maps are not for navigation
Source-Wisconsin Department of Natural Resources
Hunt Fish Camp Wisconsin .Com 2005