

WISCONSIN CONSERVATION DEPARTMENT

LAKE SURVEY MAP

KORTH & BAHR LAKE SHAWANO COUNTY
 SEC. 9 T. 27 N. R. 17 E.W.

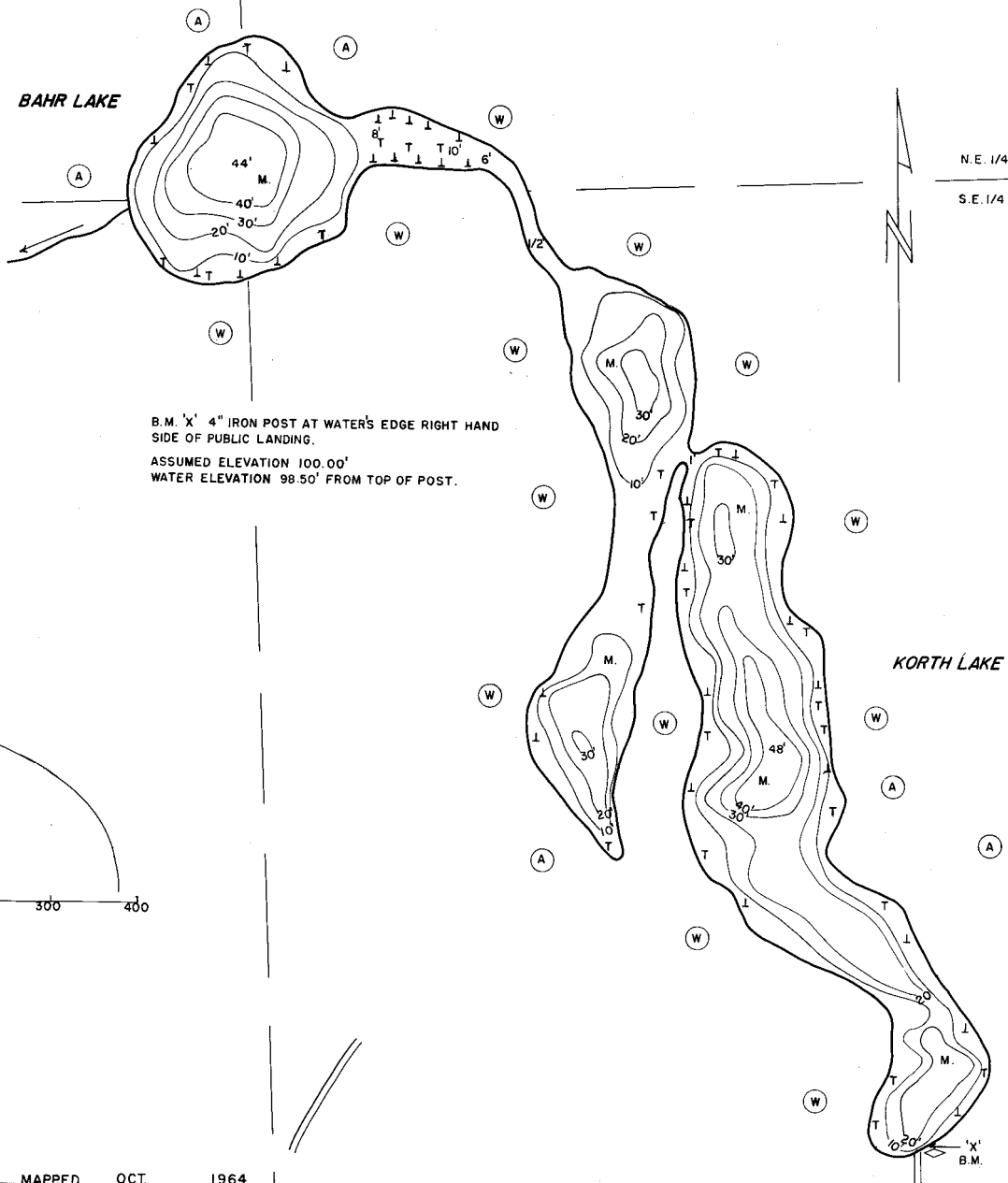

B.M. 'X' 4" IRON POST AT WATER'S EDGE RIGHT HAND SIDE OF PUBLIC LANDING.
 ASSUMED ELEVATION 100.00'
 WATER ELEVATION 98.50' FROM TOP OF POST.

N.E. 1/4 SEC. 9
 S.E. 1/4 SEC. 9

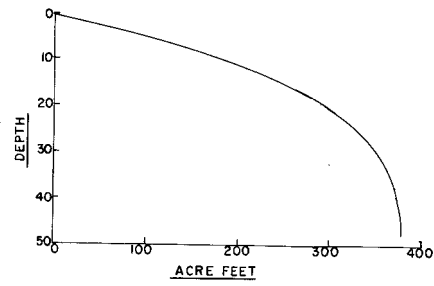

EQUIPMENT RECORDING SONAR MAPPED OCT 1964
 MO. YR.

- TOPOGRAPHIC SYMBOLS
- (B) Brush
 - (PW) Partially wooded
 - (W) Wooded
 - (C) Cleared
 - (P) Pastured
 - (A) Agricultural
 - B.M. Bench Mark
 - Dwelling
 - Steep slope
 - Indefinite shoreline
 - Marsh
 - Spring
 - Intermittent stream
 - Permanent inlet
 - Permanent outlet
- LAKE BOTTOM SYMBOLS
- P. Peat
 - Mk. Muck
 - C. Clay
 - M. Marl
 - Sd. Sand
 - Gr. Gravel
 - R. Rubble
 - Br. Bedrock
 - T. Submergent vegetation
 - E. Emergent vegetation

WATER ELEV. 98.50'

7 Miles to Shawano

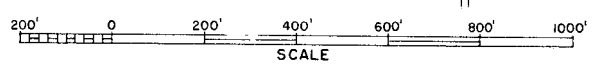

- ◇ Access
- ◀ Access with Parking
- ▲ Boat Landing

SPECIES OF FISH	Abundance	
	Common	Rare
Muskie		
N. Pike		
Walleye		
L. M. Bass		
S. M. Bass		
Panfish		
Trout		
B.M.	X	

AREA 22.10 ACRES
 UNDER 3FT. 1 %
 OVER 20FT. 61.25 %
 VOLUME 377.4 ACRE FT.
 TOTAL ALK. 177 P.P.M.
 SHORELINE 1.98 MILES