

STATE OF WISCONSIN
DEPARTMENT OF NATURAL RESOURCES

LAKE SURVEY MAP

KEGONSA LAKE
DANE COUNTY
SEC. 18-20, 29, 30 T. - 6 - N. R. - 10, 11 - E. 4
13, 14, 23-26

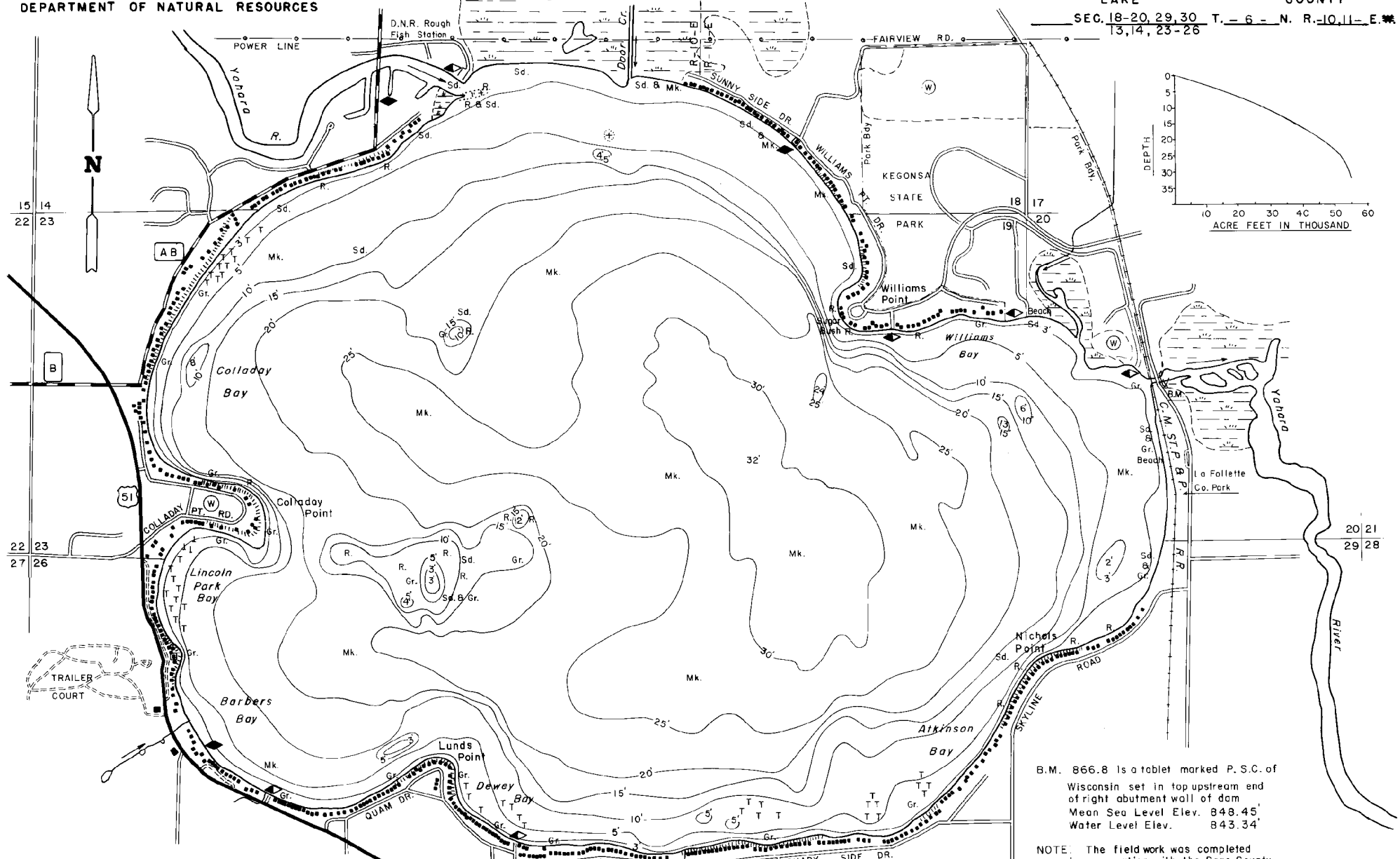

B.M. 866.8 is a tablet marked P.S.C. of Wisconsin set in top upstream end of right abutment wall of dam
Mean Sea Level Elev. 848.45'
Water Level Elev. 843.34'

NOTE: The field work was completed in cooperation with the Dane County Department of Public Works

EQUIPMENT RECORDING SONAR MAPPED AUGUST 1981

- | TOPOGRAPHIC SYMBOLS | | LAKE BOTTOM SYMBOLS | |
|-----------------------|---------------------------|---------------------|-----------------------------|
| (B) Brush | Sleep slope | P. Peat | B Boulders |
| (PW) Partially wooded | ~ Indefinite shoreline | Mk. Muck | ⊙ Stumps & Snags |
| (W) Wooded | ~ Marsh | C. Clay | ⊙ Rock danger to navigation |
| (C) Cleared | ~ Spring | M. Marl | T Submergent vegetation |
| (P) Pastured | ~ Intermittent stream | Sd. Sand | I Emergent vegetation |
| (A) Agricultural | ~ Permanent inlet | Sl. Silt | F Floating vegetation |
| B.M. Bench Mark | ~ Permanent outlet | G. Gravel | ⊙ Brush shelters |
| ■ Dwelling | ~ Dam | R. Rubble | |
| ■ Resort | ~ D.N.R. State owned land | Br. Bedrock | |
| ■ Camp | | | |

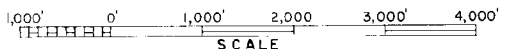

Access Access with Parking Boat Livery
Drawn by: E. Egan
Field work by: E. Brinsmade, J. Wessley, G. Nyenhuis

SPECIES OF FISH	ABUNDANCE		
	Abundant	Common	Present
Muskie	X		
N. Pike	X		
Walleye	X		
L.M. Bass	X		
S.M. Bass	X		
Panfish	X		
Trout			

WATER AREA 3,209.0 ACRES
UNDER 3 FT. 5 %
OVER 20 FT. 45 %
MAX. DEPTH 32 FEET.
TOTAL ALK. 192 P.P.M.
VOLUME 54,728.6 ACRE FT.
MAIN SHORELINE 9.63 MI.
ISLAND SHORELINE MI.