

STATE OF WISCONSIN
DEPARTMENT OF NATURAL RESOURCES

LAKE SURVEY MAP

KENTUCK LAKE FOREST-VILAS COUNTY
SEC. 4, 5, 33, 34 T. 40-41 N. R. 12 E.

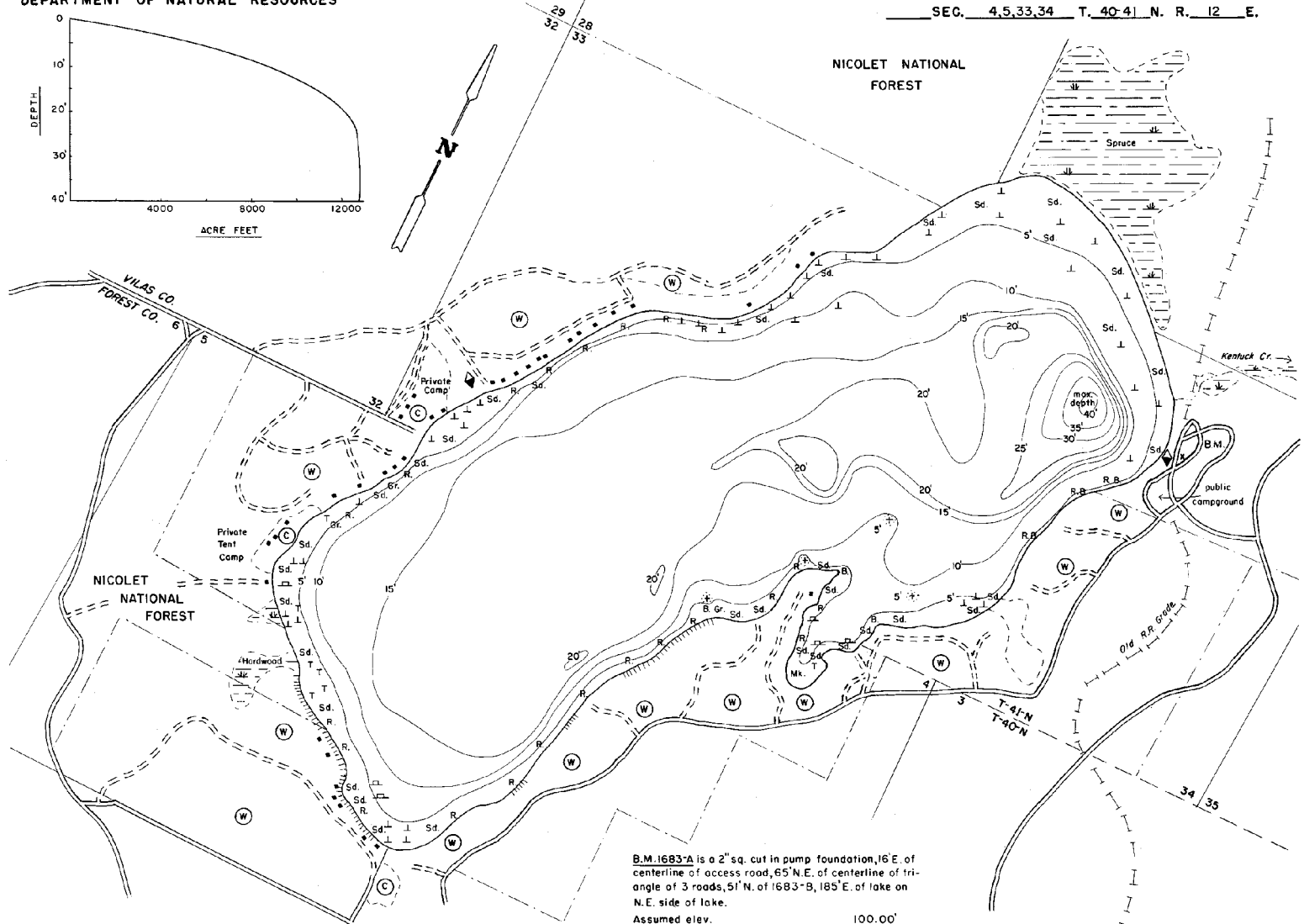
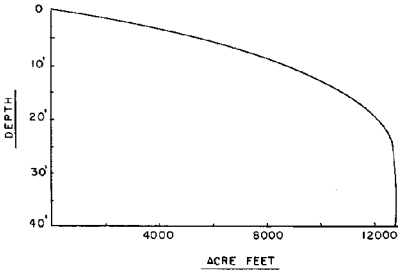

B.M. 1683-A is a 2' sq. cut in pump foundation, 16' E. of centerline of access road, 65' N.E. of centerline of triangle of 3 roads, 51' N. of 1683-B, 185' E. of lake on N.E. side of lake.
Assumed elev. 100.00'
Water level 92.91'
Reading taken 11/10/72

- | EQUIPMENT RECORDING | SONAR | MAPPED | JUNE | 1971 |
|----------------------------|-------------------------|-------------|-----------------------------|-------------------------|
| MONTH | LAKE | BOTTOM | YEAR | SYMBOLS |
| TOPOGRAPHIC SYMBOLS | | | | |
| (B) Brush | Steep slope | P. Peat | B. Boulders | ⬤ Stumps & Snags |
| (W) Partially wooded | ~ Indefinite shoreline | Mk. Muck | ⚡ Rock danger to navigation | T Submergent vegetation |
| (C) Cleared | ⊞ Marsh | C. Clay | ⬆ Emergent vegetation | ⬆ Floating vegetation |
| (P) Pastured | ~ Intermittent stream | M. Marl | ⬆ Brush shelters | |
| (A) Agricultural | ~ Permanent inlet | Sd. Sand | | |
| B.M. Bench Mark | ~ Permanent outlet | Sl. Silt | | |
| ■ Dwelling | ~ Dam | Gr. Gravel | | |
| ⊞ Resort | D.N.R. State owned land | R. Rubble | | |
| ⊞ Camp | | Bc. Bedrock | | |

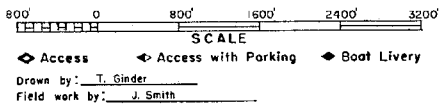

SPECIES OF FISH	1971	
	Abundant	Present
Muskie	X	X
N. Pike	X	X
Walleye	X	X
L. M. Bass	X	X
S. M. Bass	X	X
Panfish	X	X
Trout	X	X
Cisco	X	X

WATER AREA 957.49 ACRES
UNDER 3 FT. 8 %
OVER 20 FT. 12 %
MAX. DEPTH 40 FEET.
TOTAL ALK. 36 P.P.M.
VOLUME 12780.80 ACRE FT.
SHORELINE 6.04 MILES

Maps are not for navigation
Source-Wisconsin Department of Natural Resources
Hunt Fish Camp Wisconsin .Com 2005