

STATE OF WISCONSIN
DEPARTMENT OF NATURAL RESOURCES

LAKE SURVEY MAP

JUNGLE LAKE FOREST COUNTY
SEC. 2,3 T. 34 N. R. 13 E.

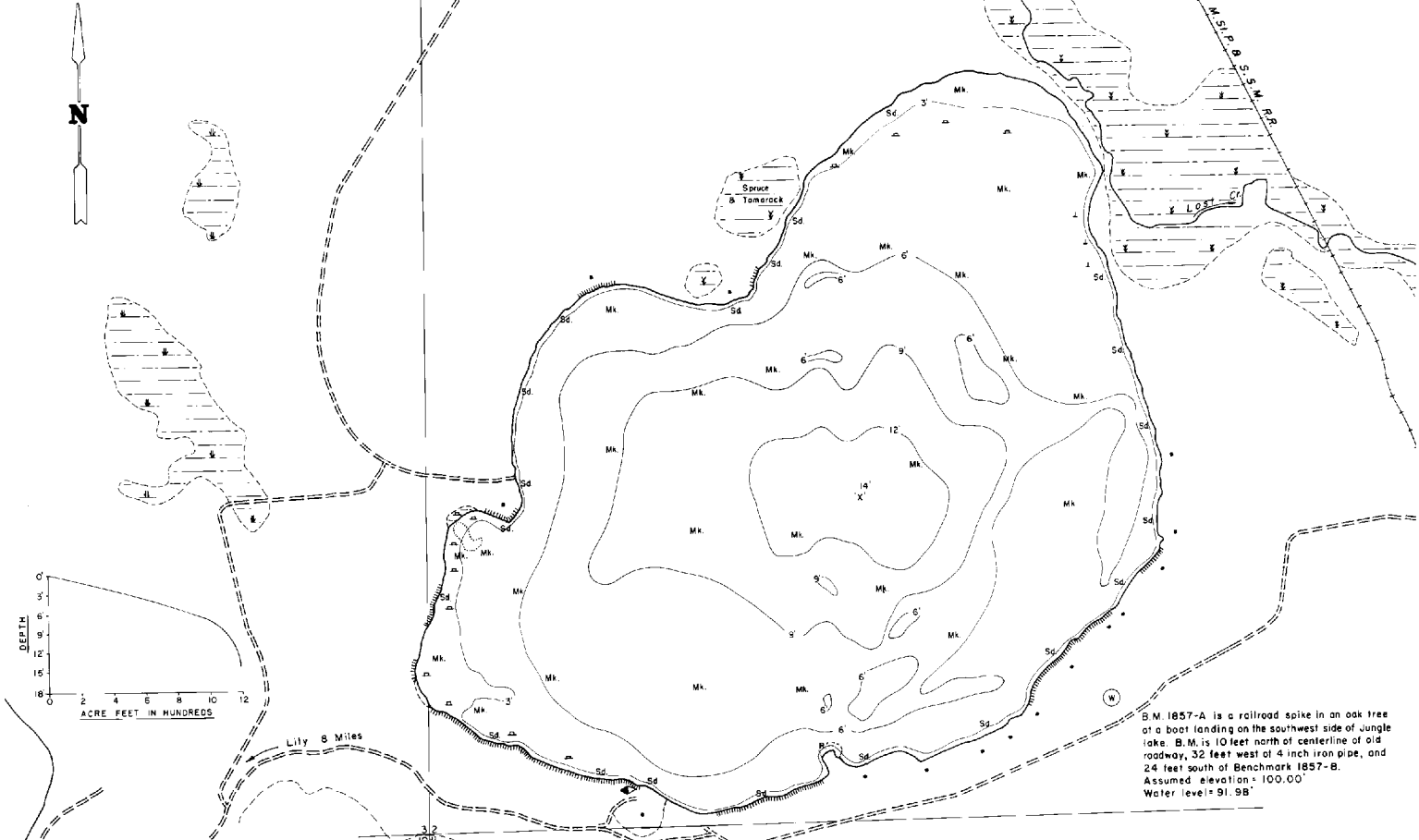

B.M. 1857-A is a railroad spike in an oak tree at a boat landing on the southwest side of Jungle lake. B.M. is 10 feet north of centerline of old roadway, 32 feet west of 4 inch iron pipe, and 24 feet south of Benchmark 1857-B. Assumed elevation = 100.00' Water level = 91.98'

EQUIPMENT	RECORDING	SONAR	MAPPED	OCT. 1974	LAKE BOTTOM	SYMBOLS
①	②	③	④	⑤	⑥	⑦
Brush	Partially wooded	Wooded	Cleared	Pastured	Agricultural	B.M. Bench Mark
Dwelling	Resort	Camp	Intermittent stream	Permanent inlet	Permanent outlet	Dom.
D.N.R. State owned land			Bedrock	Peat	Muck	Clay
			Marl	Sand	Silt	Gravel
			Rubble	Bedrock	Boulders	Stumps & Snags
			Rock danger to navigation	Submergent vegetation	Emergent vegetation	Floating vegetation
			Brush shelters			

300' 0' 300' 600' 900' 1200'
SCALE
◆ Access ◆ Access with Parking ◆ Boat Livery
Drawn by: G. Thuyssen
Field work by: J. Smith & Kaplan

SPECIES OF FISH	Abundant	Present
Muskie		
N. Pike		
Whiteeye		
L. M. Bass	X	
S. M. Bass	X	
Panfish	X	
Trout		

WATER AREA 177.16 ACRES
UNDER 3 FT. 6.51 %
OVER 20 FT. 0 %
MAX. DEPTH 16 FEET.
TOTAL ALK. 49 P.P.M.
VOLUME 1192.21 ACRE FT.
MAIN SHORELINE 2.22 MI.
ISLAND SHORELINE 0 MI.

Maps are not for navigation
Source-Wisconsin Department of Natural Resources
Hunt Fish Camp Wisconsin .Com 2005