

STATE OF WISCONSIN
DEPARTMENT OF NATURAL RESOURCES

LAKE SURVEY MAP

JOHNSON LAKE
SAWYER COUNTY
SEC. 25, 36 T. 40 N. R. 9 W.

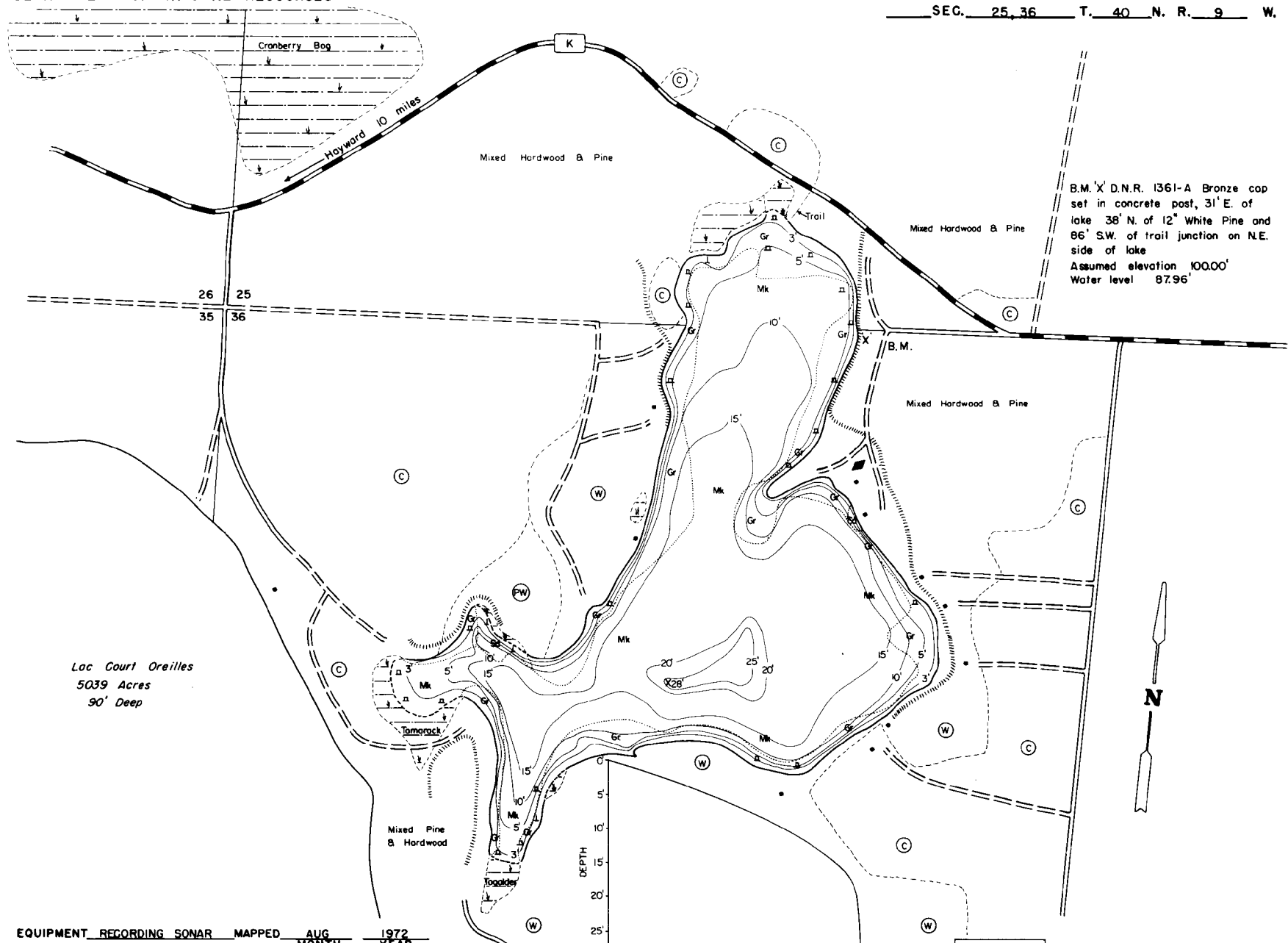

B.M. X D.N.R. 1361-A Bronze cap set in concrete post, 31' E. of lake 38' N. of 12" White Pine and 86' SW. of trail junction on N.E. side of lake
Assumed elevation 100.00'
Water level 87.96'

Lac Court Oreilles
5039 Acres
90' Deep

EQUIPMENT RECORDING SONAR MAPPED AUG 1972
MONTH YEAR
LAKE BOTTOM

- | TOPOGRAPHIC SYMBOLS | | LAKE BOTTOM SYMBOLS | |
|-----------------------|------------------------|---------------------|-----------------------------|
| (B) Brush | Steep slope | P. Peat | B Boulders |
| (PW) Partially wooded | ~ Indefinite shoreline | Mk. Muck | ⚡ Stumps & Snags |
| (W) Wooded | ~ Marsh | C. Clay | ⚡ Rock danger to navigation |
| (C) Cleared | o Spring | M. Marl | T Submergent vegetation |
| (P) Pastured | ~ Intermittent stream | Sd. Sand | ⊥ Floating vegetation |
| (A) Agricultural | ~ Permanent inlet | Sl. Silt | ~ Floating vegetation |
| B.M. Bench Mark | ~ Permanent outlet | Gr. Gravel | ⚡ Brush shelters |

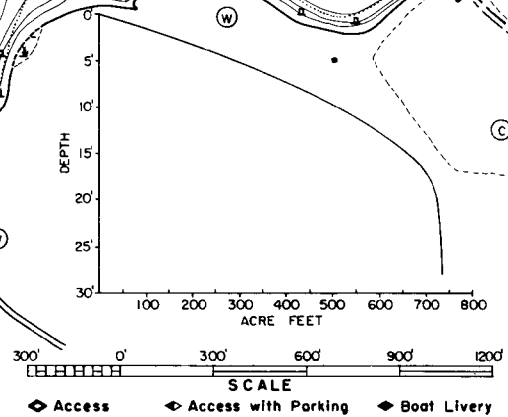

SPECIES OF FISH	Abundance		
	Common	Present	
Muskie		X	
N. Pike		X	
Walleye		X	
L.M. Bass	X		
S.M. Bass	X		
Panfish	X		

WATER AREA 619 ACRES
UNDER 3 FT. 7 %
OVER 20 FT. 4 %
MAX. DEPTH 28 FEET
TOTAL ALK. 7 P.P.M.
VOLUME 738.7 ACRE FT.
SHORELINE 10 MILES