

STATE OF WISCONSIN
DEPARTMENT OF NATURAL RESOURCES

LAKE SURVEY MAP

JERSEY CITY FLOWAGE LINCOLN COUNTY
SEC. AS SHOWN T. 35 N. R. 6 E.
SHEET 1 OF 2

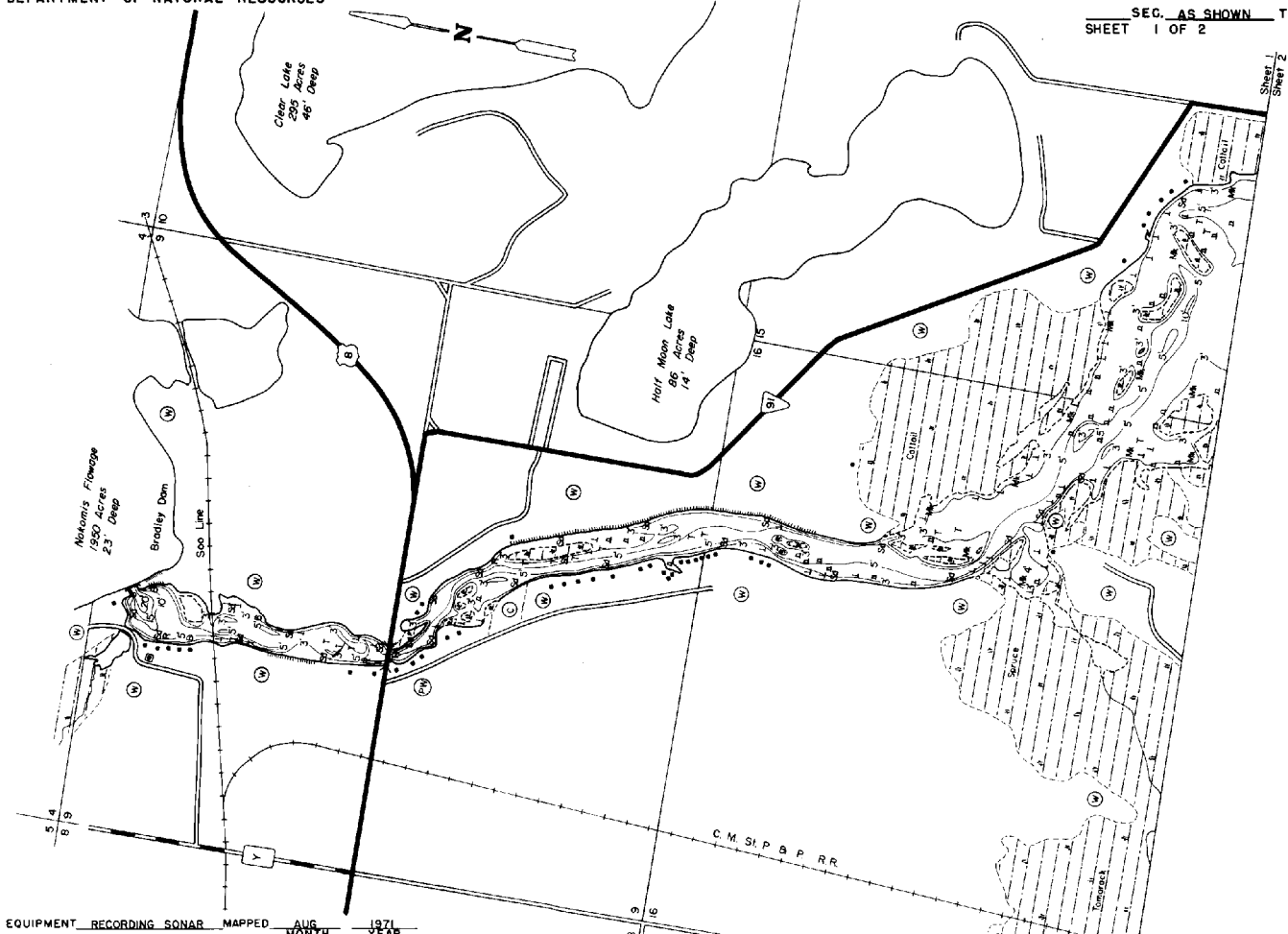

EQUIPMENT	RECORDING	SONAR	MAPPED	AUG	1971
TOPOGRAPHIC SYMBOLS			LAKE BOTTOM SYMBOLS		
B	Brush	Steep slope	P	Peel
PW	Partially wooded	Indefinite shoreline	MR	Muck
W	Wooded	Marsh	C	Clay
C	Cleared	Spring	M	Marl
P	Pastured	Intermittent stream	Sg	Sand
A	Agricultural	Permanent inlet	St	Silt
B.M.	Bench Mark	Permanent outlet	Gr	Gravel
D	Dwelling	Dam	R	Rubble
R	Resort	D.N.R. State owned land	Bc	Bedrock
C	Camp		B	Boulders
				S	Stumps & Snags
				T	Rock danger to navigation
				S	Submergent vegetation
				E	Emergent vegetation
				F	Floating vegetation
				BS	Brush shelters

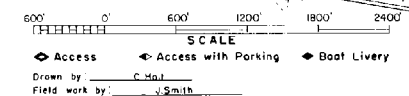

SPECIES OF FISH	1971	
	Abundant	Common
Muskie	X	X
N. Pike	X	X
Walleye	X	X
S. M. Bass	X	X
Panfish	X	X
Trout		

WATER AREA	404.4	ACRES
UNDER 3 FT.	20	%
OVER 20 FT.	0	%
MAX. DEPTH	20	FEET.
TOTAL ALK.	39	P.P.M.
VOLUME	1794	ACRE FT.
MAIN SHORELINE	13.4	MI.
ISLAND SHORELINE	3.76	MI.

Maps are not for navigation
Source-Wisconsin Department of Natural Resources
Hunt Fish Camp Wisconsin .Com 2005