

STATE OF WISCONSIN  
DEPARTMENT OF NATURAL RESOURCES

LAKE SURVEY MAP

JERRY LAKE WASHBURN COUNTY  
SEC. 26, 27, 34, 35 T. - 40 - N. R. - 13 - W.

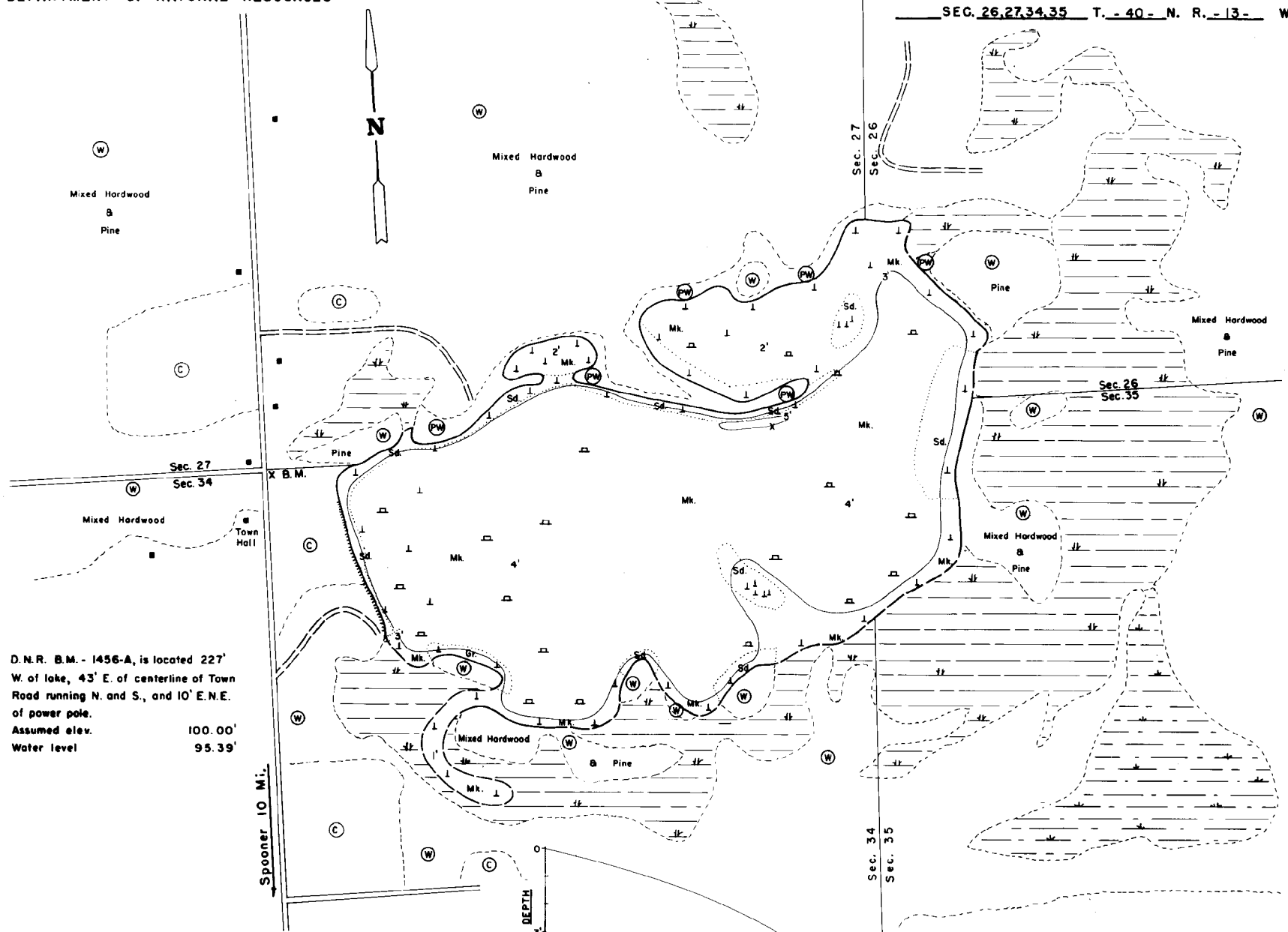

D.N.R. B.M. - 1456-A, is located 227' W. of lake, 43' E. of centerline of Town Road running N. and S., and 10' E.N.E. of power pole.  
Assumed elev. 100.00'  
Water level 95.39'

EQUIPMENT RANGE POLE MAPPED MAY 1969

- TOPOGRAPHIC SYMBOLS
- (B) Brush
  - (PW) Partially wooded
  - (W) Wooded
  - (C) Cleared
  - (P) Pastured
  - (A) Agricultural
  - B.M. Bench Mark
  - Dwelling
- LAKE BOTTOM SYMBOLS
- P. Peat
  - Mk. Muck
  - C. Clay
  - M. Marl
  - Sd. Sand
  - St. Silt
  - Gr. Gravel
  - R. Rubble

- LAKE BOTTOM SYMBOLS
- B Boulders
  - Stumps & Snags
  - Rock danger to navigation
  - T Submergent vegetation
  - ↓ Emergent vegetation
  - △ Floating vegetation
  - ↖ Brush shelters

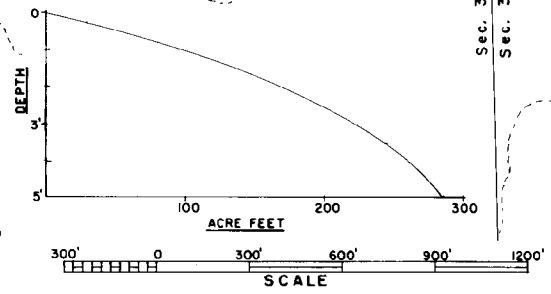

SPECIES OF FISH	Abundance		
	Common	Present	
Whitefish			
Muskie			
N. Pike			X
Walleye			X
L.M. Bass			
S.M. Bass			
Panfish			X

WATER AREA 86.7 ACRES  
UNDER 3 FT. 27.2 %  
OVER 20 FT. 0 %  
MAX. DEPTH 5 FEET.  
TOTAL ALK. 13 P.P.M.  
VOLUME 287.9 ACRE FT.  
SHORELINE 2.15 MILES

Access Access with Parking Boat Livery