

STATE OF WISCONSIN
DEPARTMENT OF NATURAL RESOURCES

LAKE SURVEY MAP

GRESHAM POND

SHAWANO

LAKE

COUNTY

SEC. 3, 33, 34

T.-27, 28-N. R.-14 - E.W.

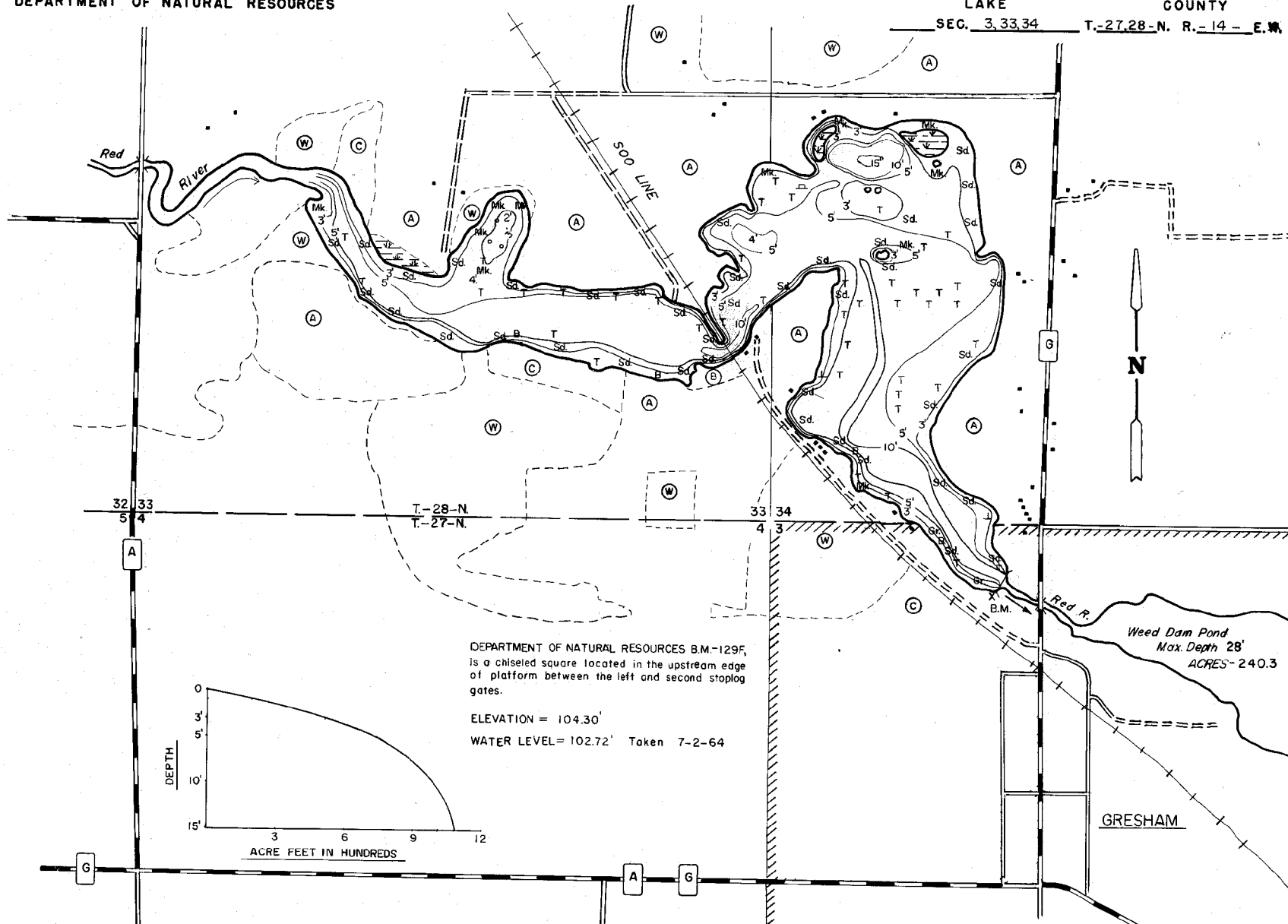

EQUIPMENT RECORDING SONAR MAPPED

JULY 1966

MONTH YEAR
LAKE BOTTOM SYMBOLS

- | | |
|-------------------------------|-----------------------------|
| TOPOGRAPHIC SYMBOLS | LAKE BOTTOM SYMBOLS |
| (B) Brush | P. Peat |
| (W) Partially wooded | Mk. Muck |
| (W) Wooded | C. Clay |
| (C) Cleared | M. Marl |
| (P) Pastured | Sd. Sand |
| (A) Agricultural | St. Silt |
| B.M. Bench Mark | Gr. Gravel |
| ■ Dwelling | R. Rubble |
| □ Resort | Bc Bedrock |
| □ Camp | |
| Steep slope | B Boulders |
| ----- Indefinite shoreline | ⚓ Stumps & Snags |
| ----- Marsh | ⚠ Rock danger to navigation |
| ----- Spring | T Submergent vegetation |
| ----- Intermittent stream | ↓ Emergent vegetation |
| ----- Permanent inlet | ⚓ Floating vegetation |
| ----- Permanent outlet | ⚓ Brush shelters |
| ----- Dam | |
| ----- D.N.R. State owned land | |

600' 0 600' 1200' 1800' 2400'

SCALE

◆ Access ◆ Access with Parking ◆ Boat Livery

Drawn by: T. Ginder

Field work by: J. Smith & P. Michelson

SPECIES OF FISH

Species	Abundant	Common	Present
Muskie			
N. Pike	X		
Walleye	X		
L. M. Bass	X		
S. M. Bass	X		
Panfish	X		
Trout	X		

WATER AREA 187.60 ACRES

UNDER 3 FT. 16 %
OVER 20 FT. — %

MAX. DEPTH 15.0 FEET
TOTAL ALK. 138.0 P.P.M.

VOLUME 1096.05 ACRE FT.

SHORELINE 4.75 MILES
WITH ISLANDS 5.22 MILES