

STATE OF WISCONSIN
DEPARTMENT OF NATURAL RESOURCES

LAKE SURVEY MAP

GORDON LAKE FOREST COUNTY
SEC. 8 T. 37 N. R. 16 E.

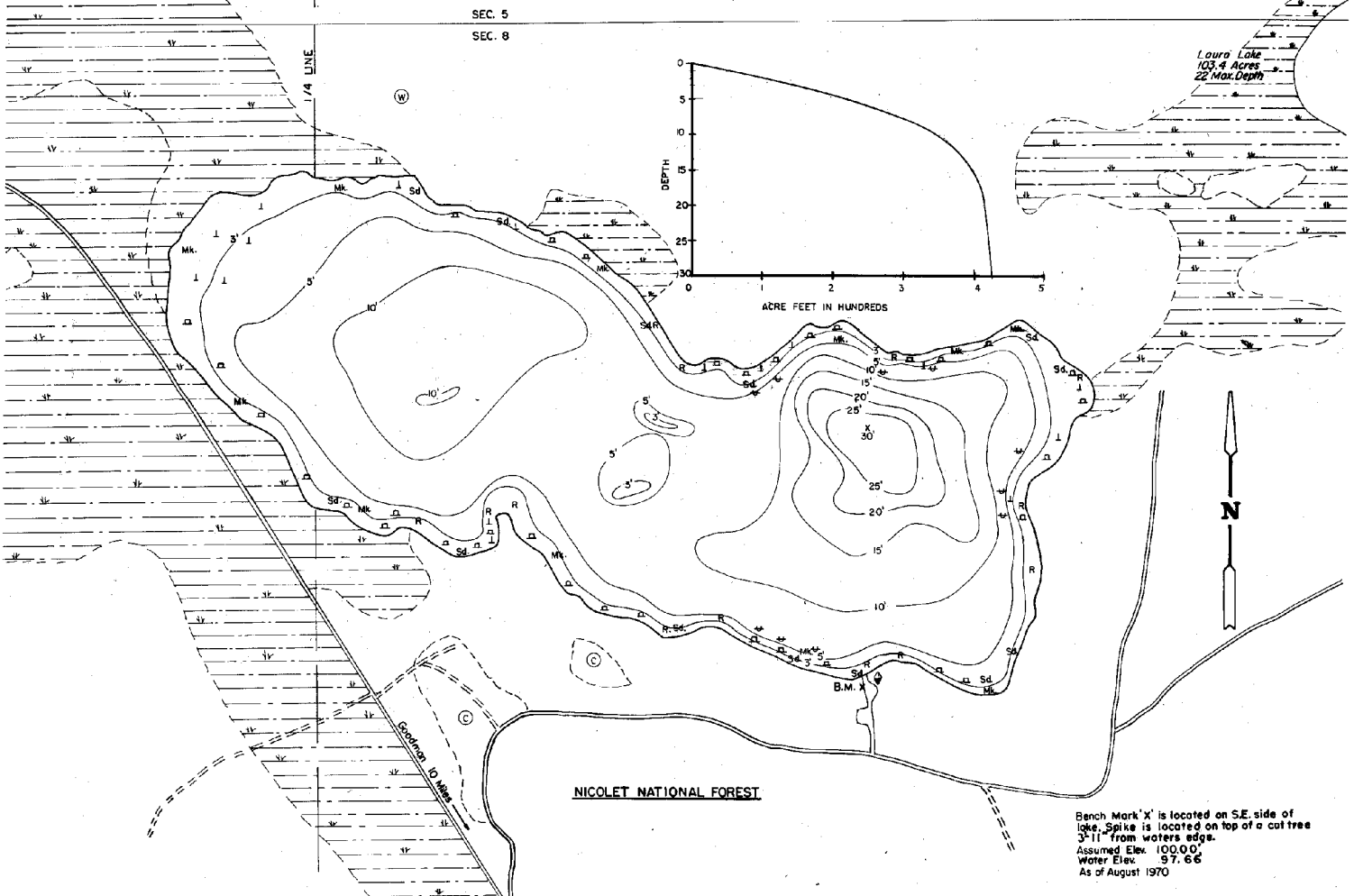

- EQUIPMENT RECORDING SONAR MAPPED AUGUST 1970
- | TOPOGRAPHIC SYMBOLS | | LAKE BOTTOM SYMBOLS | |
|----------------------|-------------------------|---------------------|---------------------------|
| (B) Brush | Steep slope | P. Peat | B. Boulders |
| (W) Partially wooded | Indefinite shoreline | Mk. Muck | Stumps & Snags |
| (W) Wooded | Marsh | C. Clay | Rock danger to navigation |
| (C) Cleared | Spring | M. Marl | T. Submergent vegetation |
| (P) Pastured | Intermittent stream | Sd. Sand | Emergent vegetation |
| (A) Agricultural | Permanent inlet | St. Silt | Floating vegetation |
| B.M. Bench Mark | Permanent outlet | Gr. Gravel | Brush shelters |
| Dwelling | Dam | R. Rubble | |
| Resort | D.N.R. State owned land | Bt. Bedrock | |
| Camp | | | |

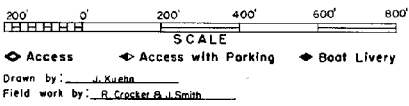

SPECIES OF FISH	1970	
	Abundant	Common Present
Muskie		
N. Pike		
Walleye		
L. M. Bass	X	
S. M. Bass	X	
Panfish	X	
Trout		

WATER AREA 50.29 ACRES
 UNDER 3 FT. 13 %
 OVER 20 FT. 4 %
 MAX. DEPTH 30 FEET.
 TOTAL ALK. P.P.M.
 VOLUME 425.99 ACRE FT.
 SHORELINE 1.39 MILES

Maps are not for navigation
 Source-Wisconsin Department of Natural Resources
 Hunt Fish Camp Wisconsin .Com 2005