

STATE OF WISCONSIN
DEPARTMENT OF NATURAL RESOURCES

LAKE SURVEY MAP

DUROY LAKE PRICE COUNTY
SEC. 7,8,17,18 T. 37 N. R. 1 E.
Sheet "1" of "2"

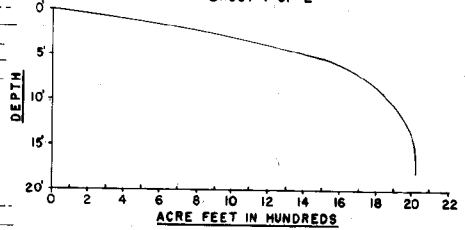
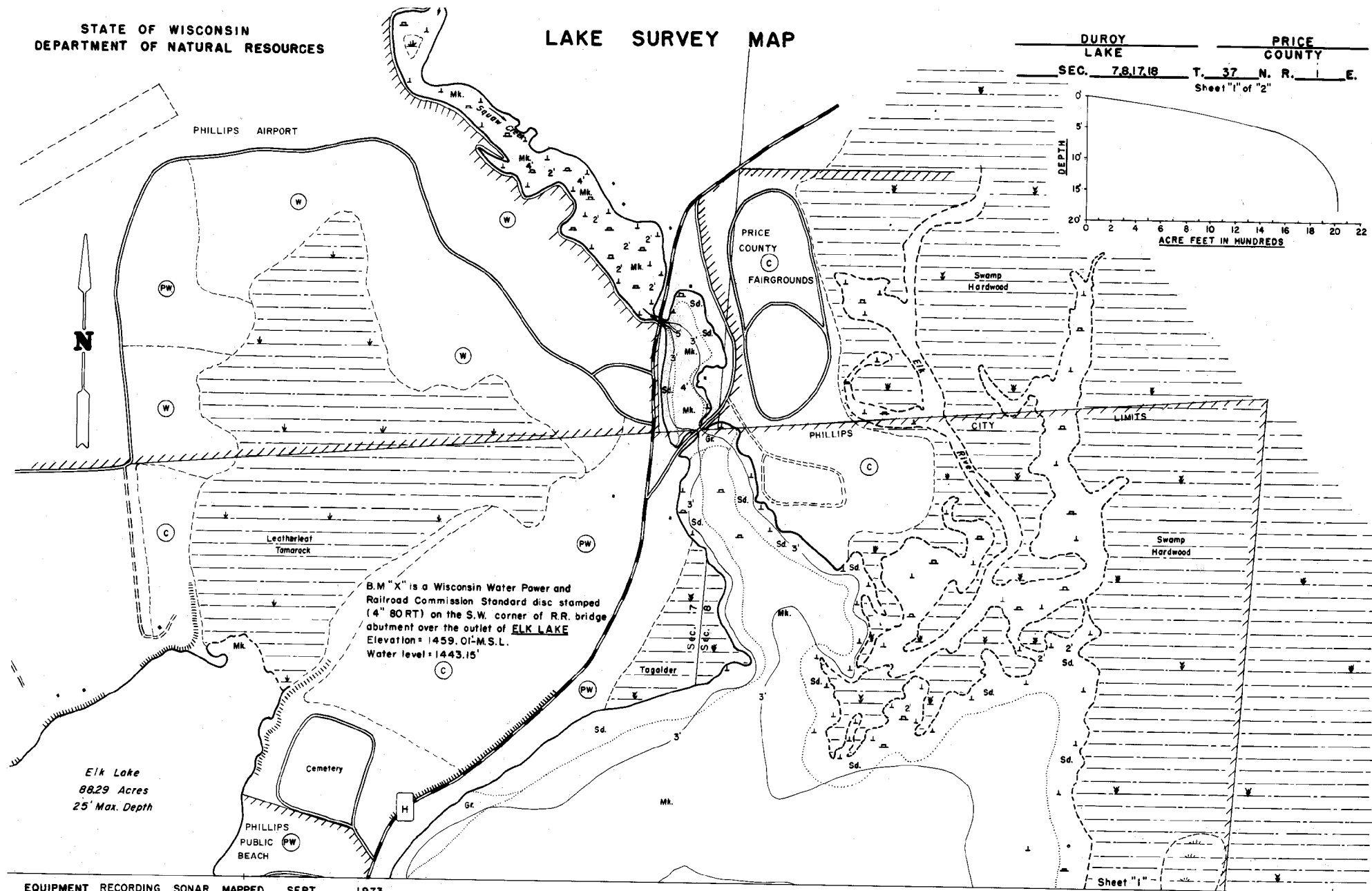

B.M. "X" is a Wisconsin Water Power and Railroad Commission Standard disc stamped (4" BORT) on the S.W. corner of R.R. bridge abutment over the outlet of ELK LAKE
Elevation = 1459.01-M.S.L.
Water level = 1443.15'

Elk Lake
8829 Acres
25' Max. Depth

EQUIPMENT RECORDING SONAR MAPPED SEPT. 1973
MONTH YEAR

- | TOPOGRAPHIC SYMBOLS | | LAKE BOTTOM SYMBOLS | |
|-----------------------|-------------------------|---------------------|-----------------------------|
| (B) Brush | Steep slope | P. Peat | B Boulders |
| (PW) Partially wooded | ~ Indefinite shoreline | Mk. Muck | ☼ Stumps & Snags |
| (W) Wooded | ~ Marsh | C. Clay | ⚠ Rock danger to navigation |
| (C) Cleared | ~ Spring | M. Marl | T Submergent vegetation |
| (P) Pastured | ~ Intermittent stream | Sd. Sand | ↓ Emergent vegetation |
| (A) Agricultural | ~ Permanent inlet | St. Silt | ~ Floating vegetation |
| B.M. Bench Mark | ~ Permanent outlet | Gr. Gravel | ↖ Brush shelters |
| (D) Dwelling | ~ Dam | R. Rubble | |
| (R) Resort | D.N.R. State owned land | Bc. Bedrock | |
| (C) Camp | | | |

SPECIES OF FISH	Abundance	
	Common	Present
Muskie	X	X
N. Pike	X	X
Walleye	X	X
L.M. Bass	X	X
S.M. Bass	X	X
Panfish	X	X
Trout		

WATER AREA 379.26 ACRES
UNDER 3 FT. 27 %
OVER 20 FT. 0 %
MAX. DEPTH 18 FEET.
TOTAL ALK. 22 P.P.M.
VOLUME 2016.6 ACRE FT.
MAIN SHORELINE 9.66 MI.
ISLAND SHORELINE 0.40 MI.

300' 0' 300' 600' 900' 1200'
SCALE
◆ Access ◆ Access with Parking ◆ Boat Livery

Drawn by: G. Thuesen
Field work by: C. Busch, K. Cable, L.M. Sather