

STATE OF WISCONSIN
DEPARTMENT OF NATURAL RESOURCES

LAKE SURVEY MAP

DUCK LAKE
SEC. 15, 16, 21, 22 T. 40 N. R. 10 E.
VILAS COUNTY

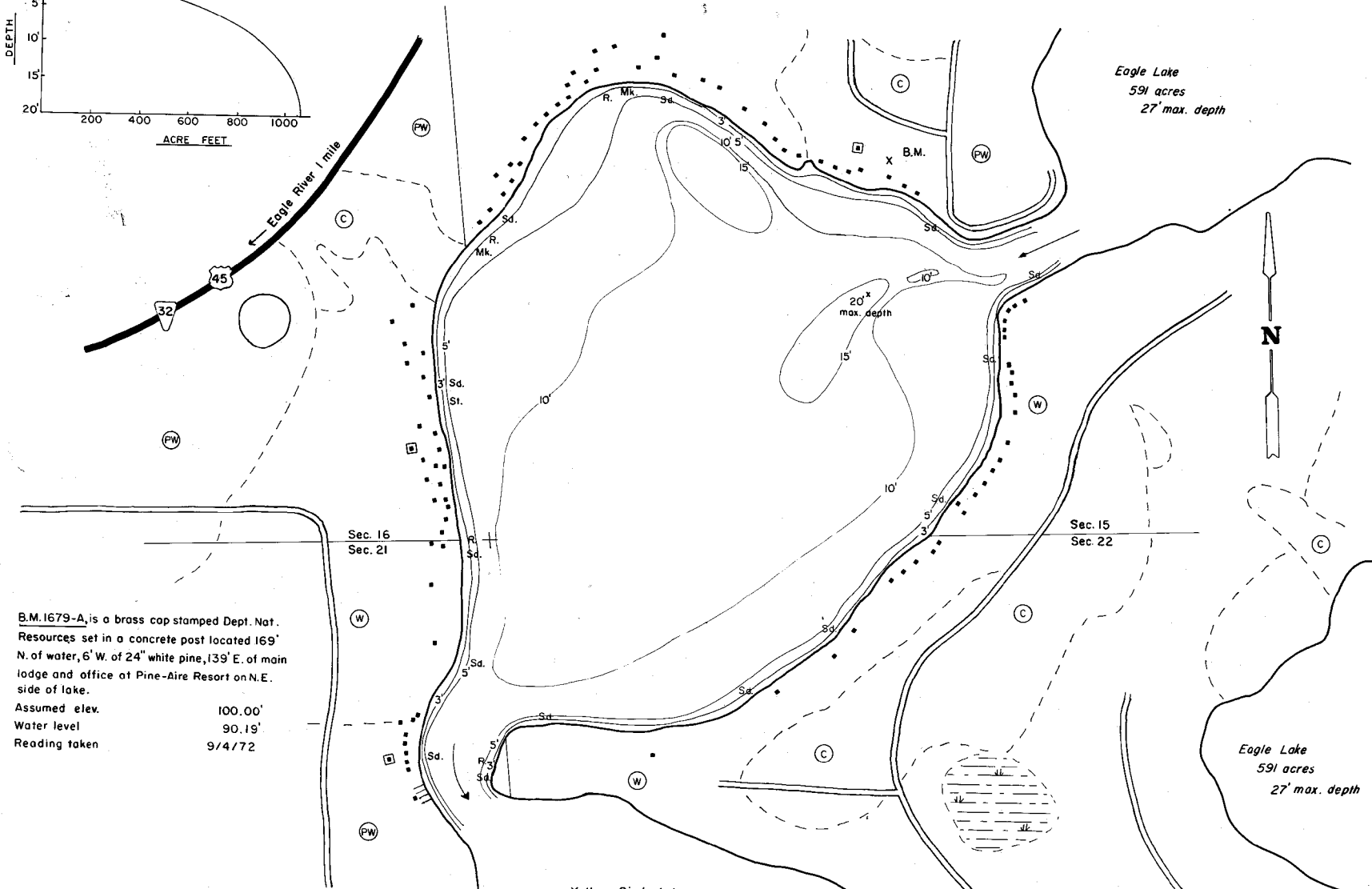
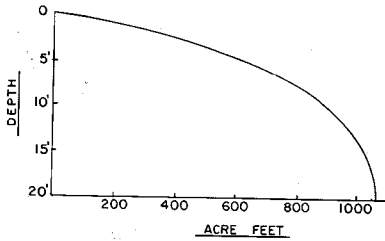

B.M. 1679-A, is a brass cap stamped Dept. Nat. Resources set in a concrete post located 169' N. of water, 6' W. of 24" white pine, 139' E. of main lodge and office at Pine-Aire Resort on N.E. side of lake.
Assumed elev. 100.00'
Water level 90.19'
Reading taken 9/4/72

EQUIPMENT RECORDING SONAR MAPPED		JUNE 1970	
TOPOGRAPHIC SYMBOLS		LAKE BOTTOM SYMBOLS	
(B) Brush	Steep slope	P. Peat	B Boulders
(PW) Partly wooded	- - - Indefinite shoreline	Mk. Muck	⊙ Stumps & Snags
(W) Wooded	Marsh	C. Clay	⊙ Rock danger to navigation
(C) Cleared	Spring	M. Marl	T Submergent vegetation
(P) Pastured	Intermittent stream	Sd. Sand	⊙ Emergent vegetation
(A) Agricultural	Permanent inlet	St. Silt	⊙ Floating vegetation
B.M. Bench Mark	Permanent outlet	Gr. Gravel	⊙ Brush shelters
■ Dwelling	Dam	R. Rubble	
□ Resort	State owned land		

Yellow Birch Lake
185 acres
14' max. depth



Access Access with Parking Boat Livery
Drawn by: T. Ginder

SPECIES OF FISH	ABUNDANCE		
	Abundant	Common	Present
Muskie	X		
N. Pike	X	X	X
Walleye	X	X	X
L. M. Bass	X	X	X
S. M. Bass	X	X	X
Panfish	X		

WATER AREA 108.29 ACRES
UNDER 3 FT. 4 %
OVER 20 FT. 0 %
MAX. DEPTH 20 FEET
TOTAL ALK. 28 P.P.M.
VOLUME 1041.92 ACRE FT.
SHORELINE 165 MILES