

STATE OF WISCONSIN  
DEPARTMENT OF NATURAL RESOURCES

LAKE SURVEY MAP

DOWLING LAKE DOUGLAS COUNTY  
SEC. 7, 18 T. 46 N. R. 13 W.

AMMICON LAKE  
426 acres  
31' max. depth

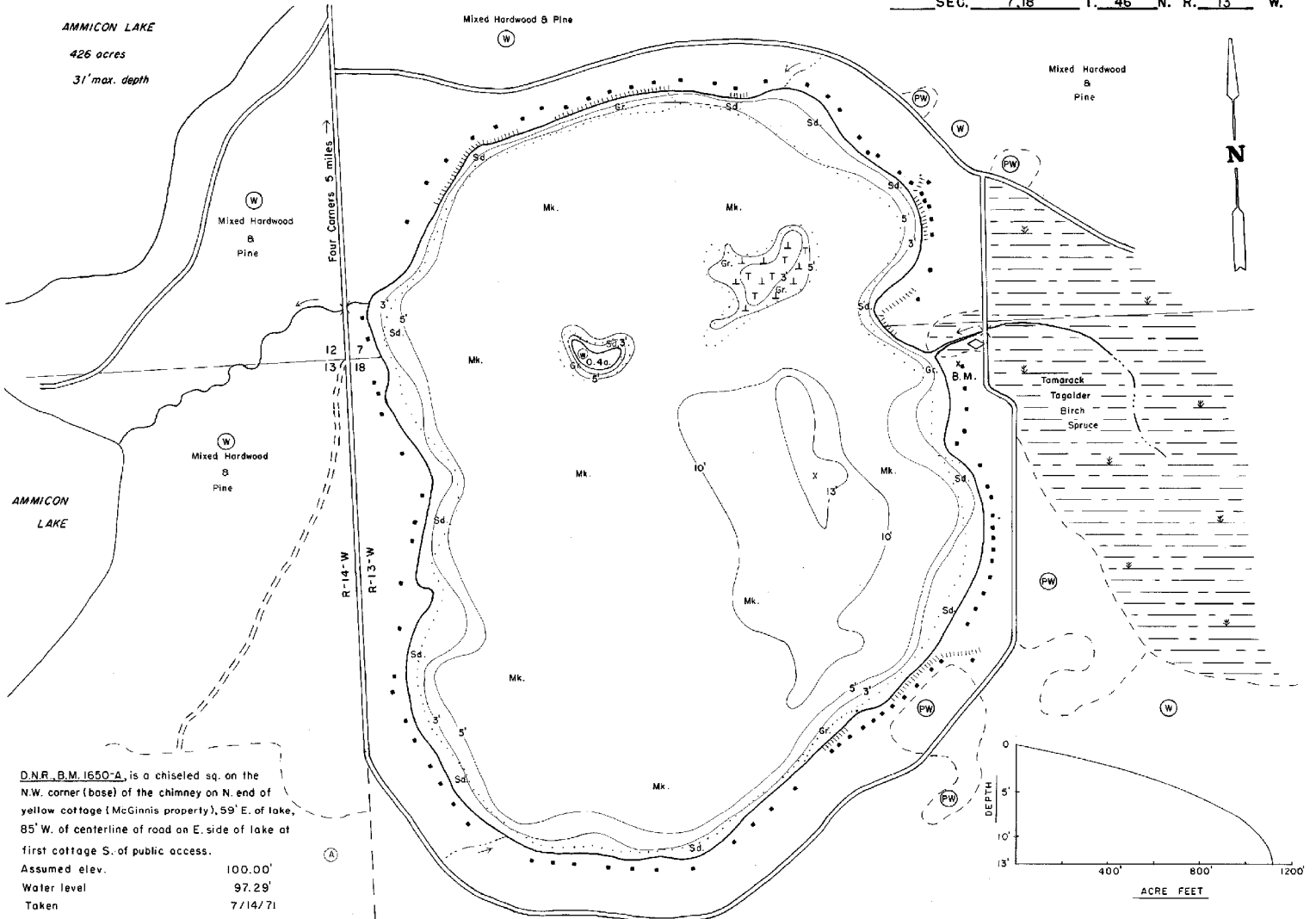

D.N.R. B.M. 1650-A, is a chiseled sq. on the N.W. corner (base) of the chimney on N. end of yellow cottage (McGinnis property), 59' E. of lake, 85' W. of centerline of road on E. side of lake at first cottage S. of public access.  
Assumed elev. 100.00'  
Water level 97.29'  
Taken 7/14/71

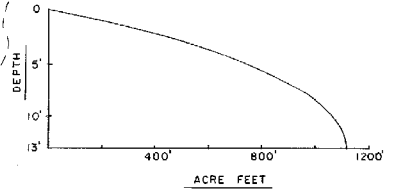

EQUIPMENT RECORDING SONAR MAPPED JULY 1971

- | TOPOGRAPHIC SYMBOLS |                            | LAKE BOTTOM SYMBOLS |                             |
|---------------------|----------------------------|---------------------|-----------------------------|
| (S) Brush           | Steep slope                | P. Peat             | B Boulders                  |
| (PW) Partly wooded  | - - - Indefinite shoreline | Mk. Muck            | ☼ Stumps & Snags            |
| (W) Wooded          | ▧ Marsh                    | C. Clay             | ☼ Rock danger to navigation |
| (C) Cleared         | ○ Spring                   | M. Marl             | T Submergent vegetation     |
| (P) Pastured        | --- Intermittent stream    | Sd. Sand            | I Emergent vegetation       |
| (A) Agricultural    | ≡ Permanent inlet          | Sl. Silt            | ☼ Floating vegetation       |
| B.M. Bench Mark     | ≡ Permanent outlet         | Gr. Gravel          | ☼ Brush shelters            |
| ■ Dwelling          | ∟ Dam                      | R. Rubble           |                             |
| □ Resort            | ▭ D.N.R. State owned land  | Br. Bedrock         |                             |
| □ Camp              |                            |                     |                             |

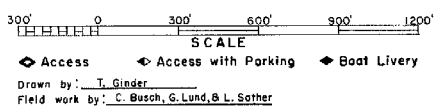

SPECIES OF FISH	ABUNDANT	
	Common	RARE
Muskie		
N. Pike	X	
Walleye	X	
L.M. Bass		X
S.M. Bass		
Panfish	X	
Trout		

WATER AREA 153.8 ACRES  
UNDER 3 FT. 8 %  
OVER 20 FT. 0 %  
MAX. DEPTH 13 FEET.  
TOTAL ALK. 22 P.P.M.  
VOLUME 1113.3 ACRE FT.  
SHORELINE 1.95 MILES  
WITH ISLAND 2.06 MILES

Maps are not for navigation  
Source-Wisconsin Department of Natural Resources  
Hunt Fish Camp Wisconsin .Com 2005