

WISCONSIN CONSERVATION DEPARTMENT

LAKE SURVEY MAP

Developed

LAKE DELAVAN (Sheet 3 of 3)
SECTION 21-22-27-28
TOWNSHIP 2-N
RANGE 16-E
TOWN DELAVAN
COUNTY WALWORTH

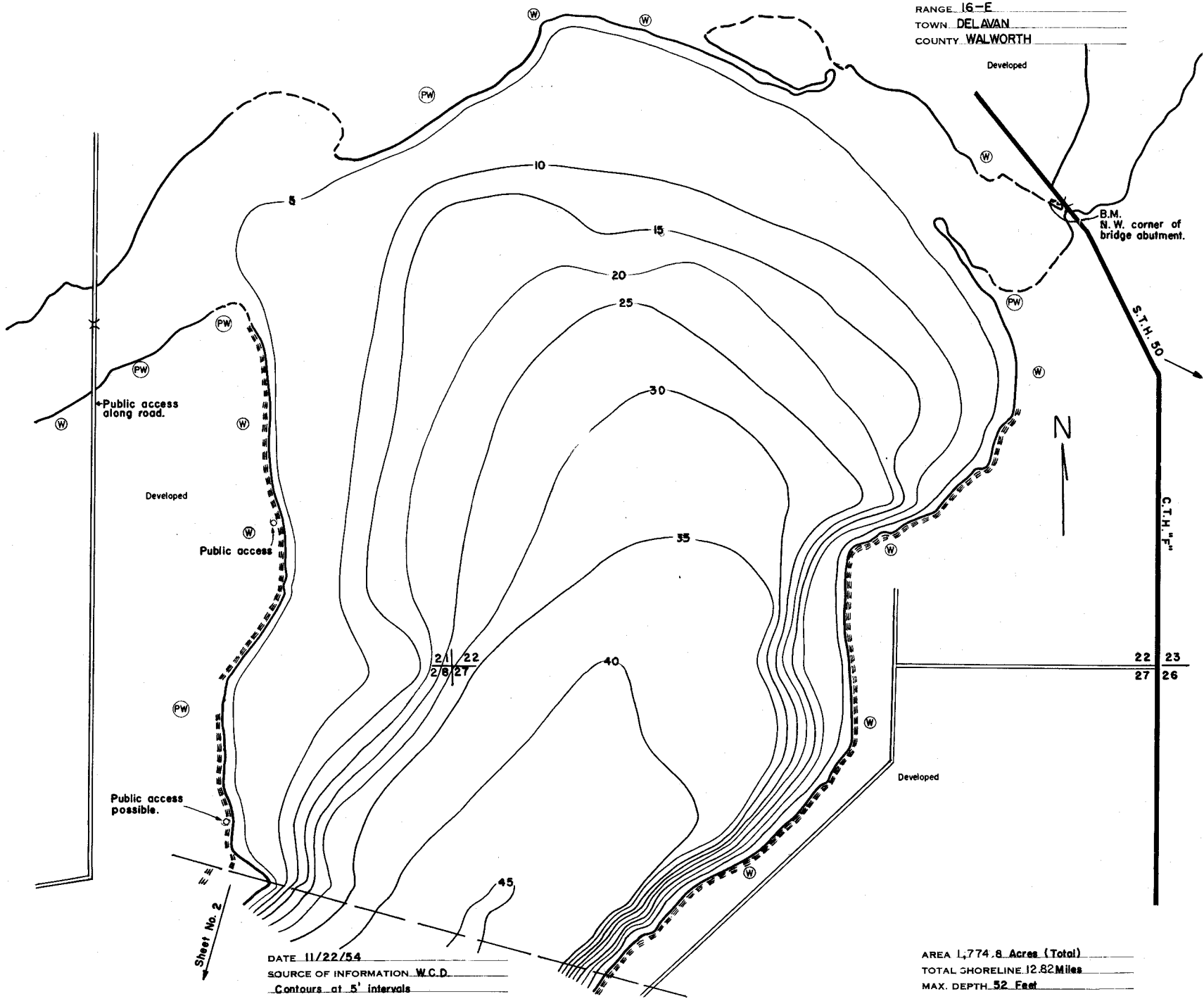

DATE 11/22/54
SOURCE OF INFORMATION W.C.D.
Contours at 5' intervals

AREA 1,774.8 Acres (Total)
TOTAL SHORELINE 12.82 Miles
MAX. DEPTH 52 Feet