

WISCONSIN CONSERVATION DEPARTMENT

LAKE SURVEY MAP

DEER LAKE POLK COUNTY  
 SEC. 25,30,29 T. -34- N. R. -17,18- E.W.

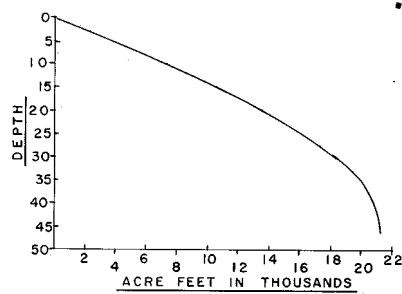
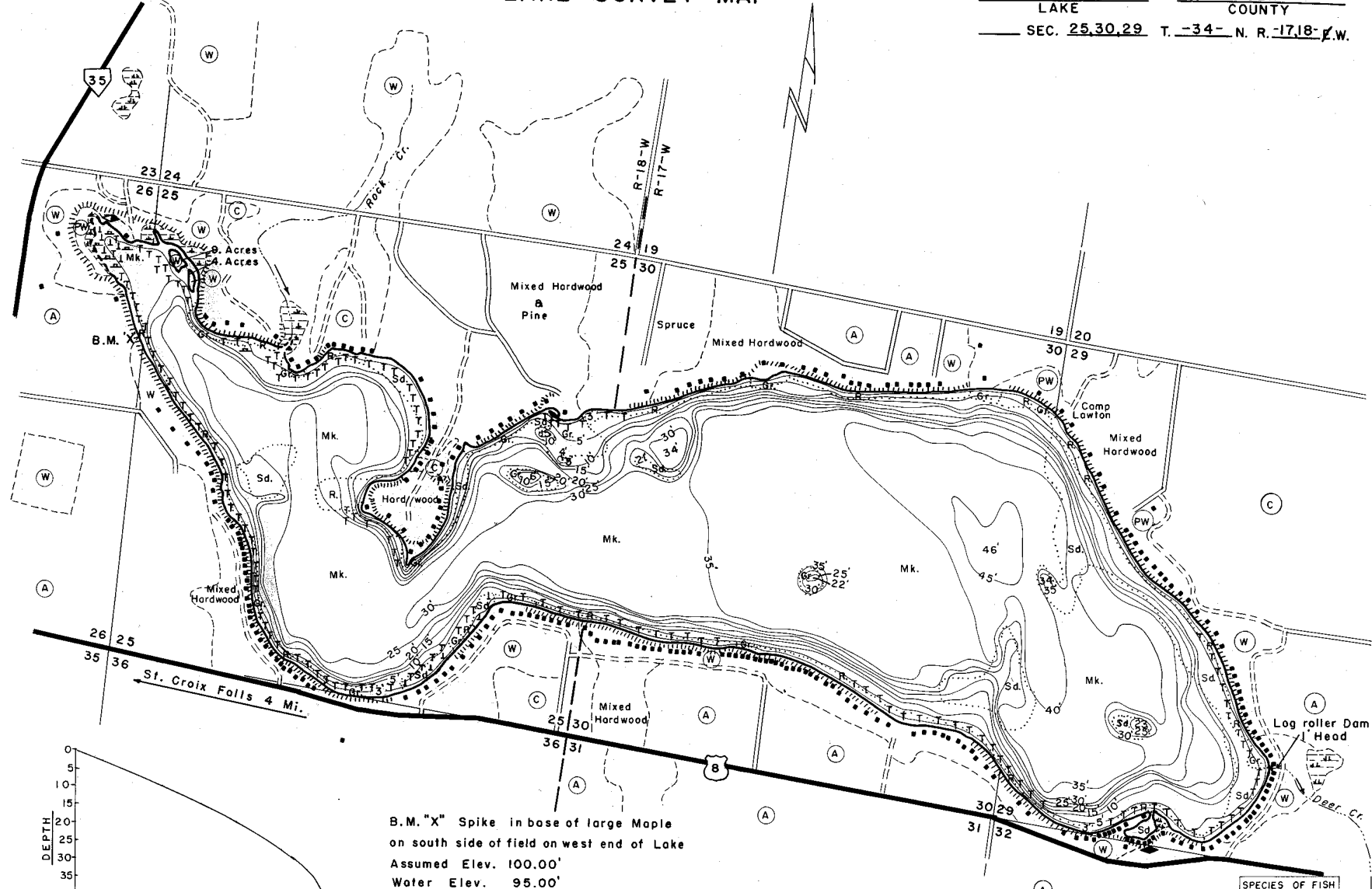

B.M. "X" Spike in base of large Maple  
 on south side of field on west end of Lake  
 Assumed Elev. 100.00'  
 Water Elev. 95.00'

SPECIES OF FISH	
	Abundant Common Rare
Muskie	
N. Pike	X
Walleye	
L. M. Bass	X
S. M. Bass	
Panfish	X
Trout	

EQUIPMENT RECORDING SONAR MAPPED AUGUST 1966  
 MO. YR.

- TOPOGRAPHIC SYMBOLS
- (B) Brush
  - (PW) Partially wooded
  - (W) Wooded
  - (C) Cleared
  - (P) Pastured
  - (A) Agricultural
  - B.M. Bench Mark
- LAKE BOTTOM SYMBOLS
- P. Peat
  - Mk. Muck
  - C. Clay
  - M. Marl
  - Gr. Gravel
  - R. Rubble
  - Br. Bedrock
  - Stumps & Snags
- TOPOGRAPHIC SYMBOLS (continued)
- Steep slope
  - Indefinite shoreline
  - Marsh
  - Spring
  - Intermittent stream
  - Permanent inlet
  - Permanent outlet

WATER ELEV. 95.00'

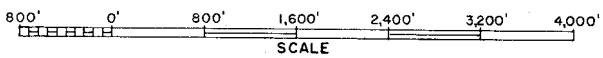

820 WITH ISLANDS  
 AREA 807 ACRES  
 UNDER 3FT. 3 %  
 OVER 20FT. 70 %  
 VOLUME 21,073 ACRE FT.  
 TOTAL ALK. 70 P.P.M.  
 SHORELINE 7.7 MILES