

STATE OF WISCONSIN
DEPARTMENT OF NATURAL RESOURCES

LAKE SURVEY MAP

DEER LAKE SAWYER COUNTY
SEC. 21 28, 29, 31, 32, 33 T. 37 N. R. 8 W.
(Sheet 2 of 2)

SAWYER COUNTY

SHEET 2

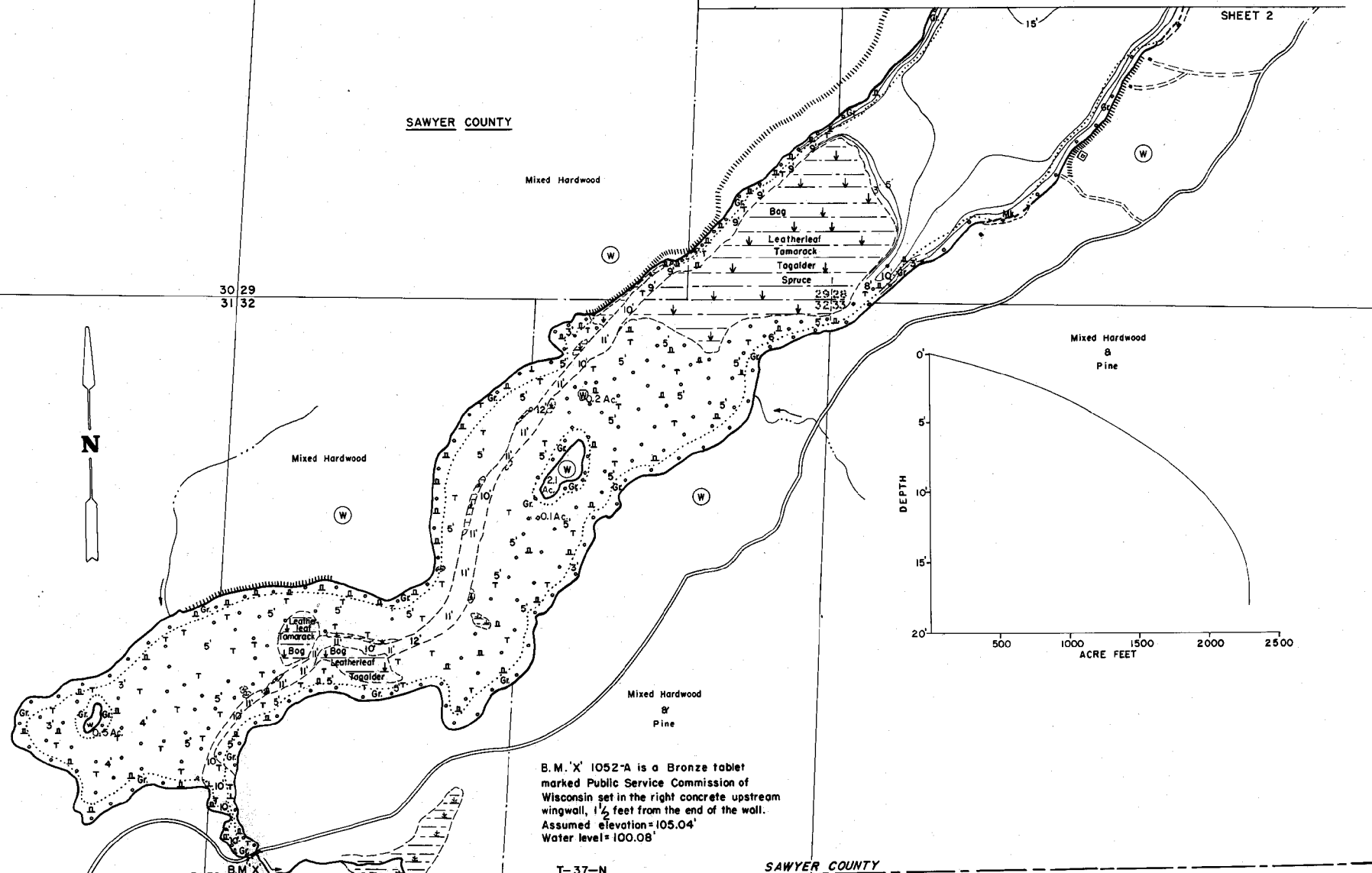

EQUIPMENT RECORDING SONAR MAPPED JULY 1973

TOPOGRAPHIC SYMBOLS		MONTH	YEAR	LAKE BOTTOM SYMBOLS	
(B) Brush	Steep slope	P. Peat	B Boulders	⊙ Stumps & Snags	⊙ Rock danger to navigation
(PW) Partially wooded	- - - Indefinite shoreline	MK. Muck	⊙ Submergent vegetation	⊙ Emergent vegetation	⊙ Floating vegetation
(W) Wooded	⊙ Marsh	C. Clay	⊙ Brush shelters		
(C) Cleared	⊙ Spring	M. Marl			
(P) Pastured	⊙ Intermittent stream	Sd. Sand			
(A) Agricultural	⊙ Permanent inlet	Sl. Silt			
B.M. Bench Mark	⊙ Permanent outlet	Gr. Gravel			
(D) Dwelling	⊙ Dam	R. Rubble			
(R) Resort	⊙ D.N.R. State owned land	Br. Bedrock			
(C) Camp					



◆ Access ◆ Access with Parking ◆ Boat Livery
Drawn by: G.Thuesen
Field work by: C.Busch, K.Cable, J.Sather

SPECIES OF FISH	ABUNDANT		
	Abundant	Common	Present
Muskie			
N. Pike			X
Walleye			
L. M. Bass			
S. M. Bass			
Panfish			X
Trout			

WATER AREA 423.24 ACRES
UNDER 3 FT. 6 %
OVER 20 FT. 0 %
MAX. DEPTH 18 FEET.
TOTAL ALK. 37 P.P.M.
VOLUME 2296.7 ACRE FT.
MAIN SHORELINE 10.02 MI.
ISLAND SHORELINE .45 MI.