

STATE OF WISCONSIN
DEPARTMENT OF NATURAL RESOURCES

LAKE SURVEY MAP

COLUMBIA LAKE
80.56 ACRES
MAX. DEPTH 72 FT.

CHAIN O' LAKES
LAKE

WALUPACA
COUNTY

SEC. 4 T. 21 N. R. 11 E.
DAKE & MINER LAKES

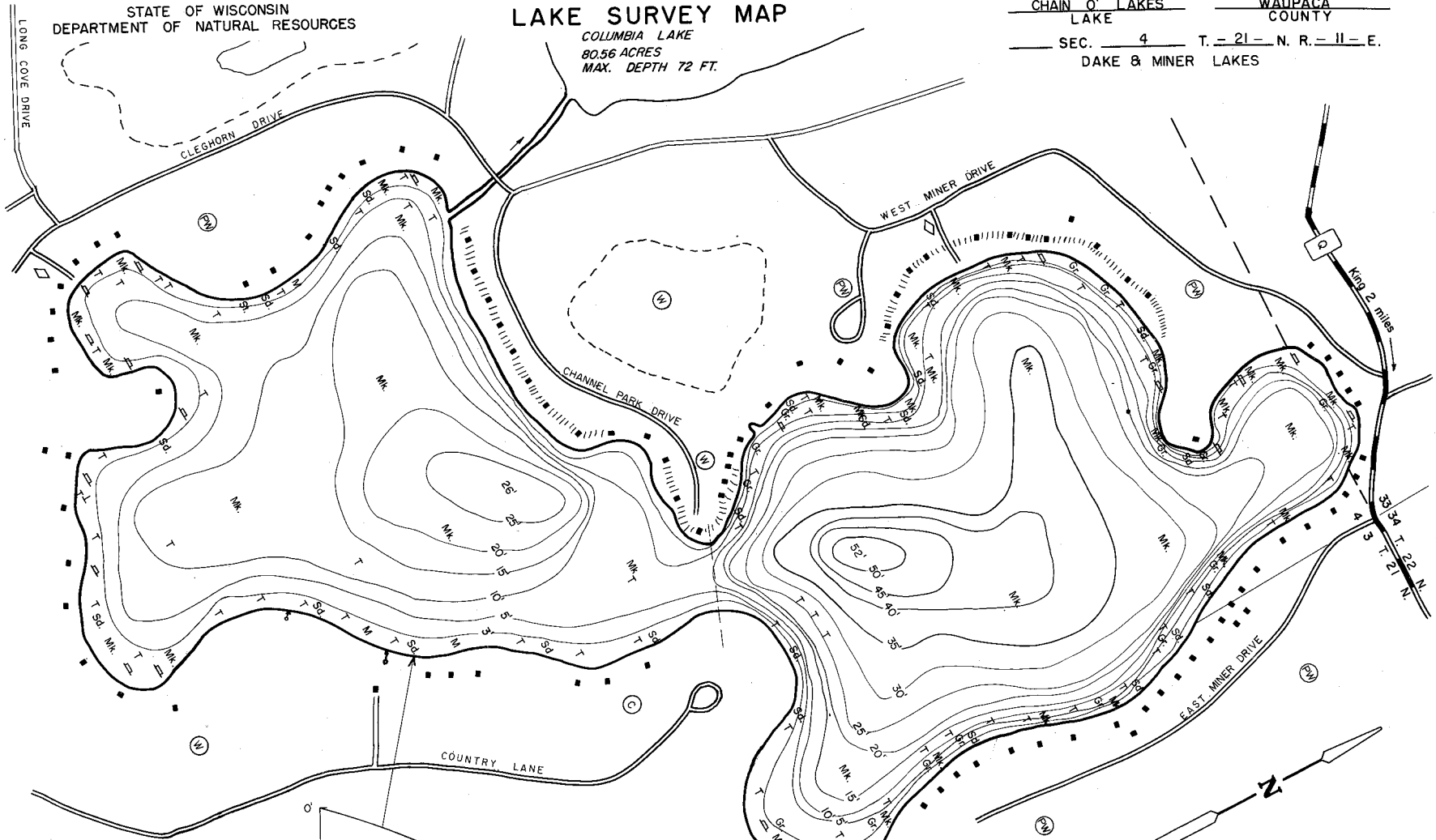

D.N.R. B.M. top of east end of steel spiling on south side of channel between Limekin and Columbia lakes.
Assumed elevation 100.00'
Water elevation 99.00'

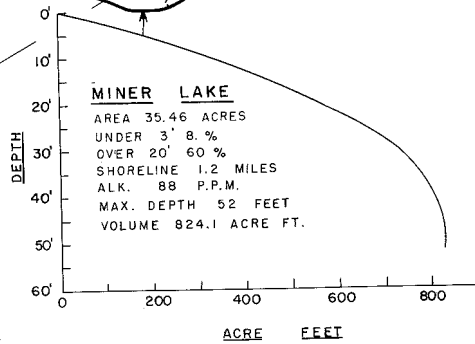
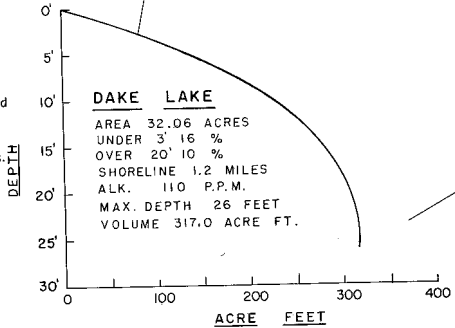

SPECIES OF FISH	
	Abundant, Common or Present
Muskie	
N. Pike	X
Walleye	X
L. M. Bass	X
S. M. Bass	
Panfish	X
Trout	
Sturgeon	X

EQUIPMENT RECORDING SONAR MAPPED JULY 1965
MO. YR.

- TOPOGRAPHIC SYMBOLS
- (B) Brush
 - (PW) Partially wooded
 - (W) Wooded
 - (C) Cleared
 - (P) Pastured
 - (H) Hay
 - ||||| Steep slope
 - - - Indefinite shoreline
 - ||||| Marsh
 - o Spring
 - - - Intermittent stream
 - Recreant inlet

- LAKE BOTTOM SYMBOLS
- P. Peat
 - Mk. Muck
 - C. Clay
 - Gr. Gravel
 - R. Rubble
 - Br. Bedrock
 - Stumps & Snags

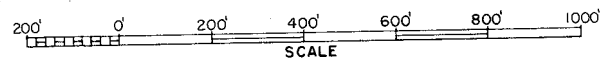

AREA as shown ACRES
UNDER 3 FT. _____ %
OVER 20 FT. _____ %
VOLUME _____ ACRE FT.
TOTAL ALK. _____ P.P.M.
SHORELINE _____ MILES