

STATE OF WISCONSIN
DEPARTMENT OF NATURAL RESOURCES

LAKE SURVEY MAP

BOAT LAKE IRON COUNTY
SEC. 8, 16, 17 T. 41 N. R. 3 E.

P.S.C. 1185-A
B.M. 'X' Square cut in SW corner of concrete step of fourth cottage W. of boat landing on Birches Resort. 260' W. of the landing, 43' N.E. of triple trunked Maple, 51' N.E. of fire place. Assumed elevation 100.00' Water level 91.30' Taken July 1967

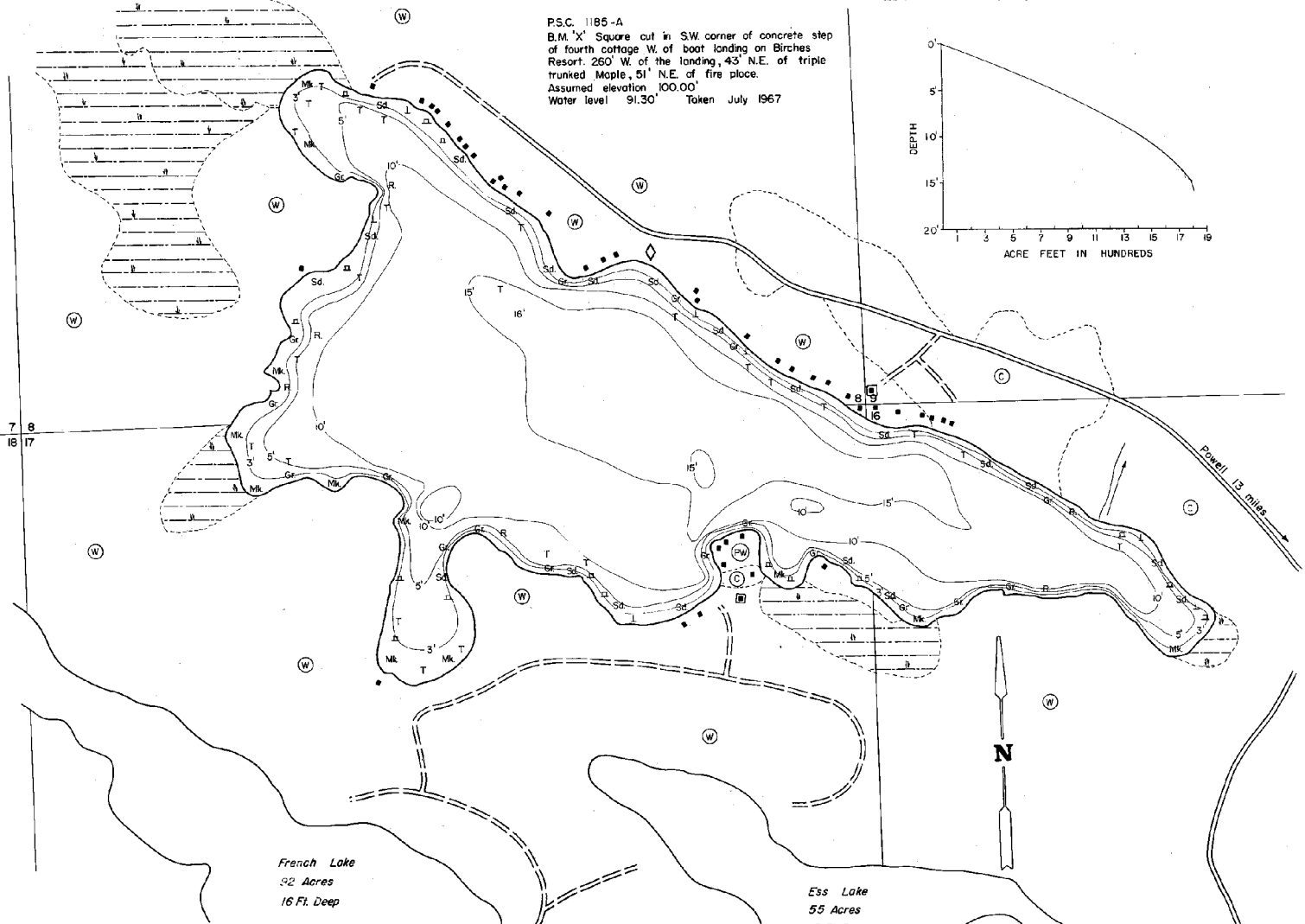
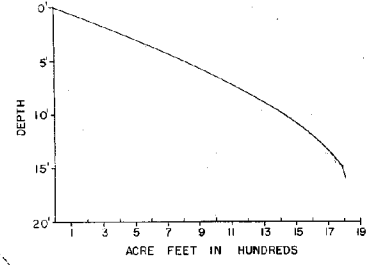

- | | | |
|---|-------------------------------|----------------------------|
| EQUIPMENT RECORDING SONAR MAPPED | MARCH 1968 | LAKE BOTTOM SYMBOLS |
| TOPOGRAPHIC SYMBOLS | | |
| (B) Brush | () Steep slope | P. Peat |
| (W) Partially wooded | (---) Indefinite shoreline | Mk. Muck |
| (W) Wooded | (---) Marsh | C. Clay |
| (C) Cleared | (---) Spring | M. Marl |
| (P) Pastured | (---) Intermittent stream | Sd. Sand |
| (A) Agricultural | (---) Permanent inlet | Sl. Silt |
| B.M. Bench Mark | (---) Permanent outlet | Gr. Gravel |
| (D) Dwelling | (---) Dam | R. Rubble |
| (R) Resort | (---) D.N.R. State owned land | Bc bedrock |
| (C) Camp | | |

400' 0' 400' 800' 1200' 1600'
SCALE
 Access Access with Parking Boat Livery
 Drawn by: C. Holt
 Field work by: J. Smith, P. Nicholson

SPECIES OF FISH	ABUNDANT	
	Common	Present
Muskie	X	X
N. Pike	X	X
Walleye	X	X
L.M. Bass	X	X
S.M. Bass	X	X
Panfish	X	X
Trout	X	X

WATER AREA 179.5 ACRES
 UNDER 3 FT. 12.5 %
 OVER 20 FT. 0 %
 MAX. DEPTH 16 FEET.
 TOTAL ALK. 4.3 P.P.M.
 VOLUME 1808.1 ACRE FT.
 SHORELINE 3.52 MILES

Maps are not for navigation
 Source-Wisconsin Department of Natural Resources
 Hunt Fish Camp Wisconsin .Com 2005